



811 Main St.  
Suite 3400  
Houston, TX 77002

P: (832) 519.2200  
F: (832) 519.2250  
www.Crestwoodlp.com

August 29, 2022

Mr. Patrick Fahn  
Director, Public Utilities Division  
North Dakota Public Service Commission  
600 E Boulevard, Dept. 408  
Bismarck, ND 58505-0480

RE: Oasis Midstream Services, LLC  
Wild Basin Gas Plan  
Case No. PU-17-181

Dear Mr. Fahn,

On December 28, 2021, The North Dakota Public Service Commission, submitted a Notice of Noncompliance alleging noncompliance by Oasis Midstream Services, LLC, n/k/a Rough Rider Operating, LLC. The notice outlined reclamation issues documented by the Commission's third-party inspector and filed on October 15, 2019 ("report") (<https://psc.nd.gov/database/documents/17-0181/074-010.pdf>).

The inspection noted several items of concern:

1. Vehicle ruts and unsuccessful weed control. (Figure 2)
2. Erosion in road ditch. (Figures 3-4)
3. Signification erosion and limited vegetation growth on steep slopes in the south portion of the property. Considerable erosion that has caused a signification channel to form in the area of a truck turn around on the top of a hill. (Figures 6-9)
4. Areas of recent development requiring erosion control measures and reseeding/ reclamation (Figures 10-11).

Items 1, 2, 3, and 4 noted above have been corrected. The photo locations in Figures 1- 9 attached correspond to the photo locations noted in the report filed October 15, 2019. As shown in the attached figures, successful reclamation has been achieved.

Respectfully,

A handwritten signature in black ink, appearing to read 'JS', with a long, sweeping underline that extends to the right.

Josh Swann  
Environmental Construction Manager



(701) 675 8628

[Josh.Swann@Crestwoodlp.com](mailto:Josh.Swann@Crestwoodlp.com)

811 Main St.  
Suite 3400  
Houston, TX 77002

P: (832) 519.2200  
F: (832) 519.2250  
[www.Crestwoodlp.com](http://www.Crestwoodlp.com)

Connections  
for America's  
Energy®

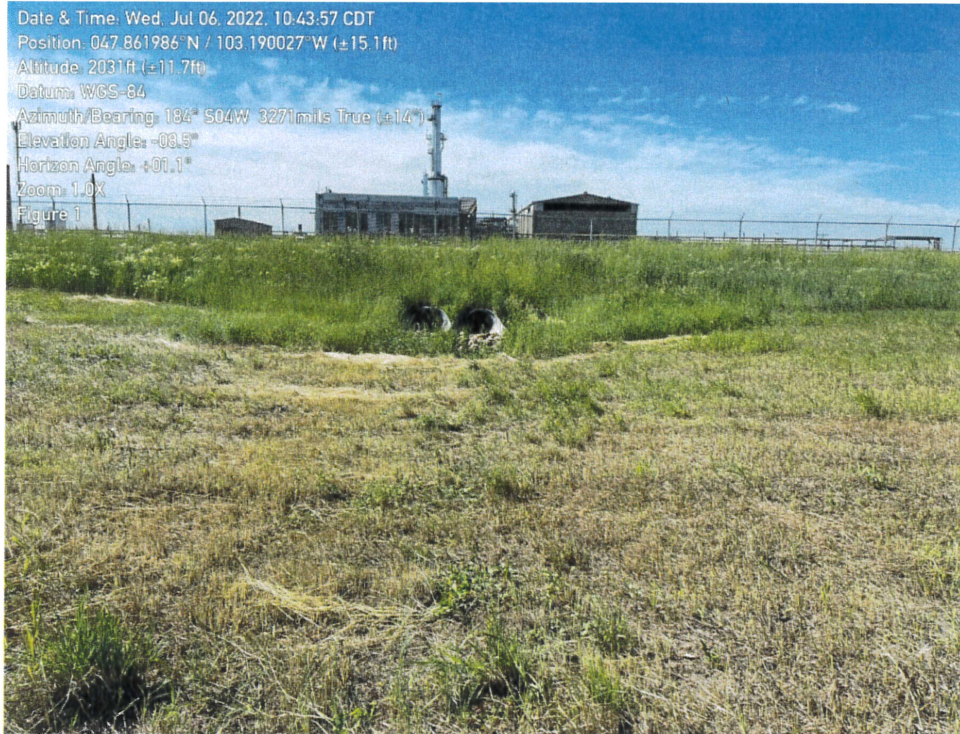

Figure 1: Erosion repaired, soil stabilized, and weed issues corrected.



Figure 2: Weed issues corrected, ruts filled in.



Figure 3: Road ditch stabilized.

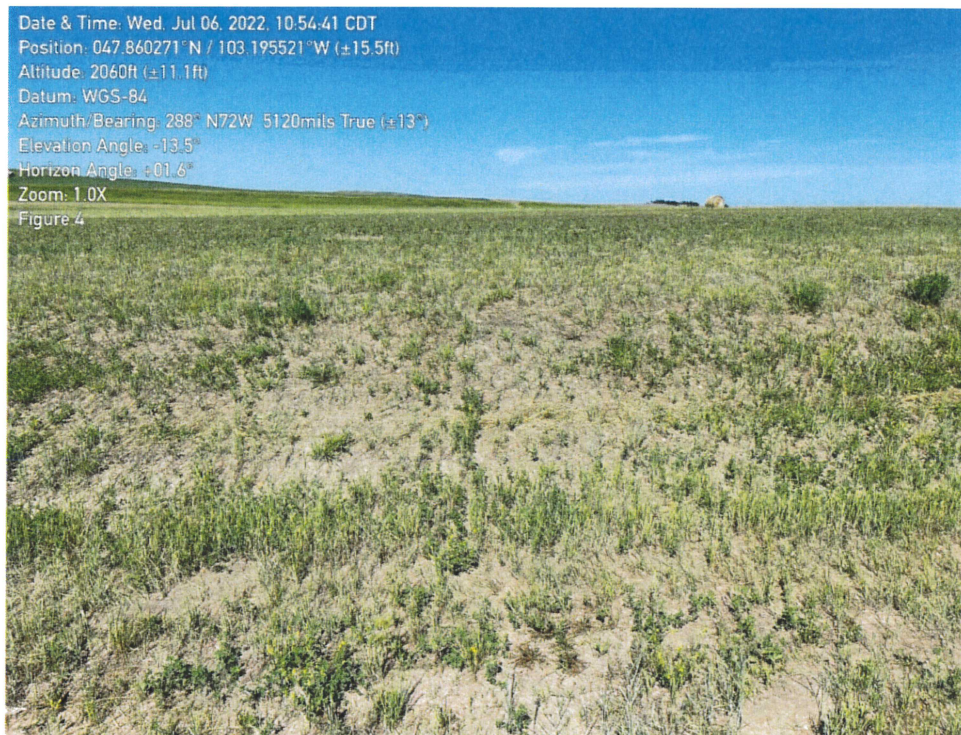

Figure 4: Road ditch stabilized.



Figure 5: Weed issues in the road ditch have been corrected.



Figure 6: Minor rill erosion remains; however, vegetative cover has stabilized the soil.



Figure 7: Erosion minimal and soil is stabilized.

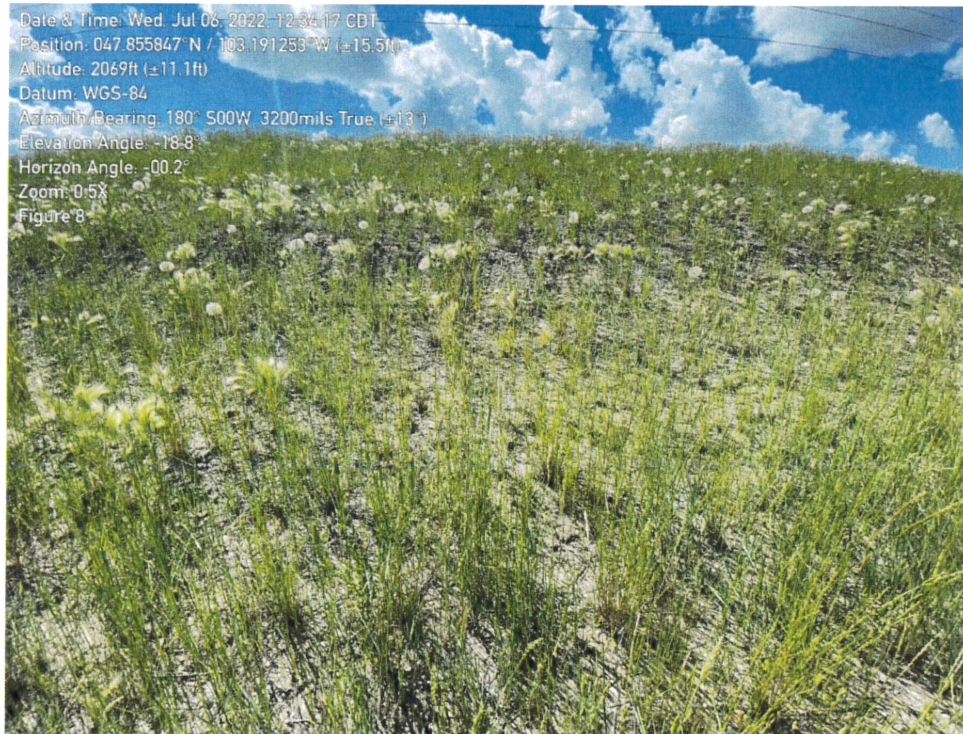

Figure 8: Southern side slopes are stabilized.

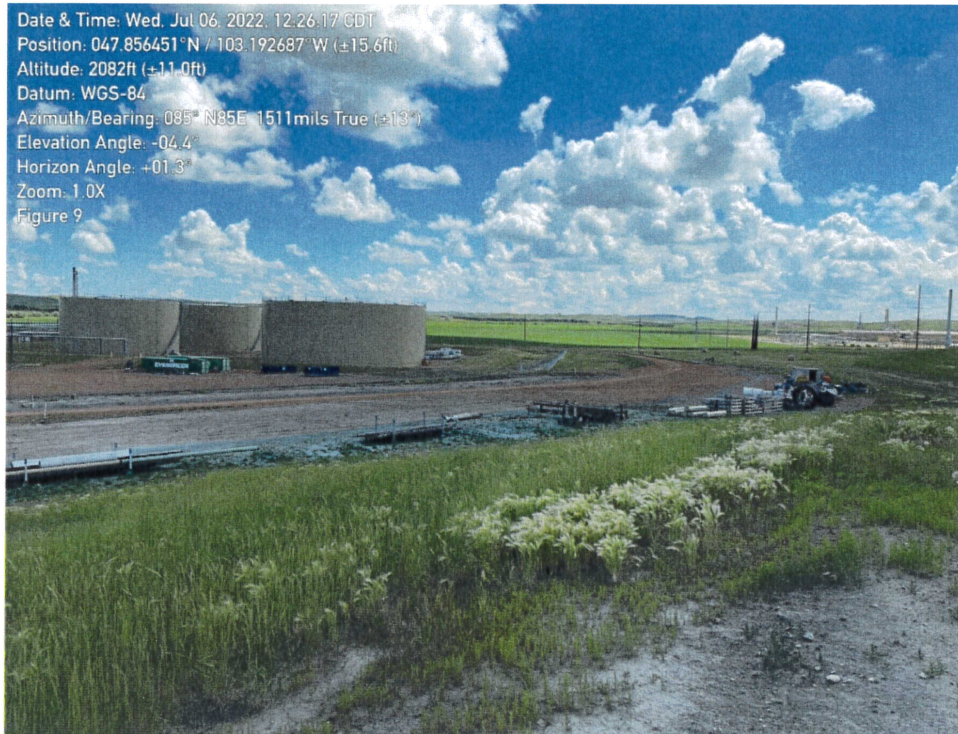

Figure 9: Truck turn around has been reclaimed.



Figure 10: Southern portion of the property has been reclaimed.



Figure 11: Additional development reclaimed.