



A Touchstone Energy® Cooperative 

June 28, 2018

Secretary to the Commission
North Dakota Public Service Commission
State Capitol Building
Bismarck, North Dakota 58505



Dear Sir:

In accordance with Section 49-22-04 of the North Dakota Century Code, Minnkota Power Cooperative herewith files the enclosed Ten-Year Plan with the North Dakota Public Service Commission.

Any questions concerning the contents of the enclosed document should be directed to me.

Sincerely,

MINNKOTA POWER COOPERATIVE, INC.

A handwritten signature in blue ink, appearing to read "Jamie Overgaard".

Jamie Overgaard
Rates, Load and Planning Manager

Enclosure

TEN-YEAR PLAN



Grand Forks, North Dakota

Prepared for the North Dakota Public Service Commission
Pursuant to Section 49-22-04 of the
North Dakota Century Code

MPC
RATES, LOAD AND PLANNING DEPARTMENT

July 2018

TABLE OF CONTENTS

	Page Number
INTRODUCTION	3
SECTION A: Existing Energy Conversion Facilities	4
SECTION B: Energy Conservation Facilities Under Construction	4
SECTION C: Proposed Energy Conversion Facilities on Which Construction Is Intended Within the Ensuing Five Years	4
SECTION D: Proposed Energy Conversion Facilities During the Next Ten-Year Time Period	4
SECTION E: Existing Transmission Facilities (Electric)	4
SECTION F: Existing Transmission Facilities (Pipeline)	5
SECTION G: Proposed Transmission Facilities on Which Construction Is Intended Within the Ensuing Five Years (Electric)	5
SECTION H: Proposed Transmission Facilities on Which Construction Is Intended Within the Ensuing Five Years (Pipeline)	5
SECTION I: Proposed Transmission Facilities During the Next Ten-Year Time Period (Electric and Pipeline)	5
SECTION J: Regional Coordination	5
SECTION K: Environmental Information	7
SECTION L: Projected Demand for Service	8
EXHIBIT I: U.S. Department of Energy Form EIA-923	
EXHIBIT II: Federal Energy Regulatory Commission Form FERC-714	
EXHIBIT III: Minnkota Electric System Maps	

MINNKOTA POWER COOPERATIVE, INC.

TEN-YEAR PLAN

INTRODUCTION

Minnkota Power Cooperative, Inc. (Minnkota) was organized on March 28, 1940 and incorporated under the laws of the State of Minnesota. It is the wholesale electric power supplier for 11 rural electric cooperatives located in the eastern one-third of North Dakota and the northwestern part of Minnesota. Minnkota serves approximately 136,000 end-use customers in a 34,500 square mile service area that includes 33 counties in the Red River Valley and adjoining areas.

Minnkota owns and operates the Milton R. Young 1 plant, a 250,000 kW lignite-fired steam generator located near Center, North Dakota, Minnkota owns or leases another 34,000 kW of smaller diesel units located throughout its service area. Minnkota schedules a firm allocation of 109,000 kW with the Western Area Power Administration on behalf of Minnkota and NMPA. Minnkota, as operating agent for the Northern Municipal Power Agency (NMPA), which consists of 12 municipals, 10 located in northwestern Minnesota and two located in eastern North Dakota, also operates NMPA's 128,100 kW from NMPA's share of Coyote plant output.

Minnkota purchases 355,000 kW from Square Butte Electric Cooperative's Milton R. Young 2 plant. On December 31, 2009 Square Butte Electric Cooperative sold its 463 mile \pm 250 kilovolt D.C. transmission line to Minnesota Power. As part of the sale of the D.C. line, Minnkota began receiving an increasing allocation of Young 2 electrical output through a separate Purchase Power Agreement with Minnesota Power, beginning in mid-2014 when a new 345 kV transmission line from Center to Grand Forks was completed. Minnkota's allocation, currently at 50% from Square Butte Electric Cooperative and 28.02% from Minnesota Power, will increase in varying increments until 2026, at which point Minnkota will receive 100 percent of the electrical energy produced by Young 2.

Minnkota's wind portfolio consists of owned turbines, two 900 kW wind turbines, one located near Valley City and one located near Petersburg, North Dakota, as well as a mix of 20 and 25-year Purchase Power Agreements for a total of 468,130 kW. The Purchase Power Agreements are comprised of 139,500 kW from wind located near Langdon, ND, 229,380 kW from wind projects located near Pillsbury, ND, and a more recent Purchase Power Agreement from Oliver Wind III, placed into service January 1, 2017, as a 25-year Power Purchase Agreement for 99,250 kW from a wind project located west of Center, ND.

SECTION A: Existing Energy Conversion Facilities

1. See Exhibit I

OTP will be responsible for Form EIA-923 for the Coyote facilities.

SECTION B: Energy Conversion Facilities Under Construction

None

SECTION C: Proposed Energy Conversion Facilities on Which Construction is Intended Within The Ensuing Five Years

None

SECTION D: Proposed Energy Conversion Facilities During the Next Ten-Year Time Period
None

SECTION E: Existing Transmission Facilities (Electric)

Minnkota's North Dakota Electric transmission facilities¹ are listed in the table below. See Exhibit III for a map of Minnkota's transmission facilities.

Minnkota does not have plans to retire any transmission facilities in the ensuing ten years.

Transmission Line	Voltage (kV)	AC/DC	In Service Dates	Notes
Wahpeton - Frontier - Maple River	230	AC	1968	Tapped by Frontier Substation in 2007
Maple River - Winger	230	AC	1970	6.3 mi. in ND, rest in MN
Prairie - Winger	230	AC	1970	9.2 mi. in ND, rest in MN
Prairie - Drayton	230	AC	1970	
Center 230 - Square Butte	230	AC	1971	
Center 230 - Mandan	230	AC	1971	
Center - Fried (Jamestown)	345	AC	1981	Center-Maple River line originally completed in 1970 at 230 kV. Uprated to 345 kV in 1981.
Fried (Jamestown) - Buffalo	345	AC	1981	
Buffalo - Bison - Maple River	345	AC	1981	Tapped by Bison Substation in 2014
Pillsbury - Maple River	230	AC	2008	
Center - Prairie (CGF)	345	AC	2014	

¹ See definition of Electric transmission facility in North Dakota Century Code 49-22.

SECTION F: Existing Transmission Facilities (Pipeline)

None

SECTION G: Proposed Transmission Facilities on Which Construction is Intended Within the Ensuing Five Years

Minnkota does not have any other defined plans for construction of 230 kV transmission in North Dakota. However, a number of plans are in development for improvement of Minnkota's 69 and 115 kV transmission which will benefit the cost and/or reliability of service to North Dakota customers. The most significant of those plans involves construction of a new 115 kV transmission line between the Hensel and Drayton substations in far northeastern North Dakota in 2020. Minnkota is also in the process of converting a 69 kV transmission line through Fargo to double circuit 115 kV transmission to support the Fargo area. A number of other ideas are being evaluated to meet various needs such as aging infrastructure, blink mitigation, long term outage risk, and transmission tariff costs. Some of those alternatives include tapping the 230+ kV system to provide new sources to lower voltage transmission.

SECTION H: Proposed Transmission Facilities on Which Construction is Intended Within the Ensuing Five Years (Pipeline)

None

SECTION I: Proposed Transmission Facilities during the Next Ten-Year Time Period (Electric and Pipeline)

Minnkota does not have additional plans for proposed Transmission Facilities beyond the next five years.

SECTION J: Regional coordination

Minnkota participates heavily in a variety of regional transmission planning and operating coordination groups and organizations. Descriptions of some of Minnkota's primary coordination venues are listed below.

- Midcontinent Independent System Operator (MISO): In 2015, Minnkota signed multiple agreements with MISO under which MISO now provides various planning coordination, tariff administration, and operating services to Minnkota. These agreements deepened an already healthy and mutually beneficial relationship between the parties. The services provided under these agreements replace services previously provided to Minnkota through the Midcontinent Area Power Pool, which was dissolved by its members in 2015, as well as other contractors. Minnkota also receives reliability coordination services from MISO and is a MISO market participant.

- Specific to its role as a Planning Coordinator, MISO provides an open forum for Minnkota to submit planned transmission projects through the MISO Transmission Expansion Planning (MTEP) process. The projects receive independent evaluation by MISO and are presented in Sub-regional Planning Meetings (SPM) and on MISO's website, both of which are open and available to the public. The meetings are well attended by many of Minnkota's neighboring transmission owners, as well. More information on the SPM meetings and the MTEP process can be found at www.misoenergy.org.
- Midwest Reliability Organization (MRO): Minnkota is a member of the MRO, which is a non-profit organization of regional utilities established to develop regional reliability standards and ensure compliance with standards of the North American Electric Reliability Corporation (NERC) as well as its own. Further information about MRO is available on-line at www.midwestreliability.org.
- Minnesota Transmission Assessment and Compliance Team (MNTACT): Minnkota is a member of the MNTACT team, which is comprised of electric utilities in and around the state of Minnesota. The team conducts an annual assessment of the near-term and long-term adequacy and security of the bulk electric transmission system within the geographic areas of the members and neighboring regions.
- Manitoba Hydro US Coordinating Committee (MHCC): Minnkota is a member of the MHCC, which is comprised of the owners of the Manitoba Hydro – US transmission interface. The MHCC is responsible for various tasks related to the interface including transmission studies, operating procedures, review of modifications, transfer capability determination, and protection system coordination. Minnkota also participates in various working groups which report to the MHCC.
- Minnkota Ad Hoc Coordination: Minnkota actively manages queues for customers requesting the interconnection of new large generators and for transmission service reservations over Minnkota's transmission system. All studies are distributed to and reviewed by ad hoc groups which are formed for the purpose of reviewing those studies. Those ad hoc groups include neighboring utilities and Regional Transmission Organizations (RTOs) such as MISO and Southwest Power Pool (SPP). Minnkota also participates in ad hoc review of studies performed by its neighboring transmission service providers.
- Minnesota Transmission Owners (MTO): Minnkota is a sponsoring utility for the MTO group, which is a collaborative effort between a number of Minnesota-based utilities and three Minnesota government agencies. The group fulfills the utilities' statutory obligations for transmission planning in the state of Minnesota. These obligations include the development of the Minnesota Biennial Transmission Plan, as well as studies associated with Minnesota mandates regarding generation portfolio requirements. Further information about the MTO group is available at www.minnelectrans.com.
- Minnkota also participates actively in many committees and working groups

which are hosted by MISO, SPP, MRO, the North American Transmission Forum (NATF), and others.

SECTION K: Environmental information

Minnkota is a borrower from the Rural Utilities Services of Washington, D.C. In accordance with national policy, the policies, plans, and programs of the Rural Utilities Services and its borrowers are conducted so as to meet national environmental goals in accordance with Federal and State requirements.

The Rural Utilities Services includes in its loan contracts, a provision to the effect that the borrower shall observe all applicable Federal and State requirements for the protection of the environment. Environmental Statements are required by the Rural Utilities Services in connection with all loans and other agency actions that will significantly affect the environment.

For all of Minnkota's transmission lines of 230 kV and above, knowledgeable consultants prepare an environmental analysis. This analysis is the basis for routing transmission lines in accordance with Federal and State guidelines.

These guidelines are also used in routing lower voltage transmission lines, although lower voltage lines are usually quite short and therefore, have a lesser impact on the environment. It is Minnkota's policy to route transmission lines in such a location as to cause the least amount of damage and interference to the private landowner while at the same time selecting a route that is in the best interest of the general public.

Minnkota cooperates with other area electric utilities so that its high voltage transmission lines are portions of joint projects. This significantly reduces the total number of miles of transmission line otherwise required to be constructed. In the actual route selection, attempts are made to follow the established criteria and to place the lines in such a manner as to be the least visible to the general public. This includes such things as, where feasible, avoiding heavily traveled roads, screening road crossings, and placing the line behind hills or trees. Special wildlife areas and other formally classified areas are avoided in line routing.

Minnkota cooperates with State and Federal agencies in the route selection process. These agencies review and comment on the Environment Impact Statement. Private land use and potential use is considered to either avoid irrigable areas or place the structures in such a way that they will cause the least interference to irrigation. Transmission line structures are placed in non-tillable areas where possible and span lengths are maximized to reduce the total number of structures to cause the least interference to irrigation and other farming activities.

Environmental considerations are placed in their proper perspective along with such other vital factors such as service reliability, cost, and safety. Minnkota considers all these factors in constructing, operating, and maintaining its electric transmission system.

SECTION L: Projected demand for service

1. Minnkota's 2008 peak demand was 906,000 kW as compared to the 2018 peak demand of * 896,196 kW. Minnkota has projected a 2028 peak demand of 1,089,000 kW.
2. Minnkota's generating capacity presently installed or committed plus firm contract commitments are as follows:

	<u>kW</u>
Western Area Power Administration (including reserves)	109,000
Milton R. Young 1	250,000
Milton R. Young 2 (Minnkota share)	355,000
Coyote (NMPA share)	128,100
Miscellaneous Generators	34,000
Petersburg Wind	900
Valley City Wind	900
Langdon Wind PPA	99,000
Langdon Wind II PPA	40,500
Ashtabula PPA- I	99,000
Ashtabula PPA - II	49,500
Ashtabula II PPA	69,000
**Oliver III PPA	<u>99,250</u>
	1,334,150

Minnkota has adequate generating capacity to serve its forecasted peak demands over the next 10-year time frame.

3. Minnkota's load centers are the three distribution cooperatives in eastern North Dakota and the eight distribution cooperatives in northwestern Minnesota.

Minnkota coal resources will last for at least 70 years with the present level of generation. There are no transportation problems since all the base loaded plants are mine mouth plants.

* Minnkota 2018 Miso load peak (year to date)

EXHIBIT I

U.S. Department of Energy Form EIA-923
(Supersedes U.S. Department of Energy Form EIA-767)
(Supersedes FERC Form 67)

NOTICE: This report is mandatory under the Federal Energy Administration Act of 1974 (Public Law 93-275). Failure to comply may result in criminal fines, civil penalties and other sanctions as provided by law. For further information concerning sanctions and data protections see the provision on sanctions and the provision concerning confidentiality of information in the instructions. **Title 18 USC 1001 makes it a criminal offense for any person knowingly and willingly to make to any Agency or Department of the United States any false, fictitious, or fraudulent statements as to any matter within its jurisdiction.**

SCHEDULE 1. IDENTIFICATION

Is this a regulated utility plant Yes No

Is this a combined heat and power plant Yes No

Enter the total plant efficiency of the combined heat and power plant %

Survey Contact

Contact Kay Schraeder Submit Date 12-MAR-18
 Title Accountant
 Address 5301 32nd Avenue South
 City/State/Zip Grand Forks ND 58201
 Email kschraeder@minnkota.com Phone (701) 795-4266 Fax (701) 795-4215

Supervisor of Contact Person for Survey

Contact Craig Rustad
 Title Accounting Manager
 Address 5301 32nd Avenue South
 City/State/Zip Grand Forks ND 58201
 Email crustad@minnkota.com Phone (701) 795-4261 Fax (701) 795-4215

Report For

Company Name Minnkota Power Coop, Inc
 Plant Name Milton R Young
 Plant ID 2823 Plant County Oliver
 Plant Address 3401 24th Street S.W.
 Plant City Center Plant State ND

For contact detail go to <http://www.eia.doe.gov/oss/forms.html#eia-923>

SCHEDULE 6. NONUTILITY ANNUAL SOURCE AND DISPOSITION OF ELECTRICITY

(Instructions for SCHEDULE 6 are on page 13)

SCHEDULE 6 collects calendar year data (no monthly detail).

Report all generation in **megawatthours (MWh)** rounded to a whole number.

- (1) Gross Generation (Annual)
- (2) Other Incoming Electricity
- (3) Total Sources (1 + 2)
- (4) Station Use
- (5) Direct Use
- (6) Total Facility Use (4 + 5)
- (7) Retail Sales to Ultimate Customers
- (8) Sales for Resale (MWh)
- (9) Provided Tolling Agreement (MWh)
- (10) Other Outgoing Electricity
- (11) Total Disposition (6 + 7 + 8 + 9 + 10)

Total Sources must equal Total Disposition (3 = 11)

Plants that cannot separate Station Use and Direct Use may enter zero in Station Use and the sum of Station Use and Direct Use in the Direct Use field.

Types of Other Incoming Electricity
List all of the types of incoming electricity included in (2)
Other Incoming Electricity

Types of Other Outgoing Electricity
List all of the types of outgoing electricity in item (10)
Other Outgoing Electricity

SCHEDULE 7. PART A. ANNUAL REVENUES FROM SALES FOR RESALE

Complete Schedule 7, Part A, only if a positive value was entered on Schedule 6, Item (8): "Sales for Resale."

Sales for Resale are energy supplied to electric utilities, cooperatives, municipalities, federal and state electric agencies, power marketers, or other entities, for resale to end-use consumers.

Report in thousand dollars. For example \$1,987,234 should be entered as 1,987

Annual Revenues from Sales for Resale (in thousand dollars)

SCHEDULE 7. PART B. ANNUAL RETAIL SALES, REVENUES AND NUMBER OF CUSTOMERS FROM RETAIL SALES

Report by state and end-use customer sectors (Residential, Commercial, industrial and Transportation).
 Complete an individual Schedule 7, Part B, for each state where customers are located, only if a positive value was entered on Schedule 6, Item (7), "Retail Sales to Ultimate Customers."

Annual Retail Sales, Revenue, and Number of Customers:

- Retail sales are sold directly to an end-use customer (i.e., the energy is consumed by the customer, onsite, and is not resold to other customers).
- Enter annual retail sales, revenue, and number of customers for each state where customer(s) are located.
- Report Annual Retail Sales in megawatthours (Mwh), by sector.
- Report Annual Revenue in thousand dollars, by sector.
- Report Number of Customers, by sector.

State	Items	Residential	Commercial	Industrial	Transportation	Total
	Retail Sales (Mwh)					
	Revenue (\$ 000's)					
	Number of Customers					

SCHEDULE 8. PART B. FINANCIAL INFORMATION RELATED TO COMBUSTION BY-PRODUCTS

Complete an individual Schedule 8, Part B, annually, for each organically fueled thermoelectric power plant with a total steam turbine capacity greater than, or equal to, 100 megawatts.

- Data reported in Schedule 8, Part B must correspond to the combustion by-product data reported on Schedule 8, Part A.
- If actual data are not available, provide an estimate value.
- Report all values in thousand dollars, to the nearest thousand.

Type	(1) Fly Ash	(2) Bottom Ash	(3) Flue Gas Desulfurization	(4) Water Pollution Abatement	(5) Other Pollution Abatement	(6) Total (1 + 2 + 3 + 4 + 5)
Collection	1,322	1,362	15,365	332	0	18,381
Disposal	987	1,173	937	25	0	3,122
Other	0	0	0	0	2,256	2,256

Capital Expenditures for New Structures and Equipment During Year, Excluding Land and Interest Expense (Thousand Dollars)

Type	(7) Air Pollution Abatement	(8) Water Pollution Abatement	(9) Solid/Contained Waste	(10) Other Pollution Abatement
Amount	0	0	1,877	0

Type	(11) Fly Ash	(12) Bottom Ash	(13) Fly and Bottom Ash Sold Intermingled	(14) Flue Gas Desulfurization	(15) Other Byproduct Revenue	(16) Total (11+12+13+14+15)
Amount	0	243	0	0	0	243

SCHEDULE 8. PART C. AIR EMISSIONS CONTROL INFORMATION

Annual Operations

Environmental Equipment and/or Technology Type			NOx Emission Rate (lbs/MMBtu)			Particulate Matter Control				Sulfur Dioxide Control			Mercury Control	Acid Gas Control					
Types	PM Control ID	SO2 CONTROL ID	NOX Control ID	Mercury Control	Status	Hours in Service	Entire Year	May through September	Emission Rate (0.01 lb/MMBtu)	Removal Efficiency Rate at AOF	Tested Particulate Removal (at 100% Load)	Test Date MM-YYYY	Removal Efficiency Rate at AOF	Removal Tested Efficiency (at 100% Load)	Test Date MM-YYY	Quantity of FGD Sorbent Used (nearest 0.1 thousand tons)	FGD Unit Electrical Energy Consumption	Removal Efficiency (nearest 0.1% by weight)	Removal Efficiency (nearest 0.1% by weight)
SP					OP	8248							96.6	96.6	12-2017	23.1	9029		
SP					OP	8426							95.1	95.1	12-2017	43.4	33428		

FGD Operation and Maintenance Expenditures During Year, Excluding Electricity (Thousand Dollars)

Flue Gas Desulfurization Unit ID	Feed Materials and Chemicals	Land and Supervision	Waste Disposal	Maintenance, Material and All Other Costs	Total
FGD1	\$4,481	\$741	\$728	\$142	\$6,092
FGD2	\$8,564	\$947	\$609	\$490	\$10,610

SCHEDULE 8. PART D. COOLING SYSTEM INFORMATION, MONTHLY OPERATIONS

Complete an individual Schedule 8, Part D for each thermoelectric power plant (organically fueled, nuclear and combined cycle) with a total steam capacity greater than, or equal to, 100 megawatts.

- Complete a separate schedule for each reporting month.
- Complete a separate row for each cooling system.
- If actual data are not available, provided an estimated value.
- If the source of cooling water is a well or municipal water system, do not complete the Cooling Water Temperature sections.

Cooling System ID	Cooling System Type	Cooling System Status	Annual Amt of Chlorine in added to Service Cooling Water Per month(1000 lbs)	Average Monthly Rate of Cooling Water (to nearest 0.1 gallons per minute)			Cooling Water Temperature (degrees Fahrenheit)			Volume Cooling Water (to nearest 0.001 million gallons per month)								
				Hours	Withdrawal	Discharge	Consumption	Method of Measure	Avg at Intake	Max at Intake	Avg at Discharge	Max at Discharge	Method of Measure	Div	Withdrawal	Discharge	Consumption	
Report Month 1																		
CS1	OC	OP	690	.436	0	54718	54718	0	4	46	52	76	86	1	0	1132.7	1132.7	0
Report Month 2																		
CS1	OC	OP	672	.511	0	60031	60031	0	4	49	61	81	97	1	0	1363.3	1363.3	0
Report Month 3																		
CS1	OC	OP	744	1.502	0	80966	80966	0	4	52	65	79	95	1	0	2480	2480	0
Report Month 4																		
CS1	OC	OP	720	.88	0	118000	118000	0	4	66	72	84	91	1	0	5097.6	5097.6	0
Report Month 5																		
CS1	OC	OP	744	1.06	0	118000	118000	0	4	73	78	91	97	1	0	5267.5	5267.5	0
Report Month 6																		
CS1	OC	OP	564	.59	0	87925	87925	0	4	78	85	93	103	1	0	2830.4	2830.4	0

SCHEDULE 8. PART D. COOLING SYSTEM INFORMATION, MONTHLY OPERATIONS

Complete an individual Schedule 8, Part D for each thermoelectric power plant (organically fueled, nuclear and combined cycle) with a total steam capacity greater than, or equal to, 100 megawatts.

- Complete a separate schedule for each reporting month.
- Complete a separate row for each cooling system.
- If actual data are not available, provided an estimated value.
- If the source of cooling water is a well or municipal water system, do not complete the Cooling Water Temperature sections.

Cooling System ID	Cooling System Type	Cooling System Status	Annual Amt of Chlorine in added to Service Cooling Water Per monthe(1000 lbs)	Average Monthly Rate of Cooling Water (to nearest 0.1 gallons per minute)			Cooling Water Temperature (degrees Fahrenheit)			Volume Cooling Water (to nearest 0.001 million gallons per month)								
				Hours	Withdrawal	Discharge	Consumption	Method of Measure	Avg at Intake	Max at Intake	Avg at Discharge	Max at Discharge	Div	Withdrawal	Discharge	Consumption		
Report Month 7																		
CSI	OC	OP	744	1.959	0	116810	116810	0	4	86	91	104	111	1	0	5161.9	5161.9	0
Report Month 8																		
CSI	OC	OP	744	2.17	0	118000	118000	0	4	85	88	104	108	1	0	5267.5	5267.5	0
Report Month 9																		
CSI	OC	OP	720	1.569	0	118000	118000	0	4	78	89	97	109	1	0	5097.6	5097.6	0
Report Month 10																		
CSI	OC	OP	744	1.067	0	118000	118000	0	4	67	76	84	95	1	0	5267.5	5267.5	0
Report Month 11																		
CSI	OC	OP	720	.386	0	118000	118000	0	4	54	63	87	100	1	0	5097.6	5097.6	0
Report Month 12																		
CSI	OC	OP	726	1.262	0	57573	57573	0	4	50	60	81	97	1	0	1253.9	1253.9	0

SCHEDULE 8. PART D. COOLING SYSTEM INFORMATION, MONTHLY OPERATIONS

Complete an individual Schedule 8, Part D for each thermoelectric power plant (organically fueled, nuclear and combined cycle) with a total steam capacity greater than, or equal to, 100 megawatts.

- Complete a separate schedule for each reporting month.

- Complete a separate row for each cooling system.

- If actual data are not available, provided an estimated value.

- If the source of cooling water is a well or municipal water system, do not complete the Cooling Water Temperature sections.

Cooling System ID	Cooling System Type	Cooling System Status	Hours in Service Per month	Annual Amt of Chlorine added to Cooling Water (1000 lbs)	Average Monthly Rate of Cooling Water (to nearest 0.1 gallons per minute)		Cooling Water Temperature (degrees Fahrenheit)				Volume Cooling Water (to nearest 0.001 million gallons per month)							
					Withdrawal	Discharge	Consumption	Measure	Method of Measure	Avg at Intake	Max at Intake	Avg at Discharge	Max at Discharge	Method of Measure	Div	Withdrawal	Discharge	Consumption
Report Month 1																		
CS2	OC	OP	744	.71	0	125000	125000	0	4	45	79	78	86	1	0	2790	2790	0
Report Month 2																		
CS2	OC	OP	672	.765	0	112903	112903	0	4	48	61	84	102	1	0	2276	2276	0
Report Month 3																		
CS2	OC	OP	744	2.44	0	187836	187836	0	4	51	66	76	94	1	0	6300	6300	0
Report Month 4																		
CS2	OC	OP	637	1.01	0	213206	213206	0	4	65	72	82	90	1	0	8116.7	8116.7	0
Report Month 5																		
CS2	OC	OP	744	1.4	0	250000	250000	0	4	72	78	90	98	1	0	11160	11160	0
Report Month 6																		
CS2	OC	OP	720	1.94	0	241935	241935	0	4	78	84	97	104	1	0	10451.6	10451.6	0

SCHEDULE 8. PART D. COOLING SYSTEM INFORMATION, MONTHLY OPERATIONS

Complete an individual Schedule 8, Part D for each thermoelectric power plant (organically fueled, nuclear and combined cycle) with a total steam capacity greater than, or equal to, 100 megawatts.

- Complete a separate schedule for each reporting month.
- Complete a separate row for each cooling system.
- If actual data are not available, provided an estimated value.
- If the source of cooling water is a well or municipal water system, do not complete the Cooling Water Temperature sections.

Cooling System ID	Cooling System Type	Cooling System Status	Annual Amt of Chlorine in added to Service Cooling Water Per monthe(1000 lbs)	Average Monthly Rate of Cooling Water (to nearest 0.1 gallons per minute)			Cooling Water Temperature (degrees Fahrenheit)			Volume Cooling Water (to nearest 0.001 million gallons per month)								
				Hours	Withdrawal	Discharge	Consumption	Avg at Intake	Max at Intake	Avg at Discharg	Max at Discharg	Div	Withdrawal	Discharge	Consumption			
Report Month 7																		
CS2	OC	OP	699	2.876	0	230175	230175	0	4	86	92	104	113	1	0	9460	9460	0
Report Month 8																		
CS2	OC	OP	744	3.48	0	250000	250000	0	4	85	90	105	109	1	0	11160	11160	0
Report Month 9																		
CS2	OC	OP	720	3.547	0	241935	241935	0	4	78	89	96	109	1	0	10451.6	10451.6	0
Report Month 10																		
CS2	OC	OP	744	2.666	0	250000	250000	0	4	66	75	83	92	1	0	11160	11160	0
Report Month 11																		
CS2	OC	OP	693	2.084	0	224630	224630	0	4	52	62	67	79	1	0	9009.9	9009.9	0
Report Month 12																		
CS2	OC	OP	744	5.03	0	250000	250000	0	4	48	59	82	99	1	0	11160	11160	0

SCHEDULE 9. COMMENTS
 (Instructions for SCHEDULE 9. are on page 20.)

Schedule	Part	Item	Comments
8	C	OT	B1 OT FLUX AGENT
8	C	OT	B2 OT FLUX AGENT
8	C	OT	B1 OXIDIZED HALIDE
8	C	OT	B2 OT OXIDIZED HALIDE

Generator Id	Retirement Month	Retirement Year	Generator Retirement Dates Comments
			Changes in Ownership (Provide name of purchaser and date sold.)

ERRORS

Purchase Type	Fuel	Schedule	Mover	Prime Equipment ID	Rpt Month	Supplier	Error Number & Description	Ranges	Override Comment
C	LIG	2A				BNI COAL	218 Commodity Cost was reported as Zero. Commodity Cost is the difference between the Total Cost and Transportation Costs. If these costs cannot be reported separately, please leave commodity cost blank and enter a detailed explanation in the override comment for analyst review.		Commodity cost cannot be separate out so field is left blank
S	DFO	2A				TESORO	218 Commodity Cost was reported as Zero. Commodity Cost is the difference between the Total Cost and Transportation Costs. If these costs cannot be reported separately, please leave commodity cost blank and enter a detailed explanation in the override comment for analyst review.		Commodity cost cannot be separate out so field is left blank

EXHIBIT II

Federal Energy Regulatory Commission Form FERC-714
(Supersedes FERC Form 12)



Federal Energy Regulatory Commission
FERC Form No. 714

Annual Electric Balancing Authority Area and Planning Area Report

For the Year Ending December 31, 2017

Form Approved
OMB Numbers: 1902-0140
(Expires 05/31/2019)

Part I - Schedule 1. Identification and Certification

1. Respondent Identification:

Code: 12658 Name: Minnkota Power Cooperative, Inc.

2. Respondent Type: (Please check appropriate box and fill in name)

Part I: Balancing Authority Area (Complete Parts I, II, and IV)

Unit dispatch is not based on the economic dispatch of thermal units (i.e., a system lambda is not calculated)

Balancing Authority Area Name:

Part II: Planning Area (Complete Parts I, III, and IV)

Planning Area Name:

Minnkota Power Cooperative, Inc.

3. Respondent Mailing Address:

Minnkota Power Cooperative, Inc.
5301 32nd Avenue South
Grand Forks, ND 58201

4 Contact Person:

Name: Dan Trebil

Title: Energy Marketer

E-mail address: dtrebil@minnkota.com

Telephone #: 701-795-4424 Ext:

5. Certifying Official:

Name: Brock Vaagene

Title: Energy Marketer Supervisor

Date: 05/07/2018

This report is an Original Revised Filing

**Annual Electric Balancing Authority Area and Planning
 Area Report**

For the Year Ending December 31, 2017

Utility Code: 12658
 Utility Name: Minnkota Power Cooperative, Inc.

Part III - Schedule 1. Electric Utilities That Compose the Planning Area

Enter the name of each entity, including the respondent, that forms the planning area for which this report is being prepared and their coincident summer and winter peak demands in megawatts. Refer to the Form 714 instructions for specific guidelines.

Line No (a)	Electric Utility Name (b)	Electric Utility Coincident Peak Demand (MW)	
		Summer (c)	Winter (d)
1	Beltrami Electric Coop.	75	115
2	Cass County Electric Coop.	219	233
3	Cavaller Rural Electric Coop.	8	7
4	Clearwater Polk Electric Coop.	13	20
5	Northern Municipal Power Agency	75	81
6	Nodak Electric Coop.	173	205
7	North Star Electric Coop.	16	30
8	PKM Electric Coop.	22	31
9	Red Lake Electric Coop.	21	30
10	Red River Electric Coop.	25	37
11	Roseau Electric Coop.	25	37
12	Wild Rice Electric Coop.	49	75
13			
14			
15			
16			
17			
18			
19			
20			
21			
22			
23			
24			
25			
26			
27			
28			
29			
30			

**Annual Electric Balancing Authority Area and Planning
 Area Report**

Utility Code: 12658
 Utility Name: Minnkota Power Cooperative, Inc.

For the Year Ending December 31, 2017

Part III - Schedule 2. Planning Area Hourly Demand

Respondents must provide the following data: the planning area's actual hourly demand, in megawatts, for each hour of the year starting with 1 a.m. January 1 as more fully described in the Form 714 instructions. In column (b) indicate the time zone and the days for which daylight savings time was observed. This schedule will have 365 rows for the report year (366 rows for a leap year). For hours when this information is not available, enter "0.00" and provide, as a footnote describing the reason for the unavailability of the data.

Date (a)	Time Zone (b)	0100 (c)	0200 (d)	0300 (e)	0400 (f)	0500 (g)	0600 (h)	0700 (i)	0800 (j)	0900 (k)	1000 (l)	1100 (m)	1200 (n)	1300 (o)	1400 (p)	1500 (q)	1600 (r)	1700 (s)	1800 (t)	1900 (u)	2000 (v)	2100 (w)	2200 (x)	2300 (y)	2400 (z)
01/01/2017	CST	581	567	558	549	548	553	560	567	586	593	606	602	587	570	562	555	574	614	669	676	670	660	645	621
01/02/2017	CST	602	594	588	587	588	596	610	632	624	636	648	654	650	699	679	670	676	701	707	695	686	666	636	595
01/03/2017	CST	637	625	616	617	582	597	630	689	688	713	737	738	739	808	793	786	794	819	818	816	808	793	770	742
01/04/2017	CST	804	785	775	777	772	779	808	870	848	829	819	802	784	847	823	809	806	668	618	600	592	681	898	869
01/05/2017	CST	816	808	799	793	795	801	829	886	864	837	821	804	780	840	819	803	806	644	624	608	601	554	601	831
01/06/2017	CST	855	825	808	799	785	762	733	692	676	664	644	699	797	838	798	745	741	722	741	750	765	799	771	740
01/07/2017	CST	803	776	757	745	742	745	755	748	627	613	617	618	706	845	791	760	753	748	668	647	638	714	798	762
01/08/2017	CST	828	807	800	796	792	787	784	793	759	766	770	761	753	821	795	773	763	777	768	766	757	743	727	694
01/09/2017	CST	750	730	721	716	716	725	729	721	710	685	721	794	782	847	823	802	793	799	776	770	756	734	703	660
01/10/2017	CST	700	668	651	646	642	648	679	747	747	729	717	703	719	788	761	745	749	771	777	790	784	768	745	710
01/11/2017	CST	719	688	672	673	689	704	734	800	790	770	749	723	703	766	760	751	762	808	817	826	812	803	778	740
01/12/2017	CST	803	784	773	768	767	769	789	846	825	803	790	778	766	837	824	815	810	669	618	607	595	683	901	872
01/13/2017	CST	809	788	788	799	801	806	800	728	696	771	871	843	817	879	880	832	817	816	760	758	784	762	738	703
01/14/2017	CST	759	736	719	705	698	699	708	719	699	707	696	675	653	700	685	641	641	663	679	693	696	690	679	655
01/15/2017	CST	709	688	675	669	664	663	658	646	626	650	656	635	621	658	627	605	600	621	647	663	664	651	628	599
01/16/2017	CST	646	624	610	606	610	622	649	697	692	685	670	641	617	651	636	629	633	650	671	689	689	683	666	630
01/17/2017	CST	680	660	646	644	642	652	676	720	664	590	610	652	614	655	623	589	585	615	640	660	657	643	622	596
01/18/2017	CST	632	607	592	585	581	583	610	674	665	626	599	578	556	584	561	549	554	572	598	623	598	581	561	524
01/19/2017	CST	549	553	547	542	542	531	554	623	655	627	597	568	559	572	552	548	550	574	593	601	581	564	546	521
01/20/2017	CST	543	519	505	489	479	487	516	577	605	590	586	581	574	609	598	583	585	596	596	597	584	568	551	526
01/21/2017	CST	554	526	508	500	495	494	498	517	523	547	559	563	561	590	568	555	555	585	568	565	556	546	529	507
01/22/2017	CST	537	509	493	487	482	480	489	508	516	531	542	544	548	591	572	568	568	571	586	596	591	572	542	509
01/23/2017	CST	540	515	479	457	462	472	530	597	612	593	578	565	569	617	609	599	567	569	576	596	591	577	555	536
01/24/2017	CST	566	537	522	500	500	510	542	616	631	608	599	582	571	614	603	596	590	604	609	625	616	603	539	496
01/25/2017	CST	531	506	502	501	498	510	541	609	617	598	587	585	585	641	626	617	624	633	626	631	622	611	585	548
01/26/2017	CST	585	560	550	548	551	569	608	680	687	655	648	642	631	680	656	622	625	642	640	656	652	645	625	597
01/27/2017	CST	645	630	626	619	615	621	649	708	702	674	652	632	611	645	624	606	601	613	621	639	632	621	607	585
01/28/2017	CST	633	607	590	581	578	575	583	594	596	609	617	614	607	648	623	605	606	619	618	627	622	610	585	555

Annual Electric Balancing Authority Area and Planning
 Area Report

For the Year Ending December 31, 2017

Part III - Schedule 2. Planning Area Hourly Demand (continued)

Date (a)	Time Zone (b)	0100 (c)	0200 (d)	0300 (e)	0400 (f)	0500 (g)	0600 (h)	0700 (i)	0800 (j)	0900 (k)	1000 (l)	1100 (m)	1200 (n)	1300 (o)	1400 (p)	1500 (q)	1600 (r)	1700 (s)	1800 (t)	1900 (u)	2000 (v)	2100 (w)	2200 (x)	2300 (y)	2400 (z)
01/29/2017	CST	593	574	574	560	558	547	547	547	546	504	504	506	500	545	523	523	505	506	500	584	583	600	602	565
01/30/2017	CST	608	583	565	562	556	587	587	649	658	626	615	608	598	633	626	621	622	629	632	644	631	608	585	547
01/31/2017	CST	569	542	529	523	520	529	564	630	639	614	607	601	591	627	610	600	612	636	643	667	669	670	656	629
02/01/2017	CST	685	673	663	664	665	679	713	785	773	740	710	690	676	740	722	710	715	732	727	753	760	752	726	684
02/02/2017	CST	742	724	713	703	702	711	739	809	795	761	736	717	696	754	729	713	701	664	664	718	740	746	726	694
02/03/2017	CST	749	727	713	708	703	709	733	795	783	749	720	692	664	709	684	660	653	662	656	688	684	676	662	634
02/04/2017	CST	689	663	643	631	621	620	616	652	644	653	660	650	630	641	619	605	616	651	625	634	635	630	623	603
02/05/2017	CST	662	648	638	634	634	639	650	636	594	600	592	576	565	627	608	596	601	619	606	641	650	647	632	613
02/06/2017	CST	658	634	624	619	616	622	650	716	717	698	692	681	662	715	707	696	698	713	708	731	726	710	685	647
02/07/2017	CST	694	670	656	649	646	654	679	731	739	719	708	692	674	726	707	694	699	715	714	759	760	748	724	673
02/08/2017	CST	733	713	705	697	697	709	742	805	786	753	727	723	706	766	747	726	733	757	748	786	786	777	755	719
02/09/2017	CST	776	753	737	729	727	726	758	823	797	758	743	717	686	746	717	695	696	726	717	741	732	721	697	656
02/10/2017	CST	696	664	644	627	613	614	640	693	690	659	635	603	581	602	578	560	557	553	553	578	577	568	562	540
02/11/2017	CST	552	529	522	528	530	540	557	580	576	581	590	580	571	608	585	576	573	574	563	588	583	573	559	541
02/12/2017	CST	586	574	565	564	565	565	577	593	582	588	573	569	547	579	550	533	526	536	550	595	596	578	552	524
02/13/2017	CST	560	546	537	535	539	552	585	653	651	625	597	577	564	597	582	570	562	567	575	612	612	601	575	539
02/14/2017	CST	566	549	538	533	531	541	570	638	608	574	551	535	523	554	539	531	531	549	566	599	615	619	595	563
02/15/2017	CST	615	598	589	581	581	596	632	700	675	636	605	585	565	597	569	555	546	550	550	587	593	578	554	518
02/16/2017	CST	522	491	485	474	474	485	554	607	608	586	574	553	540	568	543	520	517	525	529	559	563	555	535	504
02/17/2017	CST	519	495	481	474	474	485	513	572	570	541	521	508	494	511	494	477	478	487	488	516	523	513	499	477
02/18/2017	CST	493	473	466	464	468	472	489	517	514	517	512	501	493	510	486	473	474	483	488	488	513	508	493	473
02/19/2017	CST	499	481	469	433	417	458	485	503	503	517	521	518	512	536	487	461	456	463	466	498	501	488	467	438
02/20/2017	CST	453	439	439	435	431	440	465	510	531	532	540	547	551	586	576	569	568	572	562	582	577	562	543	521
02/21/2017	CST	544	521	511	505	502	509	542	610	609	579	561	544	531	552	533	513	514	524	524	554	558	546	523	494
02/22/2017	CST	508	485	476	469	469	479	513	580	593	576	571	571	568	609	597	589	586	593	583	606	601	590	568	537
02/23/2017	CST	567	546	534	533	542	556	582	644	642	595	583	572	564	606	589	578	587	597	588	617	628	617	614	588
02/24/2017	CST	627	605	592	589	591	598	629	692	685	665	644	622	603	643	623	604	596	608	603	629	639	632	618	597
02/25/2017	CST	648	629	618	614	614	610	620	637	620	628	610	594	578	614	589	574	571	574	555	577	578	588	556	535
02/26/2017	CST	576	558	545	541	545	551	566	590	574	577	564	543	533	578	551	534	529	544	556	600	617	612	593	564
02/27/2017	CST	611	591	578	576	576	587	616	686	670	641	620	607	596	626	596	577	579	590	588	622	626	617	593	560
02/28/2017	CST	591	568	559	556	553	576	611	668	641	635	599	572	553	582	561	558	565	589	583	621	636	625	607	577
03/01/2017	CST	615	594	588	584	588	598	630	701	688	667	646	623	601	643	627	616	620	632	620	655	665	660	640	609
03/02/2017	CST	657	639	628	626	629	640	676	706	620	598	582	625	607	655	618	596	596	608	617	669	694	691	674	642
03/03/2017	CST	693	672	665	662	665	671	696	753	727	702	674	645	618	627	572	559	583	608	598	624	629	618	597	574

**Annual Electric Balancing Authority Area and Planning
 Area Report**

Utility Code: 12658
 Utility Name: Minnkota Power Cooperative, Inc.

For the Year Ending December 31, 2017

Part III - Schedule 2. Planning Area Hourly Demand (continued)

Date (a)	Time Zone (b)	0100 (c)	0200 (d)	0300 (e)	0400 (f)	0500 (g)	0600 (h)	0700 (i)	0800 (j)	0900 (k)	1000 (l)	1100 (m)	1200 (n)	1300 (o)	1400 (p)	1500 (q)	1600 (r)	1700 (s)	1800 (t)	1900 (u)	2000 (v)	2100 (w)	2200 (x)	2300 (y)	2400 (z)
03/04/2017	CST	606	585	573	569	567	570	582	604	589	593	585	565	548	566	542	517	515	526	523	546	555	549	534	509
03/05/2017	CST	531	510	494	485	482	482	496	516	505	507	496	485	469	492	470	453	446	454	473	511	522	511	484	455
03/06/2017	CST	465	446	436	429	431	443	479	545	558	544	543	542	538	560	545	527	520	527	526	553	559	556	544	513
03/07/2017	CST	547	540	548	545	549	565	601	678	659	639	627	622	620	681	667	658	660	676	653	678	682	670	641	609
03/08/2017	CST	661	648	635	628	628	638	667	727	699	675	654	640	626	674	650	625	615	624	611	643	656	646	621	584
03/09/2017	CST	626	607	601	598	601	615	651	718	703	678	664	647	631	681	664	644	641	657	663	705	731	732	719	689
03/10/2017	CST	747	728	722	721	719	724	748	807	775	746	725	707	688	741	712	686	675	682	660	679	691	684	670	655
03/11/2017	CST	715	698	688	683	673	674	683	705	677	685	674	658	632	673	645	620	612	618	603	630	651	646	634	615
03/12/2017	CST	673	657	650	628	647	651	665	641	653	662	661	654	715	683	662	648	644	626	637	661	671	650	614	632
03/13/2017	CST	582	575	602	633	647	680	746	744	720	689	658	631	671	645	621	605	604	586	594	629	652	641	615	654
03/14/2017	CST	637	631	631	631	641	675	744	738	703	667	637	614	654	631	606	593	588	570	581	606	632	613	584	618
03/15/2017	CST	598	592	592	600	616	646	713	715	689	661	635	609	643	617	594	580	574	568	568	553	574	582	556	577
03/16/2017	CST	554	541	539	538	545	575	637	640	615	605	594	577	604	589	574	568	573	556	558	568	568	550	521	540
03/17/2017	CST	518	502	495	492	494	511	561	576	557	533	540	534	575	595	599	594	590	570	571	582	586	570	550	590
03/18/2017	CST	572	561	554	550	552	557	572	560	574	586	593	581	611	575	543	522	504	484	489	508	534	531	513	540
03/19/2017	CST	519	509	503	502	504	512	525	524	531	527	518	505	528	502	482	472	476	477	491	506	519	502	469	479
03/20/2017	CST	463	455	453	455	463	490	559	582	568	555	541	525	543	527	515	507	511	507	515	530	557	549	519	540
03/21/2017	CST	531	527	533	539	556	590	662	661	607	589	574	555	590	570	552	542	540	524	534	556	588	580	548	575
03/22/2017	CST	553	546	545	550	563	592	657	657	638	626	615	600	638	625	615	619	637	618	616	620	618	592	550	566
03/23/2017	CST	535	521	511	506	511	538	601	603	585	573	566	561	589	575	565	561	570	556	555	559	563	542	503	513
03/24/2017	CST	490	479	474	474	485	511	575	589	573	560	554	545	566	549	535	525	524	511	489	459	483	485	473	492
03/25/2017	CST	470	469	468	468	487	500	543	537	549	562	567	558	579	550	527	515	506	491	494	507	531	519	497	518
03/26/2017	CST	495	479	474	471	473	480	495	497	517	523	519	515	538	513	494	486	485	480	486	502	522	508	478	482
03/27/2017	CST	459	452	453	462	474	506	574	585	558	540	525	513	536	517	503	495	483	469	476	499	526	511	476	476
03/28/2017	CST	463	453	454	463	480	513	584	598	577	564	553	536	555	539	521	497	493	481	484	496	521	505	469	465
03/29/2017	CST	446	441	442	448	462	495	563	577	563	548	533	520	536	518	504	499	496	488	486	493	523	507	472	469
03/30/2017	CST	448	443	445	449	466	497	567	578	555	537	516	516	534	519	503	495	490	463	446	474	517	507	475	470
03/31/2017	CST	447	437	435	442	454	485	562	571	553	538	513	487	463	439	426	417	413	398	399	416	466	462	439	440
04/01/2017	CST	418	407	406	408	412	425	445	458	484	500	501	497	510	486	464	448	442	434	438	443	469	464	439	449
04/02/2017	CST	429	422	421	408	414	424	455	460	477	484	481	473	488	471	455	448	453	450	454	463	479	461	429	423
04/03/2017	CST	402	395	397	401	416	452	527	542	527	512	500	488	502	489	477	473	468	461	470	477	494	479	444	440
04/04/2017	CST	419	411	413	419	431	467	541	554	530	510	496	485	499	485	471	466	469	467	471	478	502	487	451	441
04/05/2017	CST	428	421	425	432	445	479	548	559	544	525	513	501	518	501	489	486	486	480	483	493	520	513	480	481
04/06/2017	CST	462	454	458	466	480	516	582	580	553	535	521	504	513	493	483	483	481	468	468	473	504	502	469	470

For the Year Ending December 31, 2017

Part III - Schedule 2. Planning Area Hourly Demand (continued)

Date	Time Zone	0100	0200	0300	0400	0500	0600	0700	0800	0900	1000	1100	1200	1300	1400	1500	1600	1700	1800	1900	2000	2100	2200	2300	2400
(a)	(b)	(c)	(d)	(e)	(f)	(g)	(h)	(i)	(j)	(k)	(l)	(m)	(n)	(o)	(p)	(q)	(r)	(s)	(t)	(u)	(v)	(w)	(x)	(y)	(z)
04/07/2017	CST	461	467	468	452	434	471	522	541	516	502	481	480	481	464	448	434	431	421	419	416	435	433	412	414
04/08/2017	CST	404	410	409	408	411	422	440	459	482	477	475	465	445	431	435	430	431	432	433	435	452	447	421	405
04/09/2017	CST	392	382	374	371	377	390	410	435	459	471	469	470	471	465	460	462	469	485	493	511	537	528	506	487
04/10/2017	CST	478	475	479	485	499	533	604	614	602	588	575	560	577	555	532	519	517	507	513	520	540	531	495	499
04/11/2017	CST	475	468	471	476	487	503	546	549	520	494	477	463	476	457	439	436	435	426	430	438	470	477	447	450
04/12/2017	CST	432	421	419	427	437	470	535	520	475	461	450	439	446	435	431	432	431	430	433	446	481	477	443	409
04/13/2017	CST	379	378	398	405	416	451	519	540	519	485	471	456	468	454	445	441	439	443	446	443	463	472	441	424
04/14/2017	CST	400	389	386	381	384	401	445	478	490	495	497	487	470	458	449	443	441	439	434	433	443	431	405	378
04/15/2017	CST	353	342	338	334	333	344	359	382	411	427	429	427	416	408	397	394	394	395	395	396	413	411	393	373
04/16/2017	CST	357	350	351	354	356	370	394	422	436	439	437	430	414	390	383	381	381	394	410	423	446	452	430	406
04/17/2017	CST	394	394	396	404	415	448	509	526	529	533	532	523	487	499	479	498	498	481	488	496	514	504	463	451
04/18/2017	CST	424	417	418	419	429	460	529	552	534	524	521	516	531	515	503	500	500	483	482	480	493	496	466	464
04/19/2017	CST	443	434	434	435	448	480	538	549	532	516	508	498	504	491	480	470	477	474	489	497	511	496	459	450
04/20/2017	CST	425	416	413	385	370	445	519	538	516	505	489	486	500	485	474	469	468	459	460	463	481	483	453	439
04/21/2017	CST	416	409	411	414	426	463	522	533	509	494	484	474	481	466	455	450	443	430	425	419	436	444	421	408
04/22/2017	CST	373	372	347	324	331	342	361	378	393	401	397	391	401	384	373	371	373	372	374	376	393	396	385	401
04/23/2017	CST	401	376	360	377	421	441	457	470	498	512	517	519	551	536	524	519	515	505	510	505	518	526	494	484
04/24/2017	CST	454	454	451	458	468	499	563	578	564	559	554	551	569	556	543	545	548	543	545	546	549	536	497	495
04/25/2017	CST	471	462	458	458	467	500	567	581	588	584	576	572	562	553	551	560	565	558	559	560	571	556	502	509
04/26/2017	CST	486	481	492	490	497	527	591	619	600	606	606	600	595	591	581	581	589	574	576	577	585	578	541	552
04/27/2017	CST	543	529	523	519	522	544	604	618	573	577	567	563	542	542	535	535	535	530	534	538	548	547	510	510
04/28/2017	CST	490	483	478	478	489	526	581	594	564	548	533	520	509	499	490	480	473	460	454	449	459	477	458	463
04/29/2017	CST	447	446	446	450	462	481	493	507	508	497	485	474	466	442	433	425	426	427	424	422	429	444	427	410
04/30/2017	CST	398	393	393	387	395	408	420	439	455	458	451	443	438	431	423	418	422	434	445	463	463	465	446	427
05/01/2017	CST	411	407	408	414	418	463	529	567	583	543	518	512	502	485	462	482	485	488	495	497	503	502	464	433
05/02/2017	CST	415	407	407	408	420	455	515	541	505	486	477	472	466	460	451	447	447	444	443	449	468	477	441	406
05/03/2017	CST	385	378	375	376	386	417	475	507	484	478	475	471	462	460	451	452	456	461	465	461	466	479	445	411
05/04/2017	CST	391	380	384	388	401	435	494	491	466	469	468	460	457	454	456	453	454	454	457	454	468	477	450	409
05/05/2017	CST	381	369	366	367	375	406	457	495	480	472	472	468	467	468	464	468	459	437	418	421	444	461	438	405
05/06/2017	CST	382	366	357	355	359	373	387	415	436	438	435	435	439	433	425	426	431	436	444	446	446	455	426	401
05/07/2017	CST	379	365	358	358	362	370	377	403	435	449	453	455	456	449	444	442	447	457	462	465	471	471	435	398
05/08/2017	CST	375	363	360	362	371	400	451	482	472	474	480	485	477	456	421	434	465	470	477	475	467	464	429	395
05/09/2017	CST	375	367	361	363	371	399	454	485	473	468	464	464	461	464	459	461	450	449	450	447	450	458	426	385
05/10/2017	CST	360	347	343	344	351	379	433	465	464	450	449	446	442	437	430	433	437	442	445	447	451	466	439	405

**Annual Electric Balancing Authority Area and Planning
 Area Report**

Utility Code: 12658
 Utility Name: Minnkota Power Cooperative, Inc.

For the Year Ending December 31, 2017

Part III - Schedule 2. Planning Area Hourly Demand (continued)

Date	Time Zone	0100	0200	0300	0400	0500	0600	0700	0800	0900	1000	1100	1200	1300	1400	1500	1600	1700	1800	1900	2000	2100	2200	2300	2400
(a)	(b)	(c)	(d)	(e)	(f)	(g)	(h)	(i)	(j)	(k)	(l)	(m)	(n)	(o)	(p)	(q)	(r)	(s)	(t)	(u)	(v)	(w)	(x)	(y)	(z)
05/11/2017	CST	385	376	373	375	389	421	480	505	475	464	458	451	444	441	435	434	439	444	446	443	453	467	443	404
05/12/2017	CST	376	363	352	351	365	392	445	480	467	463	460	445	439	438	437	432	433	434	431	428	432	446	427	396
05/13/2017	CST	370	356	350	352	355	366	379	407	427	434	433	430	426	420	417	421	428	434	438	438	434	441	418	368
05/14/2017	CST	340	324	316	313	313	318	325	355	384	398	401	400	399	395	411	420	427	433	438	440	446	459	407	372
05/15/2017	CST	318	294	294	333	342	367	410	449	431	422	436	462	465	465	462	464	470	478	480	477	473	473	437	390
05/16/2017	CST	356	342	333	332	338	364	419	448	424	428	435	437	442	439	428	427	429	424	415	410	410	415	387	348
05/17/2017	CST	331	333	337	337	345	373	428	463	447	439	432	436	436	436	427	429	433	439	441	441	449	459	430	394
05/18/2017	CST	369	360	358	351	370	405	462	492	477	461	434	431	432	430	420	408	410	409	408	412	416	437	427	397
05/19/2017	CST	377	369	368	372	382	408	465	499	481	470	457	450	439	434	429	439	437	437	434	430	434	447	433	403
05/20/2017	CST	381	365	359	365	365	379	392	423	447	465	473	472	467	458	450	456	461	470	474	472	471	471	449	424
05/21/2017	CST	407	398	395	393	394	401	409	435	462	477	482	482	476	465	455	448	450	460	464	465	461	463	435	404
05/22/2017	CST	388	379	377	379	392	420	466	498	487	482	483	483	481	478	467	469	476	480	482	481	483	479	444	405
05/23/2017	CST	381	373	370	368	375	403	460	490	481	477	476	479	471	463	455	455	452	451	451	450	450	460	443	406
05/24/2017	CST	383	378	377	381	395	423	476	496	476	469	428	419	421	420	412	414	415	418	417	433	453	467	443	394
05/25/2017	CST	367	359	358	356	365	393	449	487	477	474	472	468	462	457	456	456	460	462	457	463	461	463	443	402
05/26/2017	CST	372	359	356	351	356	376	422	458	460	457	448	428	469	458	450	442	441	436	430	423	417	423	416	385
05/27/2017	CST	356	344	341	339	340	342	353	379	405	419	419	417	418	413	405	402	398	376	373	359	370	408	393	367
05/28/2017	CST	343	333	325	322	327	325	330	357	384	400	407	413	412	404	395	392	391	395	396	396	394	403	390	367
05/29/2017	CST	346	336	332	330	334	342	352	376	405	430	439	440	439	431	424	421	427	439	443	442	439	437	412	379
05/30/2017	CST	362	351	348	351	359	366	440	479	476	482	482	483	480	479	470	468	468	467	463	459	461	466	447	411
05/31/2017	CST	385	375	374	376	384	403	444	471	464	462	464	463	461	461	458	457	460	463	457	425	428	433	433	400
06/01/2017	CST	374	358	354	353	361	382	436	472	469	473	484	481	480	483	490	495	499	504	506	503	494	494	471	418
06/02/2017	CST	377	367	360	355	357	373	415	456	472	484	504	519	529	541	543	554	563	564	549	527	512	511	488	428
06/03/2017	CST	396	380	372	337	321	323	338	383	427	455	469	488	504	515	514	515	516	506	506	495	491	472	455	419
06/04/2017	CST	387	367	355	348	345	337	344	373	407	437	453	464	476	487	489	497	507	519	519	515	504	496	470	418
06/05/2017	CST	381	361	352	341	344	361	410	456	475	482	492	510	531	537	541	544	550	557	562	562	548	528	481	434
06/06/2017	CST	407	387	379	371	374	385	431	469	482	496	512	526	539	564	561	575	588	589	575	554	535	527	502	446
06/07/2017	CST	405	382	373	367	370	390	434	472	489	505	518	529	526	528	527	531	546	532	523	519	517	506	483	437
06/08/2017	CST	401	381	368	363	367	382	423	466	484	496	511	523	531	538	544	553	560	562	562	564	537	524	502	450
06/09/2017	CST	409	384	371	365	365	341	383	431	448	463	485	505	534	542	537	545	548	553	543	495	457	444	426	410
06/10/2017	CST	384	364	353	344	346	345	354	392	432	458	471	478	481	482	480	482	489	492	490	479	459	445	444	412
06/11/2017	CST	382	359	347	343	344	343	349	366	390	419	441	460	475	476	483	486	512	528	537	533	519	504	477	422
06/12/2017	CST	383	359	346	346	350	365	412	456	477	488	470	480	492	521	526	530	531	534	541	535	522	511	489	445
06/13/2017	CST	354	332	340	348	366	379	428	462	468	455	453	446	434	444	448	477	481	486	489	482	472	422	380	350

**Annual Electric Balancing Authority Area and Planning
 Area Report**

Utility Code: 12658
 Utility Name: Minnkota Power Cooperative, Inc.

For the Year Ending December 31, 2017

Part III - Schedule 2. Planning Area Hourly Demand (continued)

Date (a)	Time Zone (b)	0100 (c)	0200 (d)	0300 (e)	0400 (f)	0500 (g)	0600 (h)	0700 (i)	0800 (j)	0900 (k)	1000 (l)	1100 (m)	1200 (n)	1300 (o)	1400 (p)	1500 (q)	1600 (r)	1700 (s)	1800 (t)	1900 (u)	2000 (v)	2100 (w)	2200 (x)	2300 (y)	2400 (z)
06/14/2017	CST	340	350	345	339	336	348	393	426	459	475	488	505	509	511	513	521	523	521	523	511	507	503	478	478
06/15/2017	CST	391	370	369	354	358	370	416	453	469	481	486	484	495	503	502	502	493	488	490	487	470	469	462	416
06/16/2017	CST	379	360	349	342	343	368	397	436	452	471	488	498	505	514	511	501	496	483	475	455	420	414	401	383
06/17/2017	CST	364	356	347	336	333	339	352	378	405	429	435	443	447	448	442	438	432	432	427	418	408	413	406	378
06/18/2017	CST	355	343	332	329	325	323	327	352	384	403	412	415	418	414	415	420	426	431	429	430	409	423	414	374
06/19/2017	CST	349	335	328	328	335	352	400	439	450	464	477	484	485	482	480	479	485	487	480	475	469	457	417	357
06/20/2017	CST	328	318	314	313	315	328	373	406	402	410	420	424	427	429	423	433	442	442	444	441	434	426	413	359
06/21/2017	CST	337	345	339	334	339	344	380	412	416	429	435	425	447	467	470	485	495	504	505	501	487	476	455	412
06/22/2017	CST	378	359	348	340	346	360	396	437	448	457	463	474	485	493	495	495	502	508	506	485	482	483	466	419
06/23/2017	CST	382	366	356	351	356	372	410	448	458	468	471	473	467	463	457	450	448	439	434	426	419	419	410	383
06/24/2017	CST	363	351	343	338	338	341	350	377	401	418	425	425	422	416	404	395	400	406	409	407	404	404	395	372
06/25/2017	CST	363	340	333	328	323	316	325	351	375	393	400	408	410	407	399	397	402	416	431	433	426	425	414	378
06/26/2017	CST	353	342	336	334	341	357	400	436	444	455	459	465	473	478	474	479	486	489	492	489	478	474	457	412
06/27/2017	CST	376	360	350	346	352	369	411	445	455	463	473	479	484	473	466	469	474	478	479	471	463	464	446	401
06/28/2017	CST	352	328	325	326	334	353	395	435	442	453	460	467	467	469	466	468	470	471	469	460	452	448	432	391
06/29/2017	CST	359	356	348	345	352	370	409	431	418	423	433	437	431	431	432	432	432	432	432	432	425	425	416	425
06/30/2017	CST	376	350	338	324	323	335	364	397	412	428	445	451	464	467	461	446	432	428	428	410	413	425	416	386
07/01/2017	CST	360	343	332	326	325	321	336	354	381	405	415	410	410	390	380	373	374	379	389	418	405	409	404	375
07/02/2017	CST	349	335	328	324	321	319	322	344	373	395	404	406	408	410	411	417	429	438	439	434	428	421	413	384
07/03/2017	CST	351	336	327	325	327	297	313	343	366	407	441	461	472	477	478	486	498	498	514	504	485	471	459	422
07/04/2017	CST	388	366	355	346	343	336	339	365	399	447	485	485	492	503	517	532	544	557	559	548	538	520	491	466
07/05/2017	CST	409	385	369	361	367	383	402	445	484	545	585	610	627	640	650	645	645	665	673	659	615	597	572	512
07/06/2017	CST	463	428	405	392	390	398	435	488	524	551	579	605	624	631	630	629	625	619	610	592	567	548	523	468
07/07/2017	CST	426	401	389	379	379	390	426	470	498	521	538	548	550	553	548	550	534	523	514	502	477	461	449	412
07/08/2017	CST	377	351	337	328	325	324	330	358	392	407	433	448	465	503	509	519	515	525	527	520	505	494	477	443
07/09/2017	CST	408	386	371	362	360	357	353	368	399	430	457	482	500	515	527	538	554	568	571	536	520	506	486	429
07/10/2017	CST	366	359	343	336	344	360	400	438	465	492	514	523	542	569	590	605	607	593	592	580	576	570	496	429
07/11/2017	CST	421	403	378	367	375	402	430	467	488	499	508	525	542	566	565	575	581	587	587	552	521	504	468	419
07/12/2017	CST	383	362	343	337	372	391	431	471	477	482	483	494	490	490	488	474	466	480	477	471	460	458	450	413
07/13/2017	CST	380	362	352	348	351	371	410	444	455	462	470	473	474	477	483	482	487	491	492	488	483	479	467	424
07/14/2017	CST	385	367	357	350	358	372	405	444	464	481	491	499	500	510	522	528	535	536	530	520	502	491	479	443
07/15/2017	CST	410	391	376	369	365	365	372	405	442	474	489	499	505	504	503	512	519	524	520	487	466	447	436	405
07/16/2017	CST	380	362	343	339	342	338	341	366	399	427	453	477	497	507	518	512	518	518	532	540	523	512	503	453
07/17/2017	CST	412	395	376	337	341	353	401	470	508	533	554	573	586	571	568	578	607	631	624	612	587	570	527	463

**Annual Electric Balancing Authority Area and Planning
 Area Report**

Utility Code: 12658
 Utility Name: Minnkota Power Cooperative, Inc.

For the Year Ending December 31, 2017

Part III - Schedule 2. Planning Area Hourly Demand (continued)

Date	Time Zone	0100 (c)	0200 (d)	0300 (e)	0400 (f)	0500 (g)	0600 (h)	0700 (i)	0800 (j)	0900 (k)	1000 (l)	1100 (m)	1200 (n)	1300 (o)	1400 (p)	1500 (q)	1600 (r)	1700 (s)	1800 (t)	1900 (u)	2000 (v)	2100 (w)	2200 (x)	2300 (y)	2400 (z)
07/18/2017	CST	426	400	383	373	371	382	417	426	428	434	444	454	472	484	492	509	523	536	538	529	514	510	479	424
07/19/2017	CST	383	369	344	339	340	356	397	421	422	434	442	447	450	454	469	484	499	517	537	542	543	536	506	455
07/20/2017	CST	412	387	372	356	339	357	393	432	442	482	504	542	560	569	572	594	609	616	604	578	547	546	519	483
07/21/2017	CST	438	407	396	366	363	369	423	460	499	531	559	582	590	609	619	617	602	580	501	484	488	503	481	438
07/22/2017	CST	400	379	365	358	356	358	366	398	443	482	511	526	529	524	516	521	528	528	516	498	474	463	439	404
07/23/2017	CST	373	362	340	335	332	332	332	353	380	405	420	434	448	464	463	477	497	516	524	518	502	493	464	414
07/24/2017	CST	380	359	347	343	346	367	409	455	476	497	517	534	541	552	558	567	570	569	569	556	537	531	493	442
07/25/2017	CST	406	380	369	363	363	379	419	464	486	500	515	530	538	543	562	562	566	577	581	569	553	543	508	452
07/26/2017	CST	411	386	369	359	361	380	416	461	486	512	531	545	555	565	565	574	584	589	583	566	543	529	494	442
07/27/2017	CST	402	378	365	368	359	376	412	461	469	497	522	546	565	577	583	594	595	593	588	573	551	540	501	444
07/28/2017	CST	403	377	362	354	355	370	402	446	478	508	543	567	584	599	604	611	602	601	590	580	555	530	494	451
07/29/2017	CST	425	403	387	378	373	374	375	407	447	486	519	537	550	557	558	564	572	576	571	587	576	567	530	478
07/30/2017	CST	413	390	374	365	360	369	357	383	425	465	500	524	545	561	572	584	595	608	608	596	576	567	530	473
07/31/2017	CST	431	403	389	390	399	417	455	500	535	568	599	613	626	586	564	573	587	592	628	625	594	576	518	470
08/01/2017	CST	428	401	388	378	373	385	415	453	478	528	546	563	577	586	588	597	601	603	594	573	546	535	495	442
08/02/2017	CST	404	383	364	331	330	351	391	441	456	473	492	507	509	523	525	518	506	485	474	465	464	459	425	390
08/03/2017	CST	366	353	343	337	339	362	400	423	431	447	460	466	457	462	460	463	473	475	475	469	460	465	436	350
08/04/2017	CST	331	335	338	334	334	350	389	426	441	461	477	485	492	499	497	499	509	506	487	475	465	462	418	379
08/05/2017	CST	364	350	344	339	337	342	349	373	401	422	435	447	452	456	464	467	467	458	454	442	442	434	410	377
08/06/2017	CST	350	333	326	321	319	323	324	334	369	395	414	430	439	446	450	459	474	496	504	494	479	479	431	386
08/07/2017	CST	358	340	338	336	341	362	398	436	457	477	498	517	529	540	545	559	571	578	577	564	544	534	487	434
08/08/2017	CST	396	374	362	358	362	382	419	452	462	481	500	519	535	549	560	575	586	585	575	553	518	522	491	437
08/09/2017	CST	399	377	341	328	326	342	384	427	456	463	480	496	514	523	526	531	526	515	506	494	481	473	426	389
08/10/2017	CST	362	356	352	349	353	373	411	439	447	463	479	493	499	506	512	521	530	532	528	508	492	488	451	405
08/11/2017	CST	373	350	339	332	333	354	387	423	442	461	469	490	495	502	506	515	523	528	522	505	482	475	439	400
08/12/2017	CST	371	355	345	335	333	340	342	366	397	423	443	454	466	475	474	475	469	465	457	443	437	442	415	381
08/13/2017	CST	355	343	335	327	324	332	337	351	377	399	416	428	438	442	446	448	455	463	466	460	453	453	418	380
08/14/2017	CST	353	340	333	330	336	356	399	433	448	463	472	484	493	505	515	525	537	545	545	528	511	500	454	407
08/15/2017	CST	378	362	352	345	342	365	387	403	416	430	451	467	473	477	475	475	472	473	476	472	475	472	430	387
08/16/2017	CST	356	336	328	327	332	350	396	422	426	434	443	441	444	439	430	425	431	433	438	431	431	445	416	381
08/17/2017	CST	350	334	326	321	326	348	392	425	434	444	460	478	494	505	508	518	528	530	525	509	499	500	455	408
08/18/2017	CST	360	330	341	338	339	359	398	432	446	460	471	486	497	503	506	516	527	524	510	491	475	474	440	403
08/19/2017	CST	369	351	339	329	329	333	339	361	381	399	420	440	456	478	489	490	492	496	485	464	453	448	416	381
08/20/2017	CST	356	337	325	317	313	314	316	334	359	366	405	422	443	447	451	457	469	483	489	478	471	463	422	379

**Annual Electric Balancing Authority Area and Planning
 Area Report**

Utility Code: 12658
 Utility Name: Minnkota Power Cooperative, Inc.

For the Year Ending December 31, 2017

Part III - Schedule 2. Planning Area Hourly Demand (continued)

Date (a)	Time Zone (b)	0100 (c)	0200 (d)	0300 (e)	0400 (f)	0500 (g)	0600 (h)	0700 (i)	0800 (j)	0900 (k)	1000 (l)	1100 (m)	1200 (n)	1300 (o)	1400 (p)	1500 (q)	1600 (r)	1700 (s)	1800 (t)	1900 (u)	2000 (v)	2100 (w)	2200 (x)	2300 (y)	2400 (z)
08/21/2017	CST	347	330	323	320	318	311	300	297	294	292	290	288	286	284	282	280	278	276	274	272	270	268	266	264
08/22/2017	CST	364	354	345	340	340	340	338	335	332	329	326	323	320	317	314	311	308	305	302	299	296	293	290	287
08/23/2017	CST	381	364	359	358	362	362	362	362	362	362	362	362	362	362	362	362	362	362	362	362	362	362	362	362
08/24/2017	CST	374	358	351	348	353	353	353	353	353	353	353	353	353	353	353	353	353	353	353	353	353	353	353	353
08/25/2017	CST	376	360	351	341	347	347	347	347	347	347	347	347	347	347	347	347	347	347	347	347	347	347	347	347
08/26/2017	CST	379	363	350	344	345	345	345	345	345	345	345	345	345	345	345	345	345	345	345	345	345	345	345	345
08/27/2017	CST	324	311	304	300	299	301	310	324	353	376	393	407	417	421	423	430	442	458	463	457	458	444	403	359
08/28/2017	CST	334	320	313	311	316	340	388	419	431	446	463	478	491	508	518	536	547	556	556	543	533	514	469	409
08/29/2017	CST	376	356	344	337	338	359	409	444	450	467	488	510	530	547	555	572	583	590	589	571	562	539	483	432
08/30/2017	CST	395	376	360	351	348	367	416	443	447	457	475	490	503	512	520	535	539	538	533	516	509	487	435	391
08/31/2017	CST	362	343	333	328	332	353	404	435	437	445	455	461	467	474	478	484	486	486	482	472	477	463	421	380
09/01/2017	CST	352	335	327	321	324	342	392	425	436	451	465	468	464	456	446	441	440	440	436	429	435	425	401	372
09/02/2017	CST	350	336	326	319	317	320	330	343	372	396	410	421	426	431	437	449	465	476	472	452	448	427	397	371
09/03/2017	CST	346	331	325	323	322	326	335	347	376	400	418	443	468	481	498	510	521	522	508	486	478	457	419	385
09/04/2017	CST	359	342	332	328	328	333	348	360	388	423	444	457	455	449	449	443	443	462	463	457	463	437	392	353
09/05/2017	CST	333	325	319	317	326	357	427	449	447	451	461	468	472	472	471	475	477	479	482	482	491	467	425	395
09/06/2017	CST	370	356	360	364	372	400	459	485	479	480	488	462	465	476	473	475	481	485	489	491	504	482	440	394
09/07/2017	CST	368	354	347	347	356	383	443	472	459	463	473	476	478	486	494	504	514	520	517	513	521	500	455	416
09/08/2017	CST	390	377	370	366	372	394	451	477	471	473	478	481	482	484	479	478	480	484	480	466	471	457	431	405
09/09/2017	CST	382	371	364	362	362	342	359	377	402	432	446	450	454	453	456	461	469	475	471	464	473	458	429	401
09/10/2017	CST	377	364	355	351	349	353	364	379	411	437	457	476	493	504	507	515	521	532	531	523	525	480	408	388
09/11/2017	CST	379	371	359	354	359	371	409	439	440	452	469	480	485	492	497	509	519	522	514	503	501	491	446	404
09/12/2017	CST	379	366	359	357	364	389	447	477	478	489	499	519	540	561	578	602	609	616	616	612	612	571	514	464
09/13/2017	CST	426	405	394	389	388	407	471	499	492	496	507	523	535	549	554	565	574	577	565	560	558	519	467	420
09/14/2017	CST	392	378	369	364	365	366	366	454	469	463	463	467	462	461	461	453	462	478	476	485	492	466	421	393
09/15/2017	CST	360	348	344	344	351	373	433	464	458	463	466	464	462	460	456	452	456	460	455	458	451	436	409	379
09/16/2017	CST	357	347	340	337	339	345	364	384	409	428	432	428	421	413	405	404	403	403	403	406	412	398	375	350
09/17/2017	CST	323	314	292	273	277	304	343	369	396	398	381	382	380	373	365	364	371	402	414	433	448	423	385	354
09/18/2017	CST	336	327	323	325	334	359	424	452	443	444	448	448	451	454	449	449	449	455	460	473	477	455	414	383
09/19/2017	CST	361	349	342	344	351	378	413	445	434	426	433	431	431	433	435	434	437	443	463	468	448	426	403	370
09/20/2017	CST	346	335	331	331	335	358	416	445	434	435	444	448	453	459	465	467	473	476	468	466	479	453	411	376
09/21/2017	CST	353	342	338	337	343	370	435	464	453	447	450	457	462	469	471	477	483	479	477	491	505	476	435	398
09/22/2017	CST	368	354	346	343	347	369	431	469	460	462	469	477	483	490	496	504	514	520	520	519	512	482	440	399
09/23/2017	CST	370	352	342	336	336	341	361	386	411	428	435	434	429	421	411	411	412	416	422	432	426	408	385	363

**Annual Electric Balancing Authority Area and Planning
 Area Report**

Utility Code: 12658
 Utility Name: Minkota Power Cooperative, Inc.

For the Year Ending December 31, 2017

Part III - Schedule 2. Planning Area Hourly Demand (continued)

Date	Time Zone	0100	0200	0300	0400	0500	0600	0700	0800	0900	1000	1100	1200	1300	1400	1500	1600	1700	1800	1900	2000	2100	2200	2300	2400
(a)	(b)	(c)	(d)	(e)	(f)	(g)	(h)	(i)	(j)	(k)	(l)	(m)	(n)	(o)	(p)	(q)	(r)	(s)	(t)	(u)	(v)	(w)	(x)	(y)	(z)
09/24/2017	CST	346	337	332	328	328	334	348	370	392	412	413	417	423	417	409	419	428	437	444	458	455	430	393	365
09/25/2017	CST	346	337	333	335	341	369	431	467	465	467	471	470	469	464	456	454	456	465	475	489	483	455	418	385
09/26/2017	CST	367	355	345	346	354	382	443	480	468	465	470	469	462	459	455	456	461	468	476	490	490	466	425	397
09/27/2017	CST	376	366	362	362	370	396	464	490	475	465	461	458	456	460	455	457	461	452	458	480	486	461	418	385
09/28/2017	CST	361	349	344	341	349	377	441	475	463	462	465	460	459	457	453	452	453	456	459	478	486	465	428	399
09/29/2017	CST	378	369	367	369	378	407	471	505	492	485	482	470	465	460	452	447	450	451	449	463	471	451	423	398
09/30/2017	CST	380	369	365	364	370	383	409	433	455	463	460	452	441	433	425	425	432	435	432	445	437	418	393	370
10/01/2017	CST	349	339	332	328	325	336	350	376	400	414	422	434	437	431	426	430	438	447	461	463	450	425	400	367
10/02/2017	CST	348	338	335	332	340	373	431	461	451	435	437	435	449	461	436	447	458	460	471	492	484	459	421	391
10/03/2017	CST	376	363	357	357	363	392	456	490	477	474	476	473	463	454	443	441	450	431	413	440	468	458	432	401
10/04/2017	CST	382	375	372	371	381	411	478	510	499	490	488	483	474	466	459	459	460	468	482	510	513	487	450	420
10/05/2017	CST	404	396	374	373	380	421	493	526	505	494	484	472	468	460	451	455	461	459	471	501	503	484	447	419
10/06/2017	CST	415	411	409	410	423	455	524	554	533	524	517	504	490	485	480	473	474	471	470	489	495	486	463	435
10/07/2017	CST	415	409	403	400	400	417	445	473	487	487	477	467	445	433	427	429	430	430	432	452	444	432	411	388
10/08/2017	CST	372	364	361	361	360	369	389	414	438	450	453	455	447	435	427	429	438	448	463	504	501	474	439	412
10/09/2017	CST	396	388	384	390	401	436	502	536	511	504	500	495	486	477	482	492	507	515	533	560	554	537	498	468
10/10/2017	CST	448	442	439	440	449	482	550	585	551	536	522	506	485	460	443	443	465	469	482	513	521	506	467	439
10/11/2017	CST	430	425	424	429	442	477	545	579	556	534	517	499	482	475	465	462	464	471	487	519	523	497	461	431
10/12/2017	CST	417	417	411	412	421	449	514	543	519	509	498	481	467	463	458	453	459	464	470	490	493	476	445	417
10/13/2017	CST	402	399	400	401	410	441	508	545	526	512	505	492	482	472	466	460	458	461	473	507	499	486	461	440
10/14/2017	CST	424	418	416	414	415	426	453	483	508	523	520	513	500	490	485	480	483	491	500	506	496	477	450	432
10/15/2017	CST	418	412	409	413	419	431	453	484	500	507	514	516	509	492	475	467	477	493	506	526	519	498	464	439
10/16/2017	CST	428	424	422	422	425	460	532	567	555	542	524	503	488	479	467	465	465	470	488	511	502	485	454	422
10/17/2017	CST	404	397	398	403	421	437	496	530	502	482	458	440	433	430	429	429	430	436	438	462	444	417	377	347
10/18/2017	CST	330	324	318	317	325	355	423	460	455	448	444	445	436	432	421	415	426	442	466	491	494	487	461	439
10/19/2017	CST	423	418	417	419	428	456	504	536	524	514	490	467	457	461	454	452	454	455	463	486	482	462	423	397
10/20/2017	CST	377	366	361	356	366	391	443	482	477	466	471	470	469	472	473	471	468	467	478	489	475	456	433	405
10/21/2017	CST	384	370	364	360	360	367	388	422	449	471	482	482	474	468	460	468	460	467	478	483	472	455	432	412
10/22/2017	CST	397	391	391	391	395	410	431	457	476	484	473	464	463	459	454	456	461	486	509	520	500	473	436	410
10/23/2017	CST	394	385	376	378	393	433	502	550	548	552	556	556	551	539	528	519	528	555	590	606	594	570	535	506
10/24/2017	CST	487	480	479	479	482	518	586	612	588	574	574	566	556	545	537	538	539	547	537	561	548	539	538	512
10/25/2017	CST	488	480	477	476	484	517	581	616	600	572	552	539	520	517	504	506	515	528	558	578	575	552	514	482
10/26/2017	CST	460	450	445	447	456	490	558	603	590	588	594	590	587	580	587	597	605	623	645	643	632	612	572	544
10/27/2017	CST	529	520	516	518	525	554	611	644	641	638	633	617	608	609	604	598	601	605	620	632	626	612	586	562

Annual Electric Balancing Authority Area and Planning
 Area Report

For the Year Ending December 31, 2017

Part III - Schedule 2. Planning Area Hourly Demand (continued)

Date	Time Zone	0100	0200	0300	0400	0500	0600	0700	0800	0900	1000	1100	1200	1300	1400	1500	1600	1700	1800	1900	2000	2100	2200	2300	2400
(a)	(b)	(c)	(d)	(e)	(f)	(g)	(h)	(i)	(j)	(k)	(l)	(m)	(n)	(o)	(p)	(q)	(r)	(s)	(t)	(u)	(v)	(w)	(x)	(y)	(z)
10/29/2017	CST	543	524	530	528	531	544	563	590	615	625	626	616	605	588	569	561	571	583	600	614	599	576	543	499
10/29/2017	CST	485	480	498	499	494	481	498	531	552	562	571	566	552	534	533	540	554	573	597	613	605	580	548	517
10/30/2017	CST	500	492	491	498	507	542	613	660	637	634	642	646	642	643	643	653	666	681	703	706	691	662	620	584
10/31/2017	CST	566	558	558	561	569	604	671	710	697	684	675	663	646	636	627	625	638	647	659	661	659	643	607	581
11/01/2017	CST	564	555	551	538	531	567	640	676	664	653	633	609	623	595	628	635	648	635	639	636	622	591	548	554
11/02/2017	CST	549	537	527	525	535	558	618	655	652	645	635	624	617	617	614	616	631	629	652	652	634	604	573	593
11/03/2017	CST	565	553	550	549	556	585	643	669	651	644	639	633	664	651	636	635	623	597	609	606	593	581	544	553
11/04/2017	CST	525	511	535	531	535	553	573	569	566	596	595	597	624	605	588	582	581	573	585	583	561	542	515	532
11/05/2017	CST	513	509	509	513	512	524	548	565	557	583	590	591	590	631	614	609	609	629	625	620	614	600	591	579
11/06/2017	CST	627	613	616	620	620	635	667	720	710	695	680	669	661	697	678	676	685	681	686	663	670	702	663	633
11/07/2017	CST	670	652	645	645	649	664	702	768	747	685	650	622	599	636	617	605	617	642	656	665	659	641	611	572
11/08/2017	CST	599	574	564	562	562	575	609	671	664	627	571	532	563	587	618	647	647	668	652	639	629	669	623	586
11/09/2017	CST	626	602	594	592	594	608	643	713	706	681	666	663	658	706	690	683	691	711	741	756	746	733	710	681
11/10/2017	CST	730	709	698	690	683	684	713	763	753	759	761	758	751	807	790	771	763	762	743	739	722	704	678	638
11/11/2017	CST	675	644	626	614	600	598	612	631	622	630	633	625	608	636	615	601	601	616	627	629	618	604	582	561
11/12/2017	CST	594	569	556	549	547	549	561	582	578	593	556	592	591	627	603	590	593	621	646	652	646	632	607	575
11/13/2017	CST	607	587	575	569	567	572	601	664	663	643	634	625	611	629	612	603	606	625	633	631	620	604	577	562
11/14/2017	CST	546	531	506	501	501	514	548	623	665	642	630	590	583	575	572	575	605	624	644	620	602	588	568	537
11/15/2017	CST	527	517	511	503	503	522	560	635	680	682	665	672	669	662	666	666	678	697	726	726	715	676	649	609
11/16/2017	CST	580	566	569	565	568	569	587	638	676	660	658	650	643	641	641	635	639	654	680	679	664	645	614	573
11/17/2017	CST	540	516	501	493	489	501	530	588	618	599	596	590	580	569	559	549	560	587	617	617	610	598	583	561
11/18/2017	CST	540	524	519	522	526	535	551	580	608	626	630	624	617	606	596	581	587	609	649	643	632	625	611	586
11/19/2017	CST	570	561	557	555	557	559	567	583	602	608	599	579	562	542	524	508	515	545	589	598	596	585	564	534
11/20/2017	CST	512	502	498	497	500	513	545	606	639	614	606	598	581	561	550	539	537	556	600	608	607	603	586	555
11/21/2017	CST	537	531	537	546	553	574	610	679	713	686	669	655	637	625	623	620	624	653	691	689	685	677	647	609
11/22/2017	CST	583	578	580	580	585	600	632	691	718	708	702	689	669	654	647	633	624	627	650	639	625	607	579	546
11/23/2017	CST	527	509	502	498	497	500	509	520	542	566	582	578	559	520	489	463	459	465	492	496	499	490	476	453
11/24/2017	CST	430	414	406	401	399	405	421	447	470	480	492	497	489	471	457	448	454	476	500	494	491	491	492	474
11/25/2017	CST	458	451	449	454	459	474	491	516	540	554	558	550	536	521	505	498	508	530	565	568	565	560	547	525
11/26/2017	CST	504	488	479	472	467	466	472	488	509	521	521	517	512	513	513	508	513	542	586	583	576	562	544	512
11/27/2017	CST	483	468	466	465	463	470	500	564	581	562	560	552	537	557	539	521	526	544	559	556	550	533	507	469
11/28/2017	CST	472	449	440	438	446	461	496	566	586	557	542	540	540	568	560	548	550	578	591	595	590	582	563	533
11/29/2017	CST	565	546	535	528	529	541	572	631	632	611	600	584	571	600	575	557	564	586	599	604	602	587	554	518
11/30/2017	CST	521	492	487	488	495	512	542	598	611	586	565	555	552	591	565	553	567	592	611	615	610	604	583	550

**Annual Electric Balancing Authority Area and Planning
 Area Report**

Utility Code: 12658
 Utility Name: Minnkota Power Cooperative, Inc.

For the Year Ending December 31, 2017

Part III - Schedule 2. Planning Area Hourly Demand (continued)

Date	Time Zone	0100 (c)	0200 (d)	0300 (e)	0400 (f)	0500 (g)	0600 (h)	0700 (i)	0800 (j)	0900 (k)	1000 (l)	1100 (m)	1200 (n)	1300 (o)	1400 (p)	1500 (q)	1600 (r)	1700 (s)	1800 (t)	1900 (u)	2000 (v)	2100 (w)	2200 (x)	2300 (y)	2400 (z)
12/01/2017	CST	556	533	529	505	499	506	530	592	618	599	589	580	567	589	565	566	558	575	590	586	580	588	539	516
12/02/2017	CST	538	516	514	519	522	529	546	570	566	578	570	554	538	568	532	508	506	534	560	563	557	548	536	515
12/03/2017	CST	539	514	500	493	491	495	506	529	537	549	554	555	556	592	569	555	558	594	599	596	584	565	541	506
12/04/2017	CST	522	501	490	467	452	461	513	585	606	591	590	596	603	648	636	625	634	659	666	666	664	649	635	604
12/05/2017	CST	642	625	614	610	613	625	659	724	721	709	696	685	679	738	720	705	709	737	745	747	741	729	700	659
12/06/2017	CST	700	674	659	654	653	662	693	761	755	736	725	709	697	751	736	726	731	753	756	759	754	742	715	677
12/07/2017	CST	722	697	686	681	680	686	713	678	627	608	705	735	661	701	671	659	684	697	672	647	637	625	601	581
12/08/2017	CST	617	590	575	553	547	559	591	654	668	659	647	632	596	635	617	599	604	646	649	642	636	607	580	564
12/09/2017	CST	606	579	578	576	584	592	602	623	605	620	620	602	587	634	615	609	613	639	633	623	613	588	580	551
12/10/2017	CST	587	553	519	505	501	501	509	535	542	575	577	571	570	608	565	552	555	590	602	611	618	602	579	537
12/11/2017	CST	549	519	498	489	483	509	545	615	639	609	612	627	629	675	664	663	678	721	734	736	730	719	700	662
12/12/2017	CST	707	680	669	661	656	658	683	735	715	665	651	639	626	667	638	618	608	627	650	652	640	627	603	563
12/13/2017	CST	580	547	529	522	523	534	575	639	648	640	630	623	600	650	634	636	655	688	688	687	665	654	636	608
12/14/2017	CST	648	633	616	580	572	574	560	536	579	599	648	679	638	683	665	651	664	693	682	681	666	655	620	585
12/15/2017	CST	621	597	593	591	590	598	623	683	664	644	635	624	624	683	656	643	647	666	654	650	637	632	616	591
12/16/2017	CST	626	596	575	564	559	562	577	597	598	610	612	608	599	635	607	590	592	616	635	634	632	625	611	578
12/17/2017	CST	608	582	566	557	554	564	565	584	580	593	592	578	556	584	568	543	551	588	621	635	633	615	588	548
12/18/2017	CST	577	547	528	517	514	522	553	618	630	611	585	572	564	600	583	572	583	616	622	609	596	593	553	511
12/19/2017	CST	529	515	518	517	525	539	575	631	642	638	630	618	607	658	645	625	643	677	693	705	706	696	675	638
12/20/2017	CST	683	664	653	644	643	649	679	740	738	721	711	707	700	745	728	716	715	736	728	739	734	722	696	657
12/21/2017	CST	703	682	668	659	660	674	710	778	775	760	746	726	702	752	724	713	719	757	769	779	784	783	759	720
12/22/2017	CST	774	758	744	723	714	716	729	774	760	746	730	718	698	744	725	707	701	721	718	710	699	686	668	638
12/23/2017	CST	684	660	647	636	637	641	653	675	707	731	731	713	689	660	638	624	635	665	696	693	685	677	675	657
12/24/2017	CST	641	627	623	621	625	632	647	689	705	734	748	738	723	707	693	685	679	698	748	751	744	743	739	729
12/25/2017	CST	721	715	712	713	719	728	738	757	783	804	804	793	779	759	741	733	742	768	811	819	822	820	806	781
12/26/2017	CST	758	746	745	746	750	756	777	813	800	807	808	802	790	854	832	813	815	842	842	851	844	826	806	777
12/27/2017	CST	839	814	801	795	797	808	831	867	861	788	816	800	806	860	834	818	825	851	840	839	831	816	787	748
12/28/2017	CST	796	767	749	735	723	723	741	778	763	762	762	750	720	790	776	762	762	788	793	802	805	797	776	747
12/29/2017	CST	807	782	768	760	757	760	740	692	674	724	774	810	777	827	850	833	824	843	833	833	826	821	810	786
12/30/2017	CST	850	831	818	813	808	811	821	836	799	796	767	732	720	825	845	828	788	748	730	714	685	672	727	827
12/31/2017	CST	883	855	840	828	827	825	827	835	802	806	804	793	779	838	814	799	800	828	870	864	852	837	819	800

**Annual Electric Balancing Authority Area and Planning
 Area Report**

Utility Code: 12658
 Utility Name: Minkota Power Cooperative, Inc.

For the Year Ending December 31, 2017

Part III - Schedule 2. Forecast Summer and Winter Peak Demand and Annual Net Energy for Load

Provide the planning area's forecast summer and winter peak demand, in megawatts, and annual net energy for load, in megawatthours, for the next ten years.

Line No (a)	Year (b)	Summer Forecast (MW) (c)	Winter Forecast (MW) (d)	Forecast of Annual Net Energy for Load (MWh) (e)
1	2018	689	1,067	4,616,126
2	2019	706	1,093	4,688,853
3	2020	724	1,119	4,759,387
4	2021	741	1,145	4,829,167
5	2022	758	1,172	4,898,358
6	2023	776	1,198	4,966,849
7	2024	792	1,224	5,035,439
8	2025	810	1,249	5,102,583
9	2026	827	1,275	5,169,110
10	2027	844	1,301	5,234,997







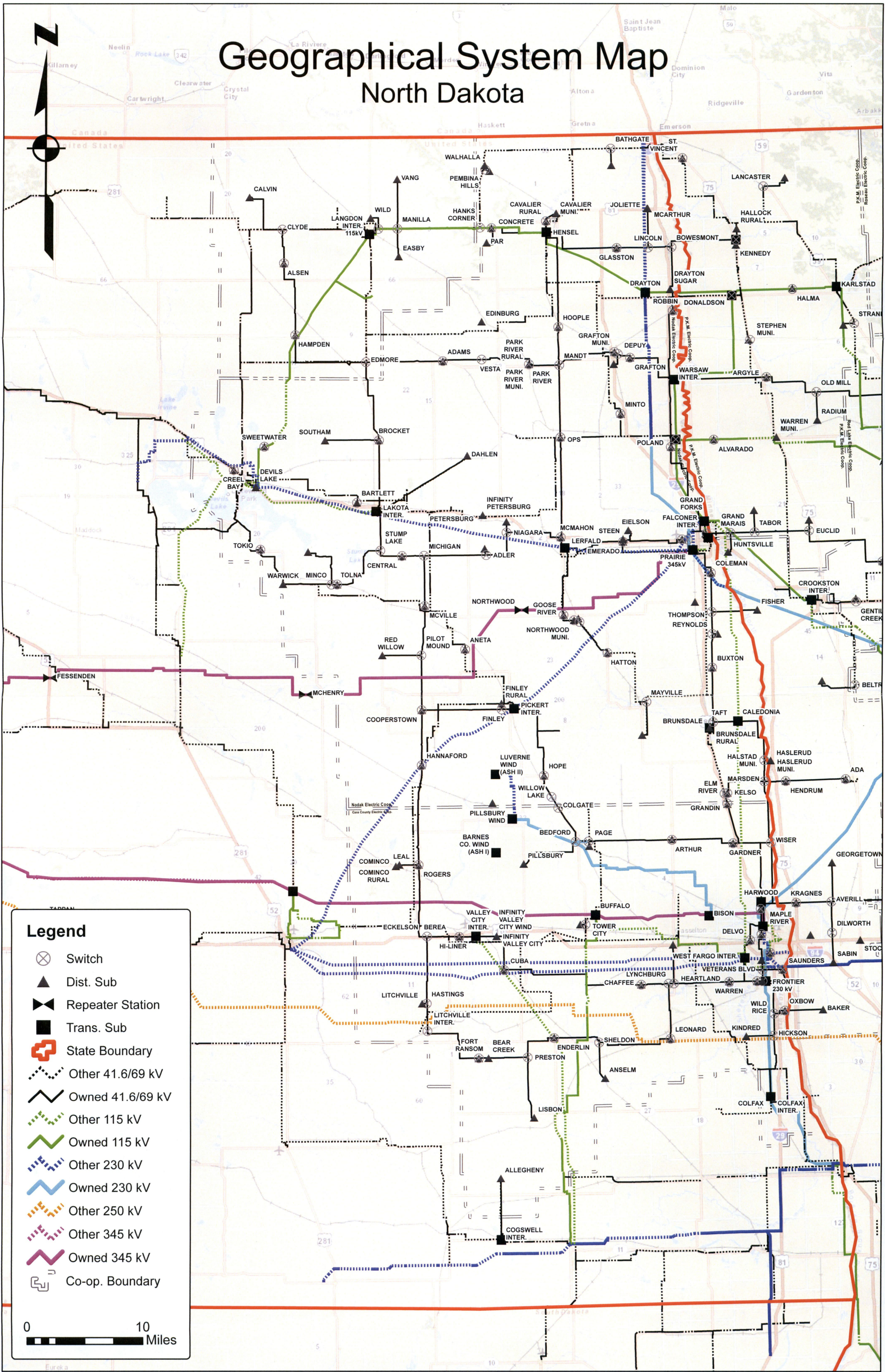



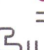

EXHIBIT III

Minnkota Power Cooperative Electric System Maps

Geographical System Map North Dakota

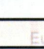

Legend

-  Switch
-  Dist. Sub
-  Repeater Station
-  Trans. Sub
-  State Boundary
-  Other 41.6/69 kV
-  Owned 41.6/69 kV
-  Other 115 kV
-  Owned 115 kV
-  Other 230 kV
-  Owned 230 kV
-  Other 250 kV
-  Other 345 kV
-  Owned 345 kV
-  Co-op. Boundary



Geographical System Map Minnesota



Legend

- ⊗ Switch
- ▲ Dist. Sub
- ⚡ Repeater Station
- Trans. Sub
- ⊕ State Boundary
- ⋯ Other 41.6/69 kV
- Owned 41.6/69 kV
- ⋯ Other 115 kV
- Owned 115 kV
- ⋯ Other 230 kV
- Owned 230 kV
- ⋯ Other 250 kV
- ⋯ Other 345 kV
- Owned 345 kV
- ⊞ Co-op. Boundary

1 in = 20 miles

0 20 Miles

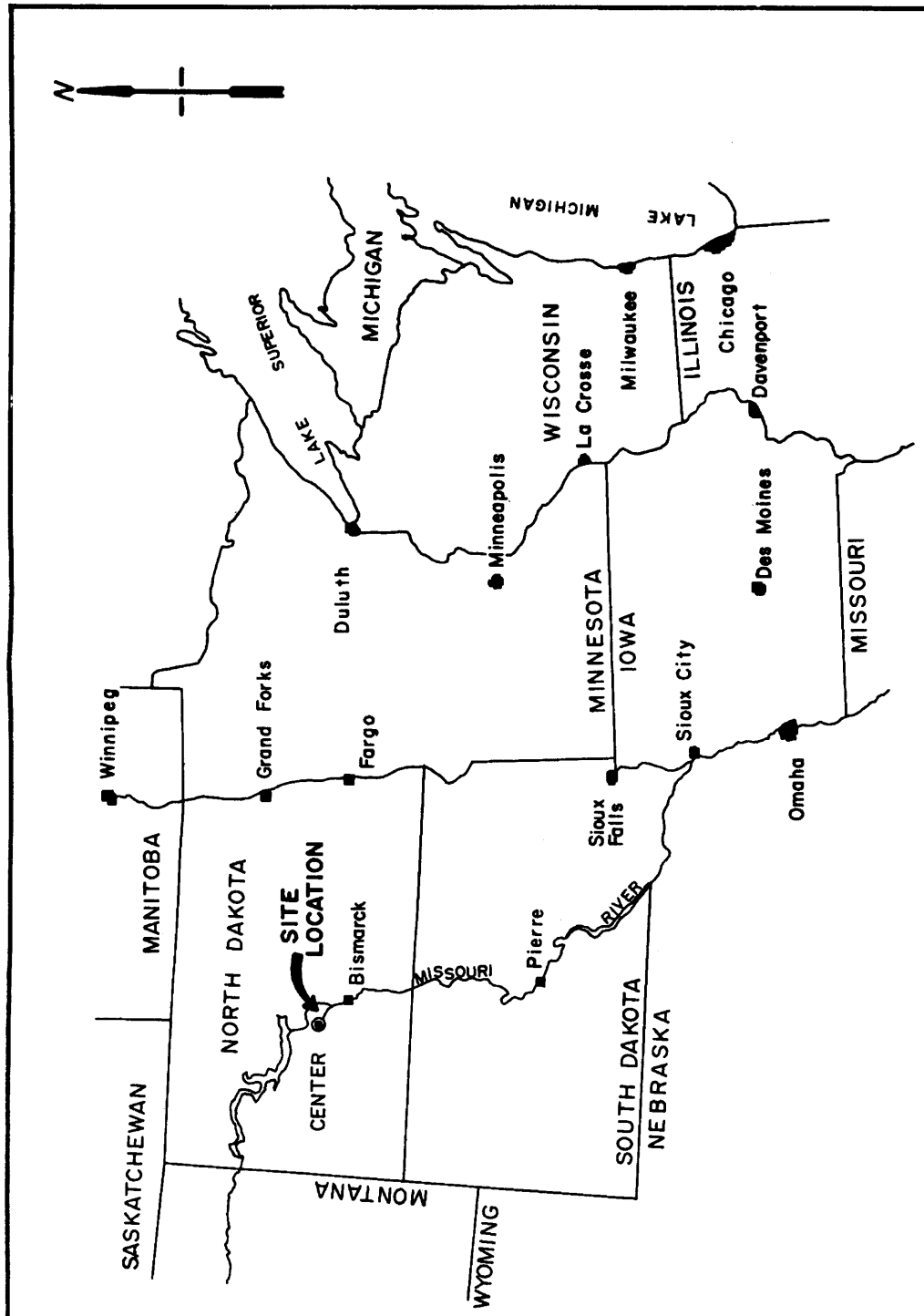
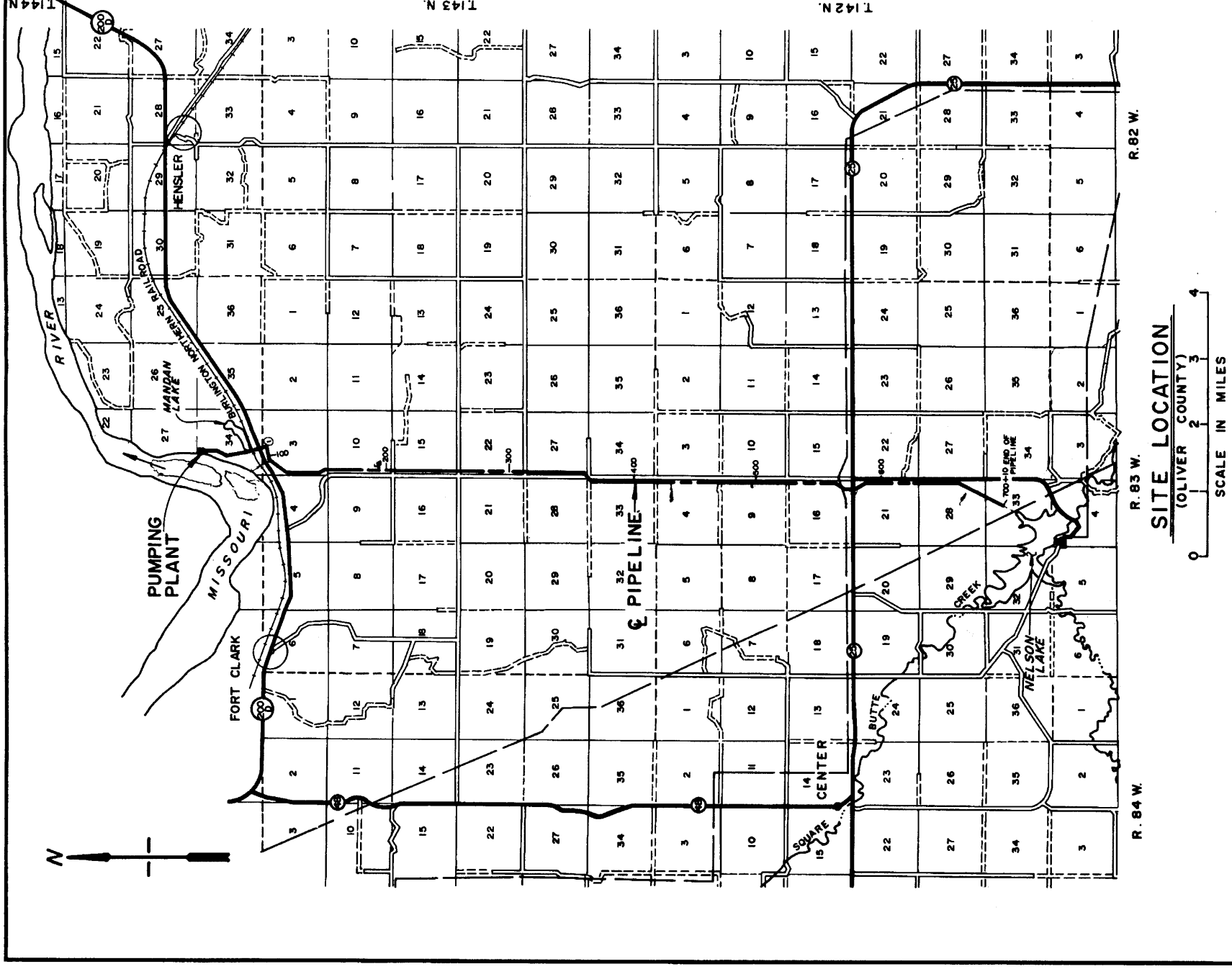

REV. DATE	DESCRIPTION	BY	APPROVED	REV. DATE	DESCRIPTION	BY	APPROVED
<p>DESIGNED UNDER RESPONSIBLE SUPERVISION OF <i>BRAND (Seal)</i> ARCHITECT COMMONWEALTH ASSOCIATES INC. 208 E. WASHINGTON AVE. JACKSON, MICH.</p>							
<p>PREPARED AND DRAFTING DATE 11-21-73 CHK. DATE 12-12-73</p>							
<p>(SEAL)</p>							
<p>OWNER AND LOCATION SQUARE BUTTE ELECTRIC COOPERATIVE GRAND FORKS, NORTH DAKOTA MILTON R. YOUNG STATION CENTER, NORTH DAKOTA</p>				<p>TITLE NELSON LAKE MAKEUP SYSTEM LOCATION & SITE MAP</p>			
<p>JOB NO. 0971-005-032</p>				<p>DRAWING NO. 1</p>			
<p>SHEET</p>				<p>REV.</p>			