

**Late Filed Exhibit 6: Plot Plan (Revised)**

## EQUIPMENT LEGEND

- |   |  |
|---|--|
| <p>① V-1000 SLUG CATCHER</p> <p>② F-1001 A/B CONDENSATE FILTERS</p> <p>③ V-1050 INLET GAS SEPARATOR</p> <p>④ E-1100 PIPELINE LIQUIDS HEATER</p> <p>⑤ C-1300/1400 RESIDUE GAS COMPRESSORS</p> <p>⑥ HAL-1300 /1400 RESIDUE COMPRESSOR COOLERS</p> <p>⑦ F-1500 RESIDUE GAS FILTER COALESCER</p> <p>⑧ F-1530 SEAL GAS FILTER</p> <p>⑨ E-1250 INLET GAS PREHEATER</p> <p>⑩ V-9050 CONDENSATE SURGE TANK</p> <p>⑪ F-9060 CONDENSATE WATER COALESCER</p> <p>⑫ STABILIZER SKID</p> <p>⑬ V-403 COLD DRAIN TANK</p> <p>⑭ P-1600/1700 CRYO NGL PIPELINE PUMPS</p> <p>⑮ V-2100 STABILIZER NGL SURGE TANK</p> <p>⑯ P-2150A/B STABILIZER NGL BOOSTER PUMP</p> <p>⑰ P-2160/2170 STABILIZER NGL PIPELINE PUMP</p> <p>⑱ C-9300/9400 STABILIZER OVERHEAD COMPRESSOR</p> <p>⑲ HAL-9300/9400 STABILIZER OVERHEAD COMPRESSOR COOLER</p> <p>⑳ AC-1750 NGL PRODUCT COOLER</p> <p>㉑ C-4001A/B INSTRUMENT AIR COMPRESSOR PACKAGE</p> <p>㉒ V-4010 INSTRUMENT AIR RECEIVER</p> <p>㉓ V-5000 FLARE KNOCKOUT DRUM</p> <p>㉔ FL-5100 FLARE</p> <p>㉕ TK-6000/6050 SLOP TANKS</p> <p>㉖ CHROMATOGRAPH BUILDING</p> <p>㉗ P-5050 FLARE K.O. PUMP</p> <p>㉘ TK-6200 STABILIZER AREA DRAIN SUMP</p> <p>㉙ P-6205 STABILIZER AREA DRAIN SUMP PUMP</p> <p>㉚ TK-6300 COMPRESSOR BUILDING DRAIN SUMP</p> <p>㉛ P-6305 COMPRESSOR BUILDING DRAIN SUMP PUMP</p> | <p>㉜ TK-6400 CRYO AREA DRAIN SUMP</p> <p>㉝ P-6405 CRYO AREA DRAIN SUMP PUMP</p> <p>㉞ TK-7000 FRAME LUBE OIL STORAGE TANK</p> <p>㉟ P-7005 FRAME LUBE OIL PUMP</p> <p>㊱ TK-7050 CYLINDER LUBE OIL STORAGE TANK</p> <p>㊲ P-7055 CYLINDER LUBE OIL PUMP</p> <p>㊳ TK-7700 METHANOL STORAGE TANK (CRYO)</p> <p>㊴ TK-7750 METHANOL STORAGE TANK (PLANT)</p> <p>㊵ SWITCH RACK</p> <p>㊶ STABILIZER HMO HEATER</p> <p>㊷ STABILIZER HMO PUMP SKID</p> <p>㊸ A-301 EXPANDER COMPRESSOR AFTERCOOLER</p> <p>㊹ UPPER LOWER FILTER SKIDS</p> <p>㊺ V-442/443/444 MOL SIEVE DEHYDRATORS</p> <p>㊻ SWITCHING VALVE SKID</p> <p>㊼ UPPER LOWER PROCESS SKIDS</p> <p>㊽ EC-101 TURBO EXPANDER SKID</p> <p>㊾ V-402 COLD SEPARATOR</p> <p>㊿ E-201/206 GAS/GAS EXCHANGER/REFLUX CONDENSER</p> <p>1 T-501 DEMETHANIZER</p> <p>2 E-204/205 REBOILER/SIDE HEATER</p> <p>3 V-404 PRODUCT SURGE TANK</p> <p>4 P-600/601/602 PRODUCT CHARGE PUMPS</p> <p>5 H-74/REGEN GAS HEATER</p> <p>6 H-781 CRYO HMO HEATER</p> <p>7 H-781 CRYO HMO PUMP SKID</p> <p>8 A-341 REGEN GAS COOLER</p> <p>9 TK-7100 STABILIZER OH CYLINDER LUBE OIL STORAGE TANK</p> <p>10 P-7760 STABILIZER OH CYLINDER LUBE OIL STORAGE TANK PUMP</p> <p>11 P-7760 METHANOL INJECTION PUMP</p> <p>12 V-5200 CLOSED DRAIN TANK</p> |
|---|--|

NOTES:

PRELIMINARY
ISSUED FOR: CLIENT REVIEW & COMMENT
ISSUED BY: WILLIAM SEAN TROTTER, P.E.
LICENSE: ND PE #27584
This document is issued on a Preliminary basis only for the purpose stated above, and is not a final, signed and sealed document. It is NOT issued for Construction, Permitting, or any other purpose.

NO.	REFERENCE DRAWINGS	TITLE	NO.	FIRM	DATE	REVISIONS	BY	CHK	APP.
B1	949PE	09/14/18				ISSUED FOR APPROVAL	RJ	MDP	WST

ENGINEERING RECORD			
PROJ. MGR.	PROJ. ENGR.	PROJ. DESIGN	WELD CODE:
KEVIN BULLOCK	MICHAEL PREBLE	ROBERT JAQUEZ	

<p style="font-size: small;">ROOSEVELT II PROCESSING FACILITY 150MM GAS PROCESSING FACILITY PLOT PLAN</p>	<p style="font-size: small;">MCKENZIE CO., ND</p> <p style="font-size: small;">PLOT SCALE: NONE</p> <p style="font-size: small;">DWG. NO. D-10487-C03-100</p>
---	---

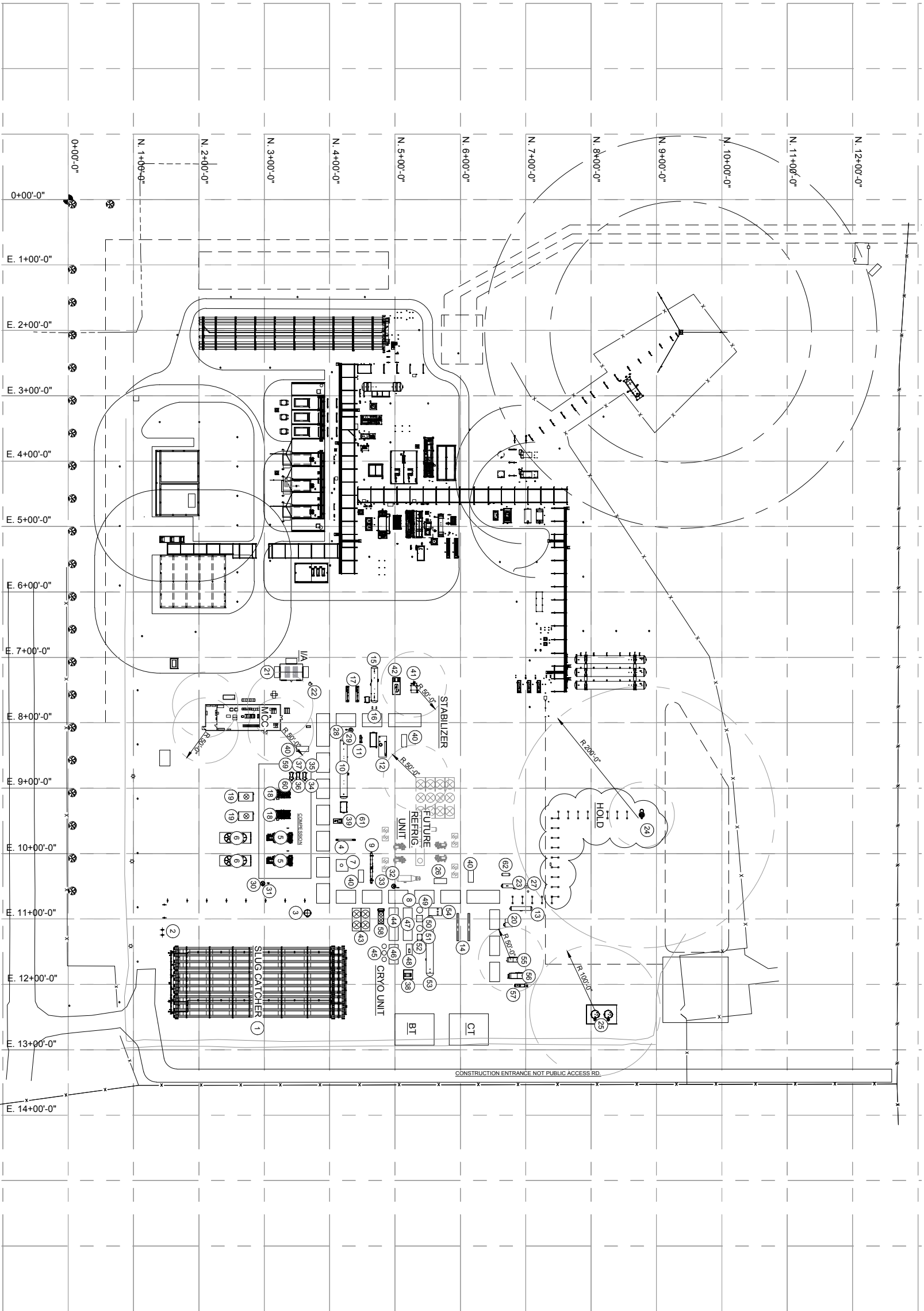

NOTES:

**PRELIMINARY**

ISSUED FOR: CLIENT REVIEW & COMMENT

ISSUED BY: WILLIAM SEAN TROTTER, P.E.

LICENSE: ND PE #27584  
 This document is issued on a Preliminary basis only for the purpose stated above, and is not a final, signed and sealed document. It is NOT issued for Construction, Permitting, or any other purpose.

REFERENCE DRAWINGS

NO.	TITLE
B1	943PE 09/14/18 ISSUED FOR APPROVAL

REVISIONS

NO.	FIRM	DATE	DESCRIPTION	BY	CHK	APP.
B1	943PE	09/14/18	ISSUED FOR APPROVAL	RJ	MDP	WST

ENGINEERING RECORD

PROJ. MGR.	PROJ. ENGR.	PROJ. DESIGN	PROJ. MGR.	PROJ. ENGR.	PROJ. DESIGN
KEVIN BULLOCK	MICHAEL PREBLE	ROBERT JAQUEZ	KEVIN BULLOCK	MICHAEL PREBLE	ROBERT JAQUEZ

NO.	DATE	DESCRIPTION	BY	CHK	APP.
10487					

**KINDER MORGAN**

ROOSEVELT II PROCESSING FACILITY  
 150MM GAS PROCESSING FACILITY  
 PLOT PLAN

MCKENZIE CO., ND

PLOT SCALE: NONE  
 DWG NO. D-10487-C03-100  
 FILE NAME: C03-100

REV B1