

Site/Project Location: Aurora Wind Farm

Date of Inspection: 21 October 2019

Keitu staff visited the Aurora Wind Transmission Project for a start of project topsoil inspection for the transmission line portion of the wind farm project. Inspection of construction sites to focus on (1) confirming surface disturbance/work occurring within ND PSC-approved work corridor and/or route; (2) topsoil segregation occurring; (3) vegetation removal consistent with tree & scrub mitigation plan.

Observed Work / Weather Conditions

Visit occurred between 8:30am and 11:30am. The weather was clear and sunny, temperature at 21°F, winds at 3-5 mph out of the north and no precipitation.

The Aurora Wind Transmission project kicked off its construction at the time of the visit. One grader started stripping topsoil for the laydown yard located in a harvested crop field. The layout yard and access road are located on the NW ¼ of Section 19, Township 158N, Range 96W on the south side of 75th St. NW.

Top Soil Management / Condition / Erosion Control / Stormwater Management

A grader started stripping topsoil on the south and east sides of the laydown yard which was located in a recently harvested crop field. Topsoil depth varied from 8-12 inches deep in the areas stripped during the inspection. The low lying areas on the northwest side of the substation had significantly deeper topsoil depth of 12 inches or more. The grader removed topsoil and relocated it to the southern border of the substation to be used as a perimeter berm. The topsoil was pushed into piles to be picked up with a grader and used as a perimeter berm.

The grader operator demonstrated proper understanding of the rules and regulation for topsoil removal and removed the topsoil to a depth where the subsoil started to appear. The soil was saturated due to the high amount of precipitation in September and early October. The bulldozer operator made multiple passes over the same ground to remove the wet topsoil in increments to smoothly strip the topsoil layer at proper depths across the varying contours of the field.

Vegetation Condition

No evidence of tree or shrub removal was noted as the project site was located in a field used for crop production.

Deficiencies

Deficiencies were not found at the time of inspection.

Actions Taken/To Be Taken

Topsoil segregation was noted to be acceptable at this time in the areas observed. Equipment operator was reminded to strip soil, where it existed, down to a maximum of 12 inches or to the depth where subsoil appeared. Equipment operators have demonstrated proficiency in topsoil removal and segregation in compliance with the Commission's Order.

Keitu Inspector: ZAP

Inspection Report Submitted: 12 November 2019

Report Photo #1 “Grader Stripping Topsoil”



Report Photo #2 “Subsoil Showing After Topsoil Removal”



Report Photo #3 "Grader Relocating Stripped Topsoil for Perimeter Berm"

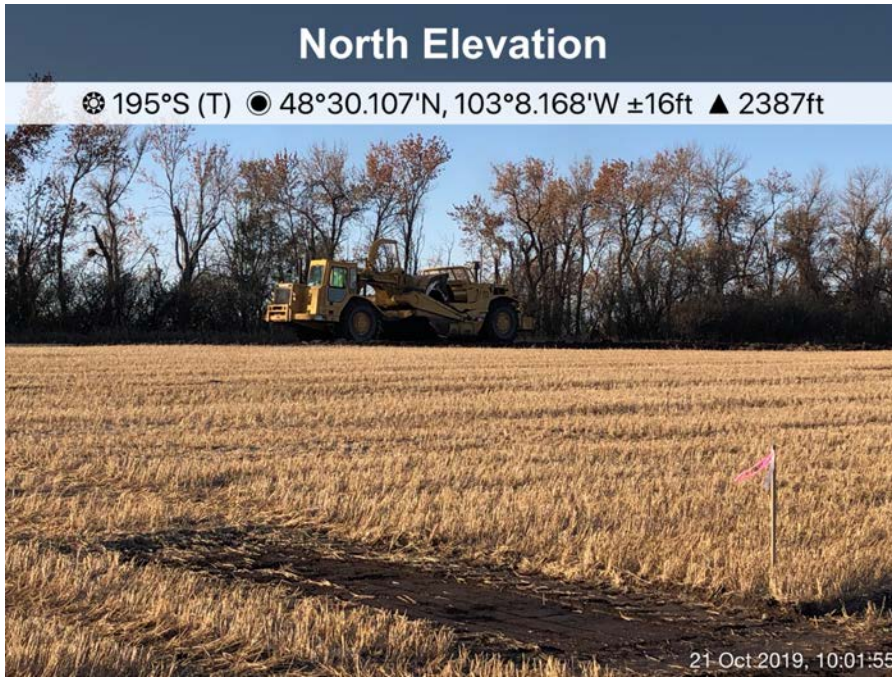

Site Location Map

