

**From:** [Troy Holzworth](#)  
**To:** [timrk@verendrye.com](mailto:timrk@verendrye.com)  
**Cc:** [steve.rotherham@summitutility.com](mailto:steve.rotherham@summitutility.com)  
**Subject:** PU-18-375  
**Date:** Wednesday, November 14, 2018 9:51:09 PM  
**Attachments:** [Summit damage sketch.pdf](#)

---

To Whom it may be concerned:

Ticket 18090429 was located the evening of 7-26-18 and all photos were uploaded to our system the morning of 7-27-18.

Our locating technician used state of the art locating equipment with multiple frequency capability to locate this ticket. See attached damage sketch for reference.

The line was damaged approximately 12 feet from a section can with two feeds coming out of it. The line was damaged close to a 90 degree turn in the route of the cable. The line damage was an old concentric neutral wrapped line and many of these lines are now being replaced because of the neutral being eroded over time, these lines are the most difficult lines to locate. The signal on the line going thru the corner was pushed to the inside curve of the actual location of the source cable thus making the accuracy outside the state tolerance of 24". The line was damaged at approximately 24.5 inches from the paint put on the ground.

Our locator did the job correct, they read the maps, used direct connection, swept the area for any other non-target utilities in the area and then painted the target conductor in the spot that the locating equipment indicated. This ended up being just barley outside the 24 inch tolerance zone. Summit respects the homeowners concern and we understand the potential issue with a mis-locate. We are very happy that no one was injured and have taken full responsibility for the repair of this cable.

Respectfully,

Troy Holzworth  
Summit Utility Services, LLC.  
President  
P.O. 18159  
Missoula, Mt 59808  
406-207-0158















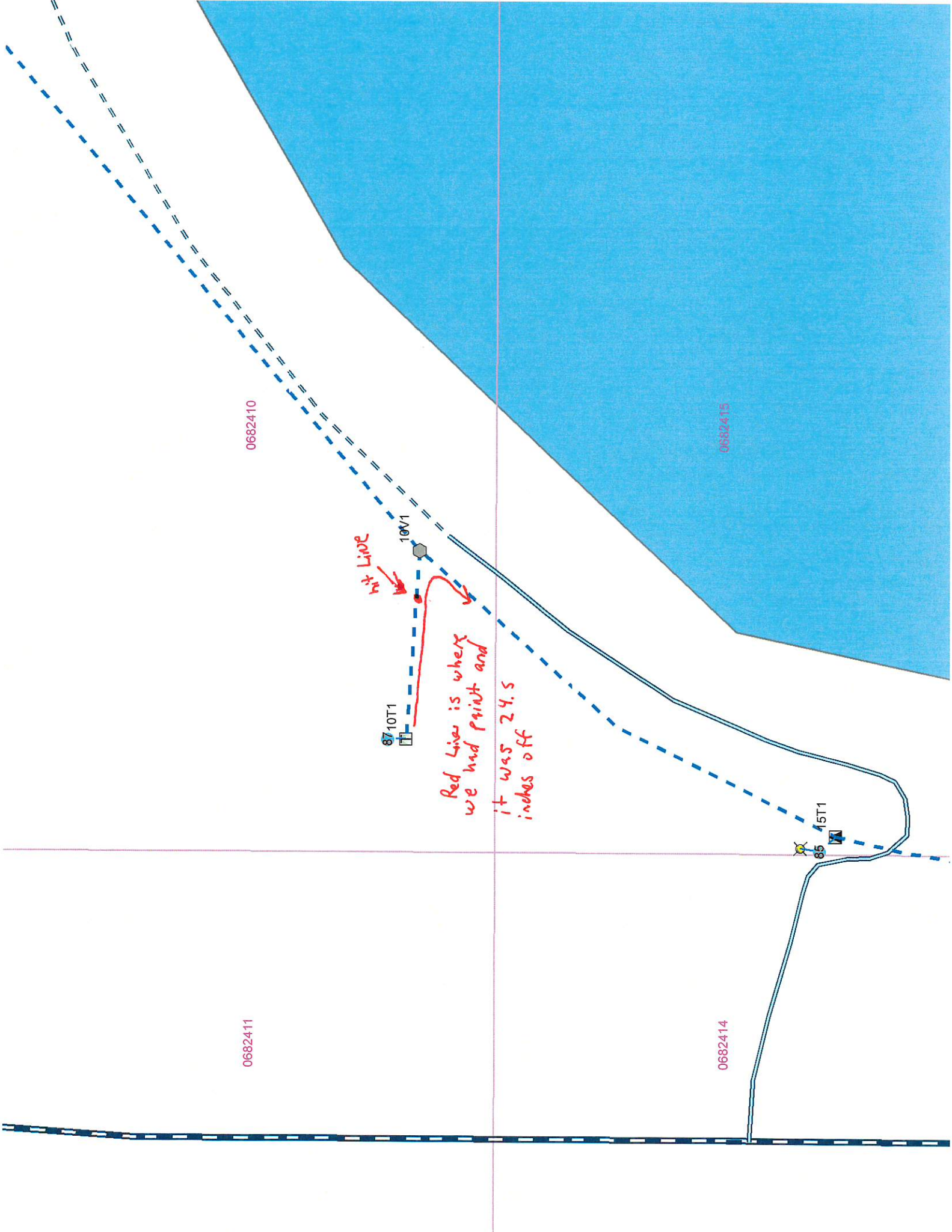

0682410

0682415

0682411

0682414

hit LINE

Red Line is where we had print and it was 24.5 inches off

87 10T1

10V1

85 15T1

85