

Ruso Wind Partners, LLC
Ruso Wind Project and Gen-Tie Line Project
Docket Nos. PU-19-28/PU-19-29

Late-Filed Exhibit No. 50 – Modifications to Gen-Tie Line Structure Locations

At the public hearing, the Commission requested information regarding modifications to Gen-Tie Line structure locations made as a result of recent wetland and cultural surveys. An updated figure showing the final Gen-Tie Line layout, with the modifications, is provided herewith as **Late-Filed Exhibit No. 50(a)**. A figure comparing the structure locations presented in Hearing Exhibit No. 11 with the locations presented in Late-Filed Exhibit No. 50(a) is also provided herewith as **Late-Filed Exhibit No. 50(b)**.

109 PU-19-29 Filed 08/09/2019 Pages: 3
Late-filed Exhibit 50 - Modifications to transmission line structures
Ruso Wind Partners, LLC

109 PU-19-28 Filed 08/09/2019 Pages: 3
Late-filed Exhibit 50 - Modifications to transmission line structures
Ruso Wind Partners, LLC

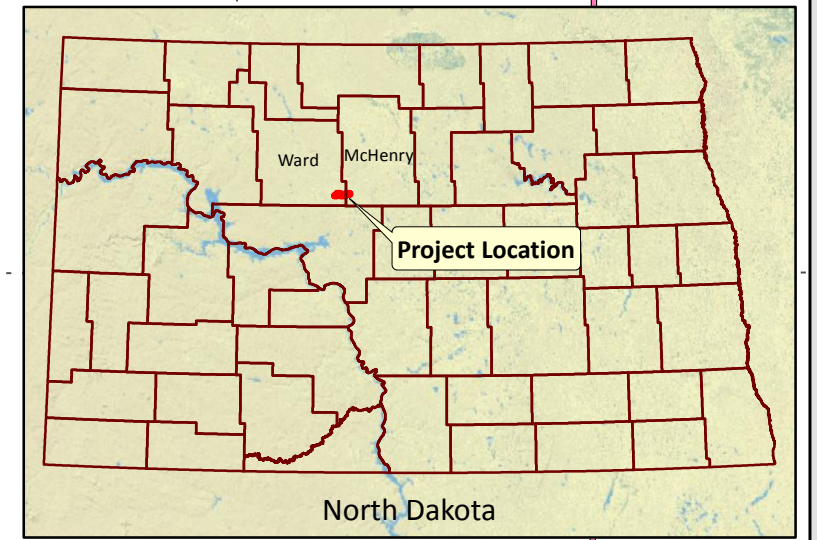
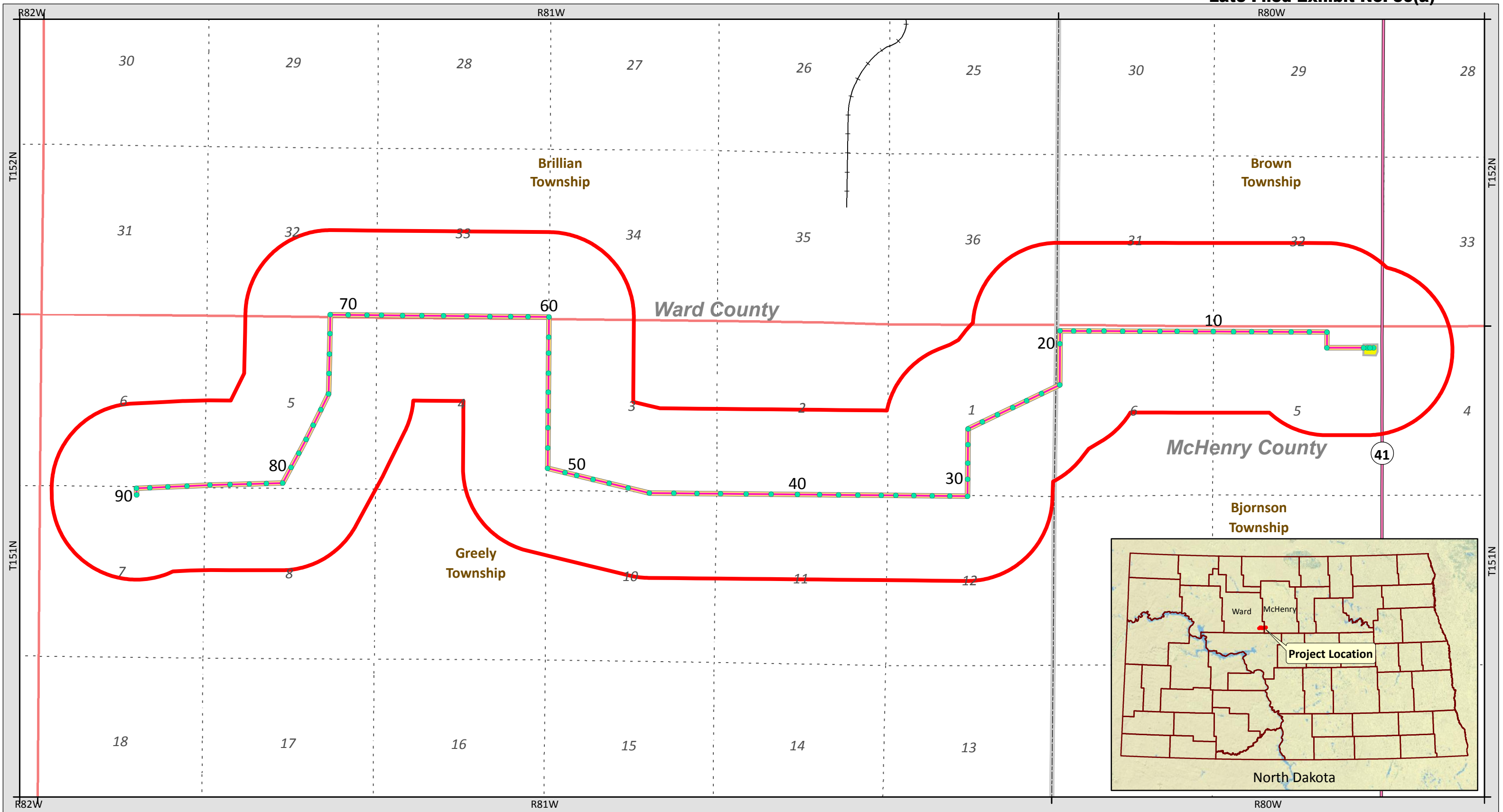

KLJ **Southern Power**

0 0.25 0.5 1 Miles

1:34,000

KLJ Project Number: 1809-00886
Date Created: 7/17/2019 Created By: JDP

Final Transmission Line Route
Ruso Wind Transmission Line Project & Switching Station
 Counties of Ward & McHenry, ND

- Project Corridor
- Designated Corridor
- Project Route
- Structures
- Switching Station
- State Highway
- Railroad
- Section
- Township
- County Boundary

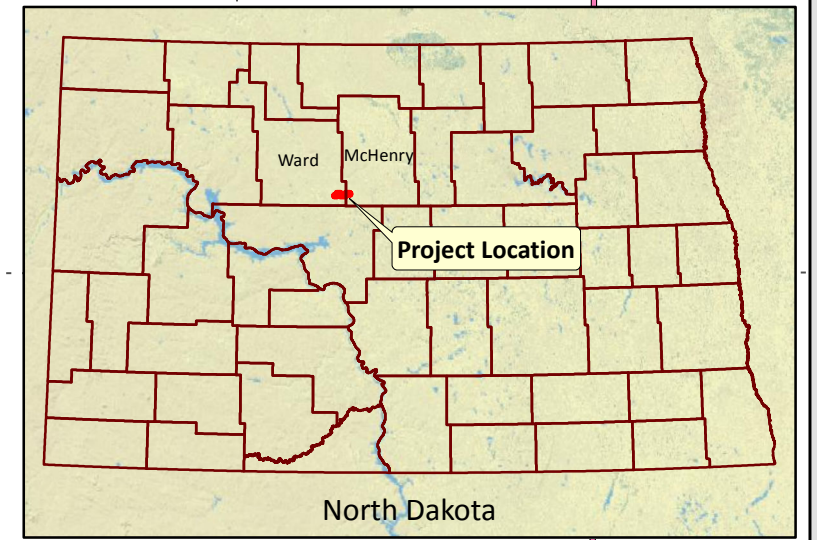
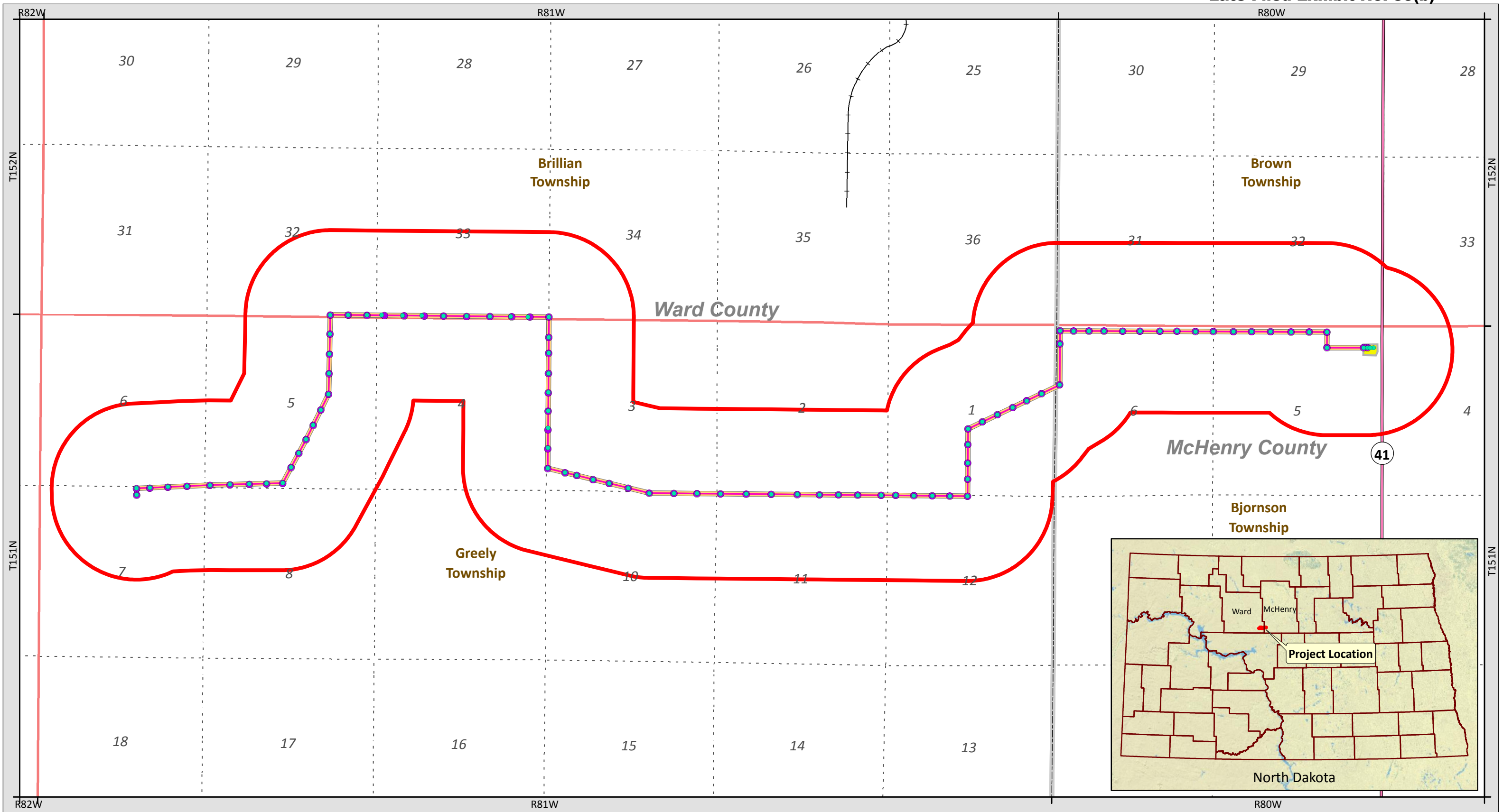

KLJ **Southern Power**

0 0.25 0.5 1 Miles

1:34,000

KLJ Project Number: 1809-00886
Date Created: 7/17/2019 Created By: JDP

Previous Layout vs. Current Layout
Ruso Wind Transmission Line Project & Switching Station
 Counties of Ward & McHenry, ND

Current Layout	Previous Layout	State Highway
• Structures	• Structures	— Railroad
— Project Route	— Project Route	- - - Section
■ Designated Corridor	Current/Previous Layout	□ Township
	■ Project Corridor	□ County Boundary
	■ Switching Station	