

**BNI Coal, LTD.**  
**General Manager's Certificate**

I, Michael Heger, do hereby certify that I am the duly appointed General Manager of BNI Coal, LTD, and as such, I am authorized to execute and deliver this certificate on behalf of BNI Coal, LTD.

I further certify, swear and affirm, under oath and in writing that the compliance information attached dated April 12, 2023 and which is submitted as part of BNI Coal, LTD's Revision 8 to Permit BNCR-1101 is accurate and complete in accordance with North Dakota Administrative Code Chapter 69-05.2-06.

IN WITNESS WHEREOF, I have hereunto set my hand on this 12th day of April, 2023.



\_\_\_\_\_  
Michael Heger  
General Manager of BNI Coal, LTD

STATE OF NORTH DAKOTA

COUNTY OF BURLEIGH

Subscribed and sworn to before me this 12th day of April, 2023

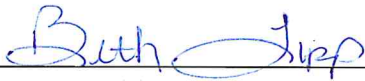

\_\_\_\_\_  
Notary Public

[Seal]

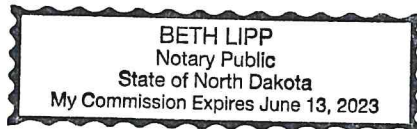

## Ownership and Control Update – April 12, 2023

### Revision 8

### BNCR-1101

Changes are highlighted in yellow

#### 1.7.2 CONTROLLING OFFICERS OF BNI COAL, LTD., BNI ENERGY, INC. AND ALLETE

Controlling Officers of BNI Coal, Ltd., BNI Energy, Inc. and ALLETE are shown below. Social security numbers are not provided since this is voluntary information.

##### Controlling Officers of BNI Coal, Ltd.

Name	Position	Effctv. Date	End Date	Address	Phone No.
Bethany M Owen	Board Chairman	10-21		30 W. Superior Duluth, MN 55802	218-722-2641
Patrick L. Cutshall	President	10-21		30 W. Superior	218-722-2641
	Treasurer	10-21		Duluth, MN 55802	
Michael Heger	General Mgr.	06-21		PO Box 897 Bismarck, ND 58502	701-222-8828
Margaret A. Thickens	Secretary	10-19		30 W. Superior Duluth, MN 55802	218-722-2641
Ingrid Johnson	Asst. Corp. Secretary	04-22		30 W. Superior Duluth, MN 55802	218-722-2641
Violet Struss	Asst. Corp. Secretary	04-16	04-22		
Alan R. Hodnik	Chairman	10-19	05-21		
	Board Chairman & CEO	05-10	04-14		
Wade Boeshans	President &	10-14	07-21		
	General Mgr.	11-09	07-21		
	Treasurer	10-19	07-21		
Bethany M. Owen	Corp. Secretary	05-17	10-19		
Bradley W. Oachs	Board Chairman & CEO	10-14	06-19		
Sam E. McQuade	CFO, Treasurer, Asst.	10-16	06-19		
	Corp. Secretary				
Deborah A. Amberg	Corp. Secretary	09-04	05-17		
Patricia E. Clement	Mgr. Fin. & Acct.	09-01	09-16		
	Treasurer, Asst. Corp.	04-82	09-16		
	Secretary & Resident Agnt				
Donald J. Shippar	Brd Chrnm & CEO	05-03	04-10		
Robert D. Edwards	Brd. Chrnm & CEO	04-96	05-03		
Chas. M. Reichert	Pres. & Gnrl. Mgr.	01-89	08-01		
M. J. Hummel	Pres. & Gnrl Mgr.	08-01	11-09		
	VP of Fin & CFO	08-86	08-01		
P. R. Halverson	Secretary	01-89	09-04		

##### Board of Directors of BNI Coal, Ltd.

Name	Position	Effctv. Date	End Date	Address	Phone No.
Bethany M. Owen	Chairman	10-21		30 W. Superior	218-722-2641
	Director	05-17	10-21	Duluth, MN 55802	
Michael M. Heger	Director	10-21		PO Box 897 Bismarck, ND 58502	701-222-8828
Robert N. MacLennan	Director	05-11		PO Box 13200 Grand Forks, ND 58208	701-795-4000

Name	Position	Effctv. Date	End Date	Address	Phone No.
Patrick L. Cutshall	Director	05-17		30 W. Superior Duluth, MN 55802	218-722-2641
Margaret A. Thickens	Director	10-19		30 W. Superior Duluth, MN 55802	218-722-2641
Allan S. Rudeck, Jr.	Director	10-19		30 W. Superior Duluth, MN 55802	218-722-2641
Steven W. Morris	Director	10-22		30 W. Superior Duluth, MN 55802	218-722-2641
Robert J. Adams	Director	09-01	06-22		
Alan R. Hodnik	Chairman	10-19	05-21		
	Director	04-14	05-21		
	Chairman & BNI CEO	05-10	04-14		
	Director	06-07	04-10		
Wade Boeshans	Director	11-09	07-21		
Bradley W. Oachs	Chairman & BNI CEO	04-14	06-19		
	Director	05-10	04-14		
Deborah A. Amberg	Director	04-16	05-17		
Steven Q. DeVinck	Director	04-16	05-17		
David Loer	Director	01-91	11-10		
Donald J. Shippar	Chrmn & BNI Co.	05-03	04-10		
	Officer Member	04-96	05-03		
Robert D. Edwards	Chrmn & BNI Co.	04-96	05-03		
	Officer				
Charles. M. Reichert	Member & BNI Co.	01-89	08-01		
	Officer				
M. J. Hummel	Member & BNI Co.	09-01	11-09		
	Officer				
Warren Candy	Director	09-02	06-07		
David G. Gartzke	Member	04-96	08-01		
Steve Sherner	Director	04-91	01-96		
	Member	01-96	04-98		
	Vice Chair	04-98	09-01		
	Director	09-01	08-02		

### Controlling Officers of BNI Energy, Inc.

Name	Position	Effctv. Date	End Date	Address	Phone No.
Bethany M. Owen	Chairman	10-21		30 W. Superior Duluth, MN 55802	218-722-2641
Patrick L Cutshall	President	10-21		30 W. Superior Duluth, MN 55802	218-722-2641
	Treasurer	10-21		Duluth, MN 55802	
Michael Heger	General Mgr.	06-21		PO Box 897 Bismarck, ND 58502	701-222-8828
Margaret A. Thickens	Secretary	10-19		30 W. Superior Duluth, MN 55802	218-722-2641
Ingrid Johnson	Asst. Corp. Secretary	04-22		30 W. Superior Duluth, MN 55802	218-722-2641
Violet Struss	Asst. Corp Secretary	04-16	04-22		
Alan R. Hodnik	Chairman	10-19	05-21		
	CEO	04-16	05-21		
	Brd Chairman/CEO	02-16	04-16		
Wade Boeshans	President & General Mgr.	02-16	07-21		
	Treasurer	10-19	07-21		
Bethany M. Owen	Corp. Secretary	05-17	10-19		

Bradley W. Oachs	Chairman	04-16	06-19		
Sam E. McQuade	CFO, Treasurer, Asst. Corp. Secretary	10-16	06-19		
Deborah A. Amberg	Corp. Secretary	02-16	05-17		
Patricia E. Clement	Treasurer, Asst. Corp. Secretary	02-16	09-16		

### Board of Directors of BNI Energy, Inc.

Name	Position	Effctv . Date	End Date	Address	Phone No.
Bethany M. Owen	Chairman	10-21		30 W. Superior	218-722-2641
	Director	05-17	10-21	Duluth, MN 55802	
Michael M. Heger	Director	10-21		PO Box 897 Bismarck, ND 58502	701-222-8828
Robert N. MacLennan	Director	02-16		PO Box 13200 Grand Forks, ND 58208	701-795-4000
Patrick L. Cutshall	Director	05-17		30 W. Superior Duluth, MN 55802	218-722-2641
Margaret A. Thickens	Director	10-19		30 W. Superior Duluth, MN 55802	218-722-2641
Allan S. Rudeck, Jr.	Director	10-19		30 W. Superior Duluth, MN 55802	218-722-2641
Steven W. Morris	Director	10-22		30 W. Superior Duluth, MN 55802	218-722-2641
Robert J. Adams	Director	02-16	06-22		
Alan R. Hodnik	Chairman	10-19	05-21		
	Director/CEO	02-16	10-19		
Wade Boeshans	Director/Pres/GM	02-16	07-21		
Bradley W. Oachs	Chairman	02-16	06-19		
Deborah A. Amberg	Director	04-16	05-17		
Steven Q. DeVinck	Director	04-16	05-17		

### Corporate Officers of ALLETE

Name	Position	Effctv Date	End Date	Address	Phone No.
Bethany M. Owen	CEO	02-20		30 W. Superior	218-722-2641
	President	01-19		Duluth, MN 55802	
	SVP & Secrtry, Chief Legal & Admin Officer	11-16	02-19		
T. P. Giblin, Jr.	Asst. Secretary	05-03		30 W. Superior Duluth, MN 55802	218-722-2641
Steven W. Morris	SVP, CFO	02-22		30 W. Superior	218-722-2641
	VP, Controller & Chief Accting Officer	12-16	02-22	Duluth, MN 55802	
				30 W. Superior	218-722-2641
Patrick L. Cutshall	VP, Corp. Treasurer	12-17		Duluth, MN 55802	
	Treasurer	01-16			
Nicole R. Johnson	Pres-ALLETE Clean Energy	08-22		30 W. Superior Duluth, MN 55802	218-722-2641
	VP-ALLETE	07-19			
	Chief Admin Officer	07-19	08-22		
	VP-Human Resources	08-16	07-19		
Margaret A. Thickens	VP, Chief Legal Officer & Corp. Secretary	02-19		30 W. Superior Duluth, MN 55802	218-722-2641
Josh Skelton	VP-ALLETE	08-22		30 W. Superior	218-722-2641

Name	Position	Effctv Date	End Date	Address	Phone No.
	COO-MP	11-20		Duluth, MN 55802	
Robert J. Adams	SVP, CFO	03-17	06-22		
	SVP-Energy Centric Bus. & CRO	11-15	03-17		
	VP-Energy Centric Bus. & CRO	06-14	11-15		
	VP-Bus. Dev. & CRO	05-08	06-14		
	VP-Util. Bus. Dev.	02-04	05-08		
	VP & CFO-MP Fin. & Bus. Dev.	01-02	01-04		
Alan R. Hodnik	Exec. Chairman	02-20	05-21		
	Chairman/CEO	05-10	02-20		
	President	05-09	01-19		
	COO-MP	06-07	05-09		
Bradley W. Oachs	SVP & Pres-Regltd Ops	11-16	06-19		
Patrick K. Mullen	SVP-External Affairs	04-17	06-19		
Deborah A. Amberg	SVP, Chief Strategy Officer-Regultd Ops	11-16	12-18		
	SVP, Genl Cncl & Secretary	05-06	11-16		
	VP, Genl Cncl & Secretary	03-04	05-06		
David J. McMillan	Secretary	04-17	02-18		
	SVP	05-12	04-17		
	SVP-External Affairs	01-06	05-12		
	SVP-Mrktng, Regltry & Publ. Affairs	10-03	05-06		
	SVP-Mrktng & Publ.	01-02	01-03		
	SVP-MP Strat. Accts & Govt. Affairs	05-01	12-01		
	VP-MP Strat. Accts & Mrktng	01-98	05-01		
	VP-MP Elec Cstmr Solutions	07-14	05-17		
Steven Q. DeVinck	SVP	07-14	03-17		
	CFO	03-14	07-14		
	CFO & SVP-Bus. Support Controller & VP-Bus. Support	12-09	03-14		
	Support Controller	07-06	12-09		
Donald W. Stellmaker	VP & Corp Treasurer	08-11	12-15		
	Treasurer	07-04	08-11		
Timothy J. Thorp	VP-Inv Relations & Support Services	05-14	12-15		
	VP-Inv. Relations	05-05	05-14		
	VP-Inv. Relations & Corp. Comm.	11-01	05-05		
Bonnie A. Keppers	VP-ALLETE HR	04-11	03-15		
Eric R. Norberg	SVP-MP Strtgy & Planning	02-07	07-11		
	VP-MP Strategic Initiatives	04-02	01-07		
	VP-MP; COO-MPEX	05-01	03-02		
	VP-MP Elec Strtgc Accts.	01-88	05-01		
Mark A. Schober	SVP	03-14	06-14		
	SVP & CFO	07-06	03-14		
	SVP, CFO & Cntrlr	07-06	07-06		
	SVP-Acct/Tax & Audit, Controller	02-04	06-06		
	VP & Controller	04-01	01-04		
	Controller	05-97	04-01		

Name	Position	Effctv Date	End Date	Address	Phone No.
Donald J. Shippar	Corp. Controller	03-93	05-97		
	Chairman	05-09	05-11		
	Chairman & CEO	05-09	04-10		
	Chrmn, Pres. & CEO	01-04	05-09		
	Pres. & CEO	01-04	12-05		
	EVP-MP; Pres.-MP	05-03	01-04		
	Pres. & COO-MP	05-01	05-03		
	COO-MP Elec.	01-00	05-01		
Ronald G. Porter	Sr. VP-MP Cust Serv & Delvry	01-98	12-99		
	VP-Trans. & Dstrbtn	05-97	12-97		
Warren L. Candy	VP-ALLETE HR	09-07	07-10		
John Cirello	SVP-Util. Ops.	02-04	07-05		
	VP-MP Gen. Ops	09-00	01-04		
	VP-MP Elec. Gen Ops	05-97	08-00		
	VP-Boswell	05-94	05-97		
Donnie R. Crandell	EVP, Pres & CEO-AWS	05-01	08-01		
	EVP, Pres & CEO-MP	05-99	05-01		
	Water Resources				
	EVP, Pres & CEO- FWS	05-98	05-99		
	EVP, Pres & CEO Sthrn States Util.	05-96	05-98		
Lawrence N. Engel	EVP-MP	07-95	05-96		
	EVP, Pres & CEO-FWS: Pres-AWS	05-02	07-03		
	EVP, Pres & CEO-ALLETE Properties	09-00	05-02		
	EVP & Pres-MP Real Estate Holdings	01-99	08-00		
	SVP & Pres-MP Real Estate Holdings	08-95	01-99		
	SVP-Corp. Dev.	11-94	08-95		
	VP-Corp. Dev.	03-93	11-94		
Roger P. Engle	Asst. Controller	06-86	05-92		
Raymond G. Erickson	VP	05-06	12-08		
	VP-MP; Pres SWL&P	05-97	05-06		
	VP-MP, Pres & COO-SWL&P	01-96	05-97		
	VP-Custmr Relations	05-95	12-95		
	VP & GM-Cntrl Div. Controller	05-93	05-95		
Thomas E. Ferguson	VP-Public Affairs	05-84	05-93		
Brenda J. Flayton	VP-MP Pwr, Dlvry & Transmission	06-84	12-90		
	VP-MP	02-00	12-03		
John E. Fuller	VP-HR	07-98	05-04		
Laurence H. Fuller	EVP-MP; Pres & CEO-Auto Fin. Corp	01-99	09-01		
	SVP-MP; Pres & CEO-Auto Fin. Corp	04-97	01-99		
	VP-Corp. Dev.	01-97	08-01		
Bruce E. Gangnon	VP-Corp. Dev.	01-97	08-01		
David G. Gartzke	Asst. Corp Controller	05-92	05-95		
	Chrmn, Pres & CEO	01-02	05-04		
	President	08-01	12-01		
	SVP-Finance & CFO	12-94	08-01		
	VP-Finance & CFO	03-93	11-94		
James P. Hallet	VP & Treasurer	05-89	02-93		
	EVP; Pres-Adesa	05-03	05-04		

Name	Position	Effctv Date	End Date	Address	Phone No.
	EVP; Chrmn, Pres & CEO-ALLETE Auto	05-02	05-03		
	EVP-MP; Pres & CEO-Adesa	04-97	05-02		
Philip R. Halverson	VP, Gen'l Cns'l & Secr.	01-96	05-04		
	Gen'l Cns'l & Secr.	03-93	12-95		
	Gen'l Cns'l & Asst. Secr.	01-91	02-93		
	Asst. Gen'l Cns'l & Secr.	05-89	01-91		
Allen D. Harmon	Group VP-Elec. Util Ops	05-91	06-95		
	Group VP-Cust. Serv	01-89	05-91		
Dennis L Hollingsworth	Asst. VP-Corp Dev.	02-93	12-96		
	Asst. VP-Cash Mgmt	05-91	01-93		
	Asst. VP-Cash & Portfolio Mgmt	05-88	05-91		
Michael J. Hummel	VP-MP; Pres & GM-BNI Coal	05-02	05-03		
David P. Jeronimus	VP-ALLETE; SVP-MP Envr. Serv.	05-02	09-04		
	VP-MP Envr. Serv.	05-99	05-02		
Sean S. Macpherson	Asst. Secretary	01-89	05-03		
Jack R. McDonald	EVP-Fin & Corp Dev	05-93	12-95		
	Grp VP-Corp Dev.	05-91	05-93		
	Grp VP-Pwr Systms	05-90	05-91		
	Grp VP-Topeka	05-88	05-90		
Eugene G. McGillis	VP-MP; Pres-SWL&P	06-92	12-94		
	VP-Cust Ops.	04-88	05-92		
Thomas A. Micheletti	Grp VP-Core Support Ops & Secretary	05-91	03-93		
	Grp VP-Gen'l Cns'l & Secretary	05-88	05-91		
Patrick K. Mullen	VP-ALLETE HR	05-05	02-07		
	VP-MP Dist Ops & Cust Serv	09-00	04-05		
	VP-MP Elec	02-00	08-00		
Bert T. Phillips	Grp VP-Water Res. Ops	05-91	08-95		
	Grp VP-Topeka	02-90	05-91		
	Grp VP-Pwr Systms	05-88	01-90		
Charles M. Reichert	VP-MP; Pres & GM-BNI Coal	09-00	08-01		
	VP-MP; Pres-BNI Coal	07-93	08-00		
Kevin G. Robb	VP-Gnrtn; Pres-RREC	08-94	01-97		
	VP-MP; Pres-RREC	05-93	08-94		
James A. Roberts	VP-MP Publ Affairs	05-02	07-03		
	VP-Corp Relations	05-96	05-02		
Jack F. Rowe	Chrmn & CEO	07-79	05-89		
Edwin L. Russell	Chrmn, Pres & CEO	05-96	08-01		
	Pres & CEO	01-96	05-96		
	President	05-95	01-96		
Arend J. Sandbulte	Chairman & CEO	05-95	05-96		
	Chrmn, Pres & CEO	05-89	05-95		
	Pres & CEO	05-88	05-89		
Stephen D. Shermer	SVP-MP Strtgc Initiative	05-02	08-02		
	SVP-MP Energy Srcing	01-98	05-02		
	SVP-MP Elec Strtgy & Growth	01-97	12-97		
	VP-Mrktng & Cust Serv.	01-96	12-96		
	VP-Pwr Mrktng & Del	05-95	12-95		

Name	Position	Effctv Date	End Date	Address	Phone No.
Steven W. Tyacke	VP-Pwr Srcing & Del	05-93	05-95		
	VP-Strtgc Res Mgmt	05-91	05-93		
	VP-Syst Ops & Plnng	05-88	05-91		
Geraldine R. Vantassel	Asst. Gen'l Counsel	07-93	06-04		
James K. Vizanko	VP-Corp Info Systms	06-95	12-96		
	VP-Corp res Plnng	03-93	05-95		
	Corp Controller	05-92	02-93		
	SVP-Fin & CFO	07-04	06-06		
Claudia R-S. Welty	SVP, CFO & Treasrer	01-04	07-04		
	VP, CFO & Treasrer	05-02	01-04		
	VP & Treasurer	04-01	05-02		
	Treasurer	03-93	04-01		
	SVP-Spprt/Chief Admin Officer	02-04	12-09		
	VP-Strtgy & Tech Dev	05-03	01-04		
	VP-IT	05-99	05-03		
	SP-Supprt Serv.	05-97	05-99		

### Board of Directors of ALLETE

Name	Position	Effctv . Date	End Date	Address	Phone No.
Bethany M. Owen	Chairman	08-21		30 W. Superior	218-722-2641
	Director	02-19	08-21	Duluth, MN 55802	
Charles R. Matthews	Director	07-22		30 W. Superior	218-722-2641
				Duluth, MN 55802	
James J. Hoolihan	Director	05-06		30 W. Superior	218-722-2641
				Duluth, MN 55802	
Madeleine W. Ludlow	Director	10-04		30 W. Superior	218-722-2641
				Duluth, MN 55802	
Douglas C. Neve	Director	07-07		30 W. Superior	218-722-2641
				Duluth, MN 55802	
George G. Goldfarb	Director	10-12		30 W. Superior	218-722-2641
				Duluth, MN 55802	
Susan K. Nestegard	Director	01-18		30 W. Superior	218-772-2641
				Duluth, MN 55802	
Robert P. Powers	Director	08-17		30 W. Superior	218-772-2641
				Duluth, MN 55802	
Charlene A. Thomas	Director	10-21		30 W. Superior	218-772-2641
				Duluth, MN 55802	
Barbara A. Nick	Director	07-20		30 W. Superior	218-772-2641
				Duluth, MN 55802	
Kathryn W. Dindo	Director	07-09	05-22		
Heidi J. Jimmerson	Director	09-04	05-22		
Alan R. Hodnik	Chairman	05-11	05-21		
	Director	05-09	05-21		
James S. Haines Jr.	Director	10-09	05-19		
Leonard C. Rodman	Director	05-09	05-19		
Sidney W. Emery Jr.	Director	05-07	05-19		
Bruce W. Stender	Director	01-06	05-14		
	Chairman	09-04	12-05		
	Director	05-95	07-04		
Kathleen A. Brekken	Director	07-06	05-13		
		05-97	05-03		
Donald J. Shippar	Chairman	01-06	05-11		
	Director	09-04	12-05		
George L. Mayer	Director	05-96	05-10		

Name	Position	Effectv . Date	End Date	Address	Phone No.
Jack I. Rajala	Director	05-85	05-10		
Wynn V. Bussmann	Director	05-02	09-04		
Wesley C. Cochrane	Director	05-84	05-89		
Merrill K. Cragun	Director	05-91	05-01		
Thomas L. Cunningham	Director	05-03	05-04		
Charles M. Denny, Jr.	Director	05-85	05-90		
Dennis E. Evans	Director	05-86	03-04		
Orlando G. Fladmark	Director	05-85	05-94		
David G. Gartzke	Chairman	04-02	09-04		
	Director	08-01	04-02		
Dennis O. Green	Director	06-03	09-04		
Clifford H. Grindy	Director	05-86	05-93		
D. Michael Hockett	Director	07-95	08-96		
Sister Kathleen Hofer	Director	05-94	05-96		
Glenda Hood	Director	05-00	01-03		
Peter J. Johnson	Director	05-94	05-07		
Mary Junck	Director	07-92	05-95		
Jack R. Kelly, Jr.	Director	01-96	09-96		
John H. Lemme	Director	05-66	05-91		
Robert S. Mars, Jr.	Director	05-70	05-95		
Paula F. McQueen	Director	05-93	12-98		
Robert S. Nickloff	Director	05-86	05-98		
Roger D. Pierce	Director	05-04	05-08		
Jack F. Rowe	Director	05-89	05-93		
	Chairman	07-79	05-89		
	Director	05-69	07-79		
Charles A. Russell	Director	05-85	05-96		
Edwin L. Russell	Chairman	05-96	08-01		
	Director	05-95	05-96		
Mary E. Ryland	Director	05-82	05-94		
Arend J. Sandbulte	NonExec. Chrmn	08-01	04-02		
	Director	05-96	08-01		
	Chairman	05-89	05-96		
	Director	05-83	05-89		
Nick Smith	Director	05-95	05-07		
D. C. Wegmiller	Director	05-92	09-04		
Deborah L. Weinstein	Director	06-03	09-04		

### ORGANIZATION of BNI Coal, LTD

Bethany Owen	Chairman of the Board of Directors
Patrick Cutshall	President & Treasurer
Michael Heger	General Manager
Margaret Thickens	Secretary
Ingrid Johnson	Assistant Secretary
Doug Sheetz	Manager of Health, Safety & Environmental Services
Jonathan Rudnick	Manager of Engineering
Ryan Wrolstad	Manager of Finance and Accounting

Cheryl Froehlich	Director of Human Resources
Eric Olafson	Manager of Operations

CORPORATE OFFICERS: Bethany Owen, Patrick Cutshall, Margaret Thickers and Ingrid Johnson

### 1.13 PAST VIOLATIONS

On May 25, 2022 BNI was issued Notice of Violation 2202 for removing approximately 275,000 cubic yards of overburden from the federal coal tract in the NE ¼ of Section 20, T142N R84W. On May 10, 2022, BNI was observed by ND PSC removing pre-bench overburden material in the NE1/4 of Section 20. Overburden from about 8 acres was removed to an average depth of 20 feet. BNI violated the special condition added to Permit BNCR-9702 with Revision 42 that prohibits overburden and coal removal until mine plan approval is received from the US Department of the Interior. Until the mine plan is approved by the DOI, surface disturbances on the federal tracts are limited to activities that the ND PSC determines are necessary for mining adjoining tracts that BNI has a right to mine. During an inspection by ND PSC on May 16, 2022, BNI was informed that overburden removal operations could not be conducted in Section 20 over Federal coal. BNI ceased the overburden removal operation immediately. On May 25, 2022, BNI submitted an Overburden Removal Request for the NE ¼ of Section 20 to the ND PSC. On June 24, 2022, ND PSC approved the request to remove the overburden from the federal coal tract in Section 20 and included concurrence letters from BLM dated June 24, 2022 and OSMRE dated June 17, 2022. On July 27, 2022, BNI was assessed a fine of \$5,000. The NOV was terminated on July 20, 2022.

There are no other violations or orders by any person who owns or controls BNI Coal or ALLETE.

**Township 141 North, Range 83W**  
**Section 7: W1/2**

**Surface Ownership**

**Janet Dohrmann**

9721 31<sup>st</sup> St SW

Taylor, ND 58656

**Lease Document(s): [Lease No. 5049]**

**Coal Ownership**

BNI Coal, LTD– 100.00%

2360 35<sup>th</sup> Avenue SW, Center, ND 58530

**Right of Entry Document(s): [Lease No. 89470]**

**Easements**

**NONE**

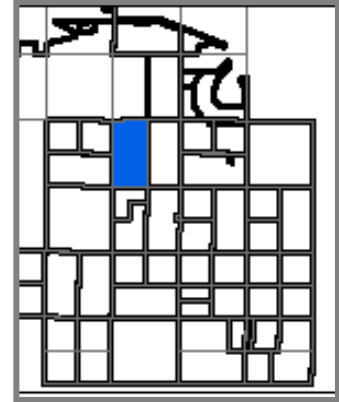

**Township 141 North, Range 83W**  
**Section 16: SW1/4**

**Surface Ownership**

Kasper Kraft LE – 100.00%  
2847 35<sup>th</sup> Ave  
New Salem, ND 58563

**Lease Document(s): [Lease No. 5053]**

**Remaindermen:**

Kasper Kraft, Jr.  
305 9<sup>th</sup> Street NW  
Mandan, ND 58554

Steve Kraft  
2847 35<sup>th</sup> Avenue SW  
New Salem, ND 58563

Susan Henke  
4235 20<sup>th</sup> Street SW  
Stanton, ND 58571

Allen Kraft  
6155 12<sup>th</sup> Street SE  
Bismarck, ND 58504

Robin Schimke  
9115 Paige Drive  
Bismarck, ND 58503

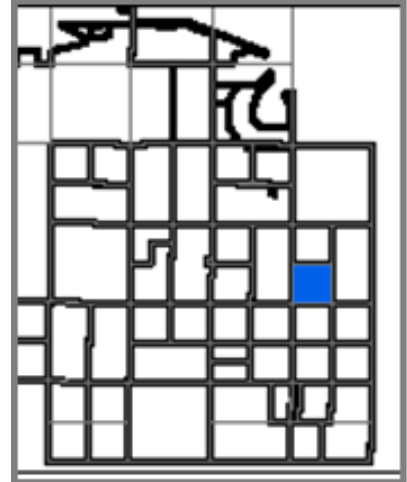

**Coal Ownership**

State of ND – 100.00%  
1707 North 9<sup>th</sup> St  
PO Box 5523  
Bismarck, ND 58506

**Right of Entry Document(s): [Lease No. 4068]**

**Easements**

- 1970 County Road Easement- SW1/4 of the section. Contains approximately 2.49 acres. (Peter Kraft & Oliver County) [16- 01]

**Township 141 North, Range 83W**  
**Section 18: NE1/4NW1/4, Lots 1 and 2**

**Surface Ownership**

**Janet Dohrmann**

9721 31<sup>st</sup> St SW

Taylor, ND 58656

**Lease Document(s): [Lease No. 5049]**

**Coal Ownership**

Opp **Family Mineral Trust** – 50.00%

**Janet Dohrmann & Jamie Fast**

9721 31<sup>st</sup> St SW

Taylor, ND 58656

**Right of Entry Document(s): [Lease No. 5049]**

State of ND – 50.00%

1707 North 9<sup>th</sup> St

P.O. Box 5523

Bismarck, ND 58506-5523

**Right of Entry Document(s): [Lease No. 4071]**

**Easements**

- 1949 Right-of-Way Easement (electric transmission line) - NE1/4NW1/4 of the section. (Oscar Witting & Dakotas Electric Coop. Inc.) [18- 01]
- 1952 Electric Transmission and Telephone Line Easement- NE1/4NW1/4 of the section. (State of North Dakota & Dakotas Electric Coop. Inc. .) [18- 02]

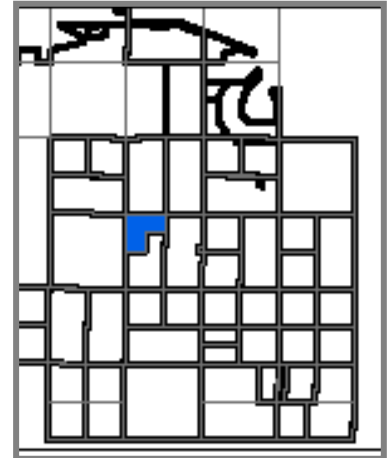

**Township 141 North, Range 84W  
Section 13 N1/2N1/2**

**Surface Ownership**

BNI Coal, Ltd. – 100.00%  
PO Box 897  
1637 Burnt Boat Rd  
Bismarck, ND 58502

**Lease Document(s): [Lease No. 7031][Warranty Deed 95180]**

**Coal Ownership**

Margaret Erhardt – 25.00%  
3685 27<sup>th</sup> St. SW  
New Salem, ND 58563

**Right of Entry Document(s): [Lease No. 7031]**

Kathryn Erhardt – 25.00%  
PO Box 132  
Center, ND 58530

**Right of Entry Document(s): [Lease No. 1029]**

Evangeline Bolton – 5.56%  
1951 Carbon Ridge St.  
Enumclaw, WA 98022

**Right of Entry Document(s): [Lease No. 1047]**

Lorraine Bosch – 5.56%  
929 2<sup>nd</sup> Street W  
Dickinson, ND 58601

**Right of Entry Document(s): [Lease No. 1049]**

Rosemarie Erhardt LE  
3105 85M Avenue SW  
Richardton, ND 58652

**Right of Entry Document(s): [Lease No. 1044][Lease No. 1050]**

**Remaindermen:**

Scott Erhardt  
3101 85M Avenue SW  
Richardton, ND 58657

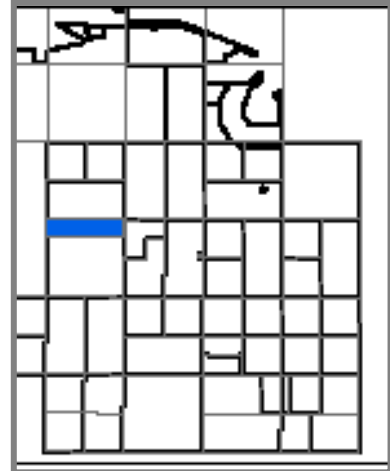

Laura Kordonowy  
2329 Main Street  
Dickinson, ND 58601

Marcus C. Erhardt Life Estate  
332 Wehrle Drive  
Richardton, ND 58652

**Right of Entry Document(s): [Lease No. 1046]**

**Remainderman:**

Perry Erhardt  
369 Honeysuckle Lane  
Temple, GA 30179

Gregory Forster – 1.11%  
338 1<sup>st</sup> Street SW  
Dickinson, ND 58601

**Right of Entry Document(s): [Lease No. 1045]**

George and Judith Pavlicek LE  
597 13<sup>th</sup> Street East  
Dickinson, ND 58601

**Right of Entry Document(s): [Lease No. 1045]**

**Remainderman:**

Lori Bloom  
9380 36<sup>th</sup> Street SW  
Taylor, ND 58656

Stephen Forster  
433 13<sup>th</sup> Street East  
Dickinson, ND 58601

**Right of Entry Document(s): [Lease No. 1045]**

Dorothy Wurm  
413 3<sup>rd</sup> Street South  
Breckenridge, MN 56520

**Right of Entry Document(s): [Lease No. 1045]**

Edward Forster  
10880 35<sup>th</sup> Street SW  
Dickinson, ND 58601

**Right of Entry Document(s): [Lease No. 1045]**

**Township 141 North, Range 84W  
Section 13: A two acre square in the NW Corner  
of the NW1/4**

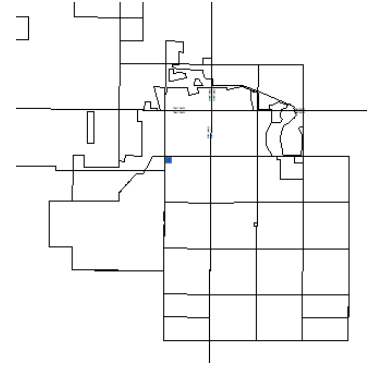

**Surface Ownership**

Mark Erhardt. – 100.00%  
**PO Box 132  
Center, ND 58530**

**Lease Document(s): [Lease No. 7031][Warranty Deed 93140]**

**Coal Ownership**

Margaret Erhardt – 25.00%  
3685 27<sup>th</sup> St. SW  
New Salem, ND 58563

**Right of Entry Document(s): [Lease No. 7031]**

Kathryn Erhardt – 25.00%  
PO Box 132  
Center, ND 58530

**Right of Entry Document(s): [Lease No. 1029]**

Evangeline Bolton – 5.56%  
1951 Carbon Ridge St.  
Enumclaw, WA 98022

**Right of Entry Document(s): [Lease No. 1047]**

Lorraine Bosch – 5.56%  
929 2<sup>nd</sup> Street W  
Dickinson, ND 58601

**Right of Entry Document(s): [Lease No. 1049]**

Rosemarie Erhardt LE  
3105 85M Avenue SW  
Richardton, ND 58652

**Right of Entry Document(s): [Lease No. 1044][Lease No. 1050]**

**Remaindermen:**

Scott Erhardt  
3101 85M Avenue SW  
Richardton, ND 58657

Laura Kordonowy  
2329 Main Street  
Dickinson, ND 58601

Marcus C. Erhardt Life Estate  
332 Wehrle Drive  
Richardton, ND 58652

**Right of Entry Document(s): [Lease No. 1046]**

**Remainderman:**

Perry Erhardt  
369 Honeysuckle Lane  
Temple, GA 30179

Gregory Forster  
338 1<sup>st</sup> Street SW  
Dickinson, ND 58601

**Right of Entry Document(s): [Lease No. 1045]**

George and Judith Pavlicek LE  
597 13<sup>th</sup> Street East  
Dickinson, ND 58601

**Right of Entry Document(s): [Lease No. 1045]**

**Remainderman:**

Lori Bloom  
9380 36<sup>th</sup> Street SW  
Taylor, ND 58656

Stephen Forster  
433 13<sup>th</sup> Street East  
Dickinson, ND 58601

**Right of Entry Document(s): [Lease No. 1045]**

Dorothy Wurm  
413 3<sup>rd</sup> Street South  
Breckenridge, MN 56520

**Right of Entry Document(s): [Lease No. 1045]**

Edward Forster  
10880 35<sup>th</sup> Street SW  
Dickinson, ND 58601

**Right of Entry Document(s): [Lease No. 1045]**

Alice Christianson  
830 2<sup>nd</sup> Ave East Apt. 203  
Dickinson, ND 58601

**Right of Entry Document(s): [Lease No. 1051]**

Ann Pasley  
13838 162 Avenue NE  
Woodinville, WA 98072

**Right of Entry Document(s): [Lease No. 1048]**

Agnes Phagan  
c/o Jay & Ken Phagan  
402 Mathis Street  
Taft, TX 78390

**Easements**

- 1980 County Road Easement- NW1/4 of the section. Contains approximately 0.07 acres. (Max Erhardt & Oliver County) [13-01]
- 1980 County Road Easement- NW1/4 of the section. Contains approximately 0.17 acres (Max Erhardt & Oliver County) [13-03]
- 1949 Right-of-Way Easement (Electric Transmission line) - N1/2 of the section. (Kaspar and Anna Erhardt & Dakotas Electric Coop. Inc.) [13-05]