

The Beacon

324 2nd Ave NE, Beulah ND 58523 · 701-873-4381 · centralnordak.com

	Invoice Number	Invoice Date
	343493	6/30/2021
Advertiser No.	Amount Due	Due Date
16734	\$1,706.00	7/30/2021

Dakota Westmoreland-Beulah
 Attn: Scott Aberle
 Po Box 39
 Beulah ND 58523

A finance charge of 1.5% will be applied to any account where payment is not received by the 25th.

Amount Enclosed

Please detach top portion and return with your payment.

INVOICE

The Beacon		Dakota Westmoreland-Beulah			Invoice No. 343493		6/30/2021	
Date	Order	Description	Ad Size	SubTotal	Sales Tax	Amount		
6/3/2021	136975 BB	Legals: Legals: Notice of Applicaiton Surface Mine	1 Lines			\$0.00		
6/10/2021	136975 BB	Legals: Legals: Notice of Applicaiton Surface Mine	1 Lines			\$0.00		
6/17/2021	136975 BB	Legals: Legals: Notice of Applicaiton Surface Mine	1 Lines			\$1,706.00		
					Sub Total:	\$1,706.00		
					Total Transactions: 3	Total:	\$1,706.00	

SUMMARY Advertiser No. 16734 Invoice No. 343493 Invoice Amount \$1,706.00

A finance charge of 1.5% will be applied to any account where payment is not received by the 25th.

Thank You!

A fee of 1.5% will be imposed on all balances that are past due.
 Please make checks payable to:

Beulah Beacon
 324 2nd Ave NE
 Beulah, ND 58523

Thank you for advertising with our paper!

Affidavit of Publication

STATE OF NORTH DAKOTA,
COUNTY OF MERCER, ss.

I, Lori Cox, being first duly sworn, on oath says, that she is the bookkeeper of the THE BEACON, a weekly newspaper published in Beulah, County of Mercer, and has full and personal knowledge of all the facts herein stated; that said newspaper is a legal newspaper and has a bona fide circulation of at least two hundred copies weekly, and has been published within said county for fifty-two successive weeks next prior to the publication of the notice herein mentioned; that the

Notice of Application Surface Mine KRSB-8603

Dakota Westmoreland-Beulah

a printed copy of which, taken from the paper in which same was published, is attached to this sheet, and is made a part of this Affidavit, was published in said newspaper at least once each week for 4 successive week, on the day of each week on which said newspaper was regularly published to-wit:

10 - Beacon: 5/27/2021, 6/3/2021, 6/10/2021,
6/17/2021

That the full amount of the fees for
the publication of the annexed notice is: \$ 1706.00

Lori Cox

Subscribed and sworn to before me this 6/23/2021

Arden Nelson
Arden Nelson, Notary Public
State of South Dakota
My commission expires August 1, 2025

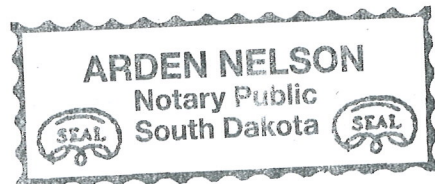

NOTICE OF APPLICATION PERMIT RENEWAL AND REVISION APPLICATION TO A SURFACE MINE PERMIT

Please take notice that Dakota Westmoreland Corporation, PO Box 39, Beulah, North Dakota 58523, has made application to the North Dakota Public Service Commission for Renewal No. 7 and Revision 33 to Surface Coal Mining Permit KR5B-8603.

The permit area is located in all or portions of Sections 14, 15, 16, 17, 18, 19, 20, 21, 22, 23 and 29, T.143N., R.88W., Mercer County, North Dakota. The precise location and boundaries of the permit area are depicted on the accompanying map.

Permit KR5B-8603 encompasses 3,871.7 acres for coal excavation, mining and associated disturbance activities in support thereof. Revision 33 updates the current permit to reflect changes necessary for the next permit term including the legal and financial sections, general operations and reclamation plans. Renewal No. 7 will allow mining and reclamation activities to continue during the next five-year permit term ending August 7, 2026. Revision 33 updates the permit for the permanent cessation of mining in this permit area.

specifically mining of the Iron Pit will cease earlier than previously approved. Other updates to the reclamation plan are also provided in pending Revision 32 to Permit KR5B-8603.

A copy of the applications for revision and renewal of surface coal mining permit is available for public inspection at the offices of the North Dakota Public Service Commission, 600 East Boulevard Ave. Bismarck, ND, 58505-0480 and the Mercer County Auditor, Stanton, ND. A DVD copy of the applications may be requested by contacting the Public Service Commission at (701) 328-2400 or ndpsc@nd.gov or by sending a written request.

Any persons with an interest which is or may be adversely affected may file written comments, objections, or request an informal conference on the permit renewal and revision application with the North Dakota Public Service Commission, 600 East Boulevard, Dept. 408, Bismarck, North Dakota, 58505-0480, within 30 days of the last publication of this notice.

The legal description and names of the apparent surface owners of land included within the permit area are as follows:
T.143N., R.88W., Mercer County

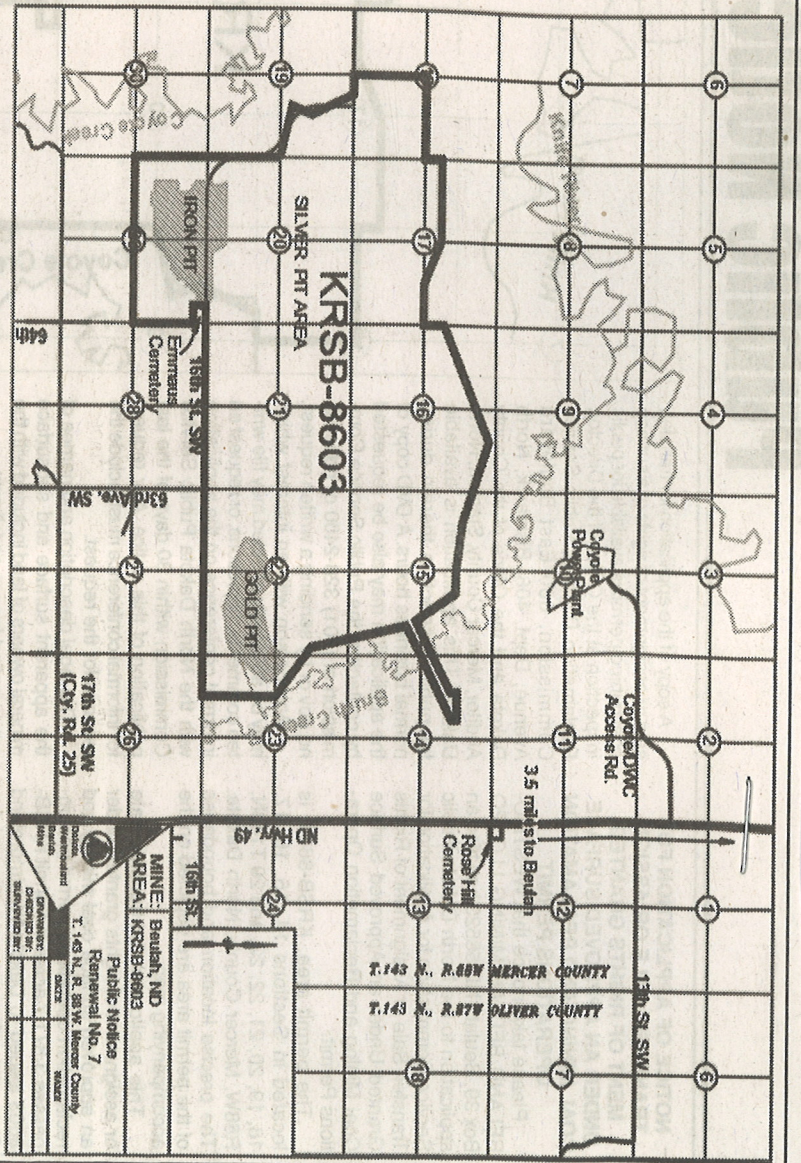

LOCATION

SURFACE OWNER(S)

COAL OWNER(S)

LOCATION

SURFACE OWNER(S)

COAL OWNER(S)

S $\frac{1}{2}$ NW $\frac{1}{4}$, Sec. 14
Other Tail Power Company
Northern Municipal Power Agency
Northwestern Corporation
Montana-Dakota Utilities Co.

United States of America
Gary Murray
Arnon & Peggy J. Wolff
Family Mineral Trust
Phyllis O'Neil
Lydia Stoppier
Daryl E. Zimmerman

NE $\frac{1}{4}$ NE $\frac{1}{4}$
NW $\frac{1}{4}$ NW $\frac{1}{4}$
S $\frac{1}{2}$ N $\frac{1}{2}$
N $\frac{1}{2}$ S $\frac{1}{2}$, Sec. 20

Dakota Westmoreland Corporation
Dakota Westmoreland Corporation
State of North Dakota

United States of America
Dakota Westmoreland Corporation

NW $\frac{1}{4}$, Sec. 15

Other Tail Power Company
Northern Municipal Power Agency
Northwestern Corporation
Montana-Dakota Utilities Co.

Robert A. Keogh
Priscilla Keogh
Faye Keogh Rev. Trust
Claire C. Schwalbe

NE $\frac{1}{4}$ NW $\frac{1}{4}$, Sec. 20
NW $\frac{1}{4}$ NE $\frac{1}{4}$, Sec. 20
N $\frac{1}{2}$, Sec. 21

Dakota Westmoreland Corporation
Dakota Westmoreland Corporation
Ronald & Janice Gunsch
Sharon Winkler
Joan Miller

Dakota Westmoreland Corp.
Dakota Westmoreland Corp.
Ronald Gunsch
Sharon Winkler
Joan Miller

NE $\frac{1}{4}$, Sec. 15

Dakota Westmoreland Corp.
Other Tail Power Company
Northern Municipal Power Agency
Northwestern Corporation
Montana-Dakota Utilities Co.

Robert A. Keogh
Priscilla Keogh
Faye Keogh Rev. Trust
Claire C. Schwalbe

S $\frac{1}{2}$, Sec. 21

Wilfred Fetch
Angelina Braun
Cary Unterseher

Wilfred Fetch
Angelina Braun
Cary Unterseher

S $\frac{1}{2}$, Sec. 15

Faye L. Keogh Revocable Trust

Robert A. Keogh
Priscilla Keogh

NE $\frac{1}{4}$, Sec. 22

Terence Schmidt

United States of America

N $\frac{1}{2}$, Sec. 16

State of North Dakota

State of North Dakota

E $\frac{1}{2}$ SW $\frac{1}{4}$, Sec. 22

Ronald and Janice Gunsch

United States of America

SW $\frac{1}{4}$, Sec. 16

Joan Miller
Sharon Winkler
Faye Keogh

Joan Miller
Sharon Winkler
State of North Dakota

W $\frac{1}{2}$ SW $\frac{1}{4}$, Sec. 22

Ronald and Janice Gunsch

United States of America

SE $\frac{1}{4}$, Sec. 16

Ronald & Janice Gunsch

Ronald Gunsch
Janice Stigman

W $\frac{1}{2}$ SW $\frac{1}{4}$, Sec. 22

Ronald and Janice Gunsch

United States of America

SE 1/4, Sec. 18

Donald & Claire Schwalbe

Donald & Claire Schwalbe
State of North Dakota

Nancy Weigel Jensen
Kathy M. Leber
Kathleen McCrary
Susan McCrary
Cheryl McFadden
David M. Pantermuehl
John Pantermuehl
Roland M. Pantermuehl
Barbara Ann Teed
Eugene Arnold Weigel
Karel M. Weigel
Janice P. Ziegler

NE 1/4, Sec. 19

Casey and Julie Voigt
Casey and Julie Voigt*
Subject to Contract for Deed from:
Shawn and Maria Voigt,
Karmen and Craig Eslinger,
Donalda Voigt, and
Kenneth Voigt

Faye Keogh Rev. Trust
Claire C. Schwalbe
Patience & Calvin Saylor
Casey & Julie Voigt
Karr & Michael Trappen
Karmen & Craig Eslinger
Dean Voigt
Donalda Voigt
Kenneth Voigt
Shawn & Maria Voigt

Lyle & Patricia Winkler

(5-27-21)(6-3-21)(6-10-21)(6-17-21)

NE 1/4, Sec. 29

Lyle & Patricia Winkler

Lyle & Patricia Winkler

PO# 1045064
FIRST INVOICE

Westmoreland Mining LLC
Scott Aberle
PO BOX 39
BEULAH ND 58523

Customer Nbr: 60007152
Phone: (701) 873-3901
Date: 06/15/2021
Page: 1

Amount Paid: _____ Card #: _____ Exp Date: ____/____/____
Check #: _____ Signature: _____



Date: 06/12/2021 Ref #: 28173 Total: 2950.98

Lee Enterprises no longer accepts credit card payments sent via e-mail. Emails containing credit card numbers will be blocked. Please use the coupon above to send credit card payment to the remittance address located in the upper right corner.

Date	Reference #	Type	Description	Lines	Total
06/12/21	28173	INV	Revision No. 7 and Revision No. 33 to Surface Coal Mining Permit KRSB-8603/ Notice of Application PO # Kim Geiss	312	2,950.98

RECEIVED
JUN 17 2021
By _____

Eng Cost
V# 21703
W/O# 1048258
125317.5310
freq# 12431

Remarks: _____ Total Due: 2,950.98

Scott Aberle 6-21-2021

***** Proof of Publication *****

State of North Dakota)
) SS:
 County of Burleigh)

Before me, a Notary Public for the State of North Dakota personally appeared Jill Lindsay who being duly sworn, deposes and says that he (she) is the Clerk of Bismarck Tribune Co., and that the publication(s) were made through the

Bismarck Tribune on the following dates:

5/22, 29, 6/5 + 12/2021

Signed Jill Lindsay

Westmoreland Mining LLC
 Scott Aberle
 PO BOX 39
 BEULAH ND 58523

ORDER NUMBER 28173

Sworn and subscribed to before me this 14th day of

June 20 21

Amy McMahon
 Notary Public in and for the State of North Dakota

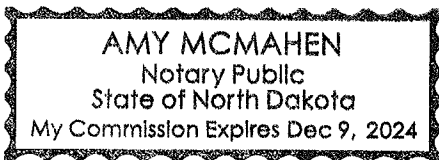

Section: Legals

Category: 5380 Public Notices

PUBLISHED ON: 05/22/2021, 05/29/2021, 06/05/2021, 06/12/2021

TOTAL AD COST: 3139.76

FILED ON: 6/14/2021

**NOTICE OF APPLICATION
 PERMIT RENEWAL AND REVISION APPLICATION TO A SURFACE MINE
 PERMIT**

Please take notice that Dakota Westmoreland Corporation, PO Box 39, Beulah, North Dakota 58523, has made application to the North Dakota Public Service Commission for Renewal No. 7 and Revision 33 to Surface Coal Mining Permit KR5B-8603.

The permit area is located in all or portions of Sections 14, 15, 16, 17, 18, 19, 20, 21, 22, 23 and 29, T.143N., R.88W., Mercer County, North Dakota. The precise location and boundaries of the permit area are depicted on the accompanying map.

Permit KR5B-8603 encompasses 3,871.7 acres for coal excavation, mining and associated disturbance activities in support thereof. Revision 33 updates the current permit to reflect changes necessary for the next permit term including the legal and financial sections, general operations and reclamation plans. Renewal No. 7 will allow mining and reclamation activities to continue during the next five-year permit term ending August 7, 2026. Revision 33 updates the permit for the permanent cessation of mining in this permit area, specifically mining of the Iron Pit will cease earlier than previously approved. Other updates to the reclamation plan are also provided in pending Revision 32 to Permit KR5B-8603.

A copy of the applications for revision and renewal of surface coal mining permit is available for public inspection at the offices of the North Dakota Public Service Commission, 600 East Boulevard Ave. Bismarck, ND, 58505-0480 and the Mercer County Auditor, Stanton, ND. A DVD copy of the applications may be requested by contacting the Public Service Commission at (701) 328-2400 or ndpsc@nd.gov or by sending a written request.

Any persons with an interest which is or may be adversely affected may file written comments, objections, or request an informal conference on the permit renewal and revision application with the North Dakota Public Service Commission, 600 East Boulevard, Dept. 408, Bismarck, North Dakota, 58505-0480, within 30 days of the last publication of this notice.

The legal description and names of the apparent surface owners of land included within the permit area are as follows:

LOCATION	SURFACE OWNER(S)	COAL OWNER(S)
T.143N., R.88W., Mercer County		
S ¹ / ₂ NW ¹ / ₄ , Sec. 14	Otter Tail Power Company Northern Municipal Power Agency Northwestern Corporation Montana-Dakota Utilities Co.	United States of America Gary Murray Armon & Peggy J. Wolff Family Mineral Trust Phyllis O'Neil Lydia Stoppler Daryl E. Zimmerman
NW ¹ / ₄ , Sec. 15	Otter Tail Power Company Northern Municipal Power Agency Northwestern Corporation Montana-Dakota Utilities Co.	Robert A. Keogh Priscilla Keogh Faye Keogh Rev. Trust Claire C. Schwalbe
NE ¹ / ₄ , Sec. 15	Dakota Westmoreland Corp. Otter Tail Power Company Northern Municipal Power Agency Northwestern Corporation Montana-Dakota Utilities Co.	Robert A. Keogh Priscilla Keogh Faye Keogh Rev. Trust Claire C. Schwalbe
S ¹ / ₂ , Sec. 15	Faye L. Keogh Revocable Trust	Robert A. Keogh Priscilla Keogh Faye Keogh Revocable Trust Claire C. Schwalbe
N ¹ / ₂ , Sec. 16	State of North Dakota	State of North Dakota
SW ¹ / ₄ , Sec. 16	Joan Miller Sharon Winkler Faye Keogh	Joan Miller Sharon Winkler State of North Dakota
SE ¹ / ₄ , Sec. 16	Ronald & Janice Gunsch	Ronald Gunsch Janice Sigman Sylvia Zeiszler State of North Dakota
S ¹ / ₂ , Sec. 17	Faye Keogh Revocable Trust	Robert A. Keogh Priscilla Keogh Faye Keogh Rev. Trust Claire C. Schwalbe
N ¹ / ₂ , Sec. 17	Claire C. Schwalbe	Robert A. Keogh Priscilla Keogh Faye Keogh Rev. Trust Claire C. Schwalbe
SE ¹ / ₄ , Sec. 18	Donald & Claire Schwalbe	Donald & Claire Schwalbe State of North Dakota
NE ¹ / ₄ , Sec. 19	Casey and Julie Voigt Casey and Julie Voigt *Subject to Contract for Deed from: Shawn and Maria Voigt, Karmen and Craig Eslinger, Donalda Voigt, and Kenneth Voigt	Patience & Calvin Saylor Casey & Julie Voigt Kari & Michael Trappen Karmen & Craig Eslinger Dean Voigt Donalda Voigt Kenneth Voigt Shawn & Maria Voigt
NE ¹ / ₄ NE ¹ / ₄ NW ¹ / ₄ NW ¹ / ₄ S ¹ / ₂ N ¹ / ₂ N ¹ / ₂ S ¹ / ₂ , Sec. 20 S ¹ / ₂ S ¹ / ₂ , Sec. 20	Dakota Westmoreland Corporation	United States of America Dakota Westmoreland State of North Dakota Dakota Westmoreland
NE ¹ / ₄ NW ¹ / ₄ , Sec. 20	Dakota Westmoreland Corporation	Dakota Westmoreland Corp.
NW ¹ / ₄ NE ¹ / ₄ , Sec. 20	Ronald & Janice Gunsch	Ronald Gunsch Janice Sigman Sylvia Zeiszler Sharon Winkler Joan Miller
N ¹ / ₂ , Sec. 21	Sharon Winkler Joan Miller Wilfred Esch	Sharon Winkler Joan Miller Wilfred Esch
S ¹ / ₂ , Sec. 21	Wilfred Esch	Wilfred Esch

N½ S½, Sec. 20	Dakota Westmoreland Corporation	Dakota Westmoreland State of North Dakota
S½S½, Sec. 20	Dakota Westmoreland Corporation	Dakota Westmoreland Corp.
NE¼NW¼, Sec. 20	Ronald & Janice Gunsch	Ronald Gunsch Janice Sigman Sylvia Zeiszler Sharon Winkler Joan Miller Wilfred Fetch Angeline Braun Cary Unterseher
N½, Sec. 21	Sharon Winkler Joan Miller Wilfred Fetch	United States of America
S½, Sec. 21	Angeline Braun Cary Unterseher	United States of America
NE¼, Sec. 22	Terence Schmidt	United States of America
NW¼, Sec. 22	Ronald and Janice Gunsch	United States of America
SE¼, Sec. 22	Vergene Christianson	United States of America
E½SW¼, Sec. 22	Ronald and Janice Gunsch	United States of America
W½SW¼, Sec. 22	Rita Schmidt Bonniita Schmidt Debra (Schmidt) Hoerer Darla (Schmidt) Ratzak Gene Schmidt Candida (Schmidt) Rhoades	United States of America

NW¼, Sec. 23	Terence Schmidt	Terence Schmidt Tammy Schmidt Julia K. Allison Carl Bauer John Bauer Joan Brown Karen P. Dietz Maggianna L. Hunt Nancy Weigel Jensen Kathy M. Leber Kathleen McCrary Susan McCrary Cheryl McFadden David M. Pantermuehl John Pantermuehl Roland M. Pantermuehl Barbara Ann Teed Eugene Arnold Weigel Karel M. Weigel Janice P. Ziegler Lyle & Patricia Winkler
SW¼, Sec. 23	Terence Schmidt	
N½, Sec. 29	Lyle & Patricia Winkler	

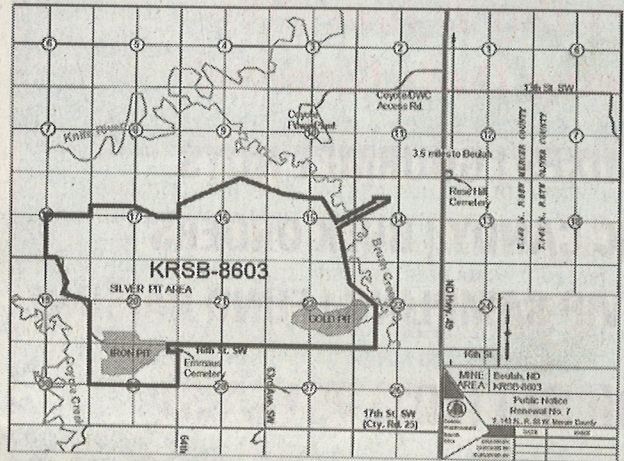

5/22, 29, 6/5 & 12 - 28173

The plat was prepared by the County Auditor of the County of...
 Later, McGraw-Hill...
 comment had been...
 nately taken out of...