

BEULAH BEACON

Remit Payments to 324 2nd Ave NE, Beulah, ND 58523 www.centralnordak.com

	Invoice Number	Invoice Date
	517461	5/31/2023
Advertiser No.	Amount Due	Due Date
16734	\$1,393.00	6/30/2023

Dakota Westmoreland-Beulah
 Attn: Scott Aberle
 Po Box 39
 Beulah ND 58523

A finance charge of 1.5% will be applied to any account where payment is not received by the 25th.

Amount Enclosed

Please detach top portion and return with your payment.

INVOICE

Beulah Beacon		Dakota Westmoreland-Beulah			Invoice No. 517461	5/31/2023
Date	Order	Description	Ad Size	SubTotal	Sales Tax	Amount
5/4/2023	215888	HS Legals: Legals: Application for Coal Mine Permit Application for Coal Mine Permit	1 Lines			\$0.00
5/11/2023	215888	HS Legals: Legals: Application for Coal Mine Permit Application for Coal Mine Permit	1 Lines			\$0.00
5/18/2023	215888	HS Legals: Legals: Application for Coal Mine Permit Application for Coal Mine Permit	1 Lines			\$1,393.00
					Sub Total:	\$1,393.00
Total Transactions: 3					Total:	\$1,393.00

SUMMARY Advertiser No. 16734 Invoice No. 517461 Invoice Amount \$1,393.00

A finance charge of 1.5% will be applied to any account where payment is not received by the 25th.

Thank You!

A fee of 1.5% will be imposed on all balances that are past due.
 Please make checks payable to:

Beulah Beacon
 324 2nd Ave NE
 Beulah, ND 58523

Thank you for advertising with our paper!

Pay online at <https://www.centralnordak.com/pay-my-bill/>

Affidavit of Publication

STATE OF NORTH DAKOTA,
COUNTY OF MERCER, ss.

I, Marge Schaffer, being first duly sworn, on oath says, that she is the bookkeeper of the THE HAZEN STAR, a weekly newspaper published in Hazen, County of Mercer, and has full and personal knowledge of all the facts herein stated; that said newspaper is a legal newspaper and has a bona fide circulation of at least two hundred copies weekly, and has been published within said county for fifty-two successive weeks next prior to the publication of the notice herein mentioned; that the

Application for Coal Mine Permit

Dakota Westmoreland-Beulah

a printed copy of which, taken from the paper in which same was published, is attached to this sheet, and is made a part of this Affidavit, was published in said newspaper at least once each week for 4 successive week, on the day of each week on which said newspaper was regularly published to-wit: —

3 - Hazen Star: 4/27/2023, 5/4/2023, 5/11/2023,
5/18/2023

That the full amount of the fees for
the publication of the annexed notice is: \$ 1393.00



Subscribed and sworn to before me this 6/5/2023



Arden Pahl, Notary Public
State of South Dakota

My commission expires August 1, 2025



NOTICE OF APPLICATION COAL MINE PERMIT

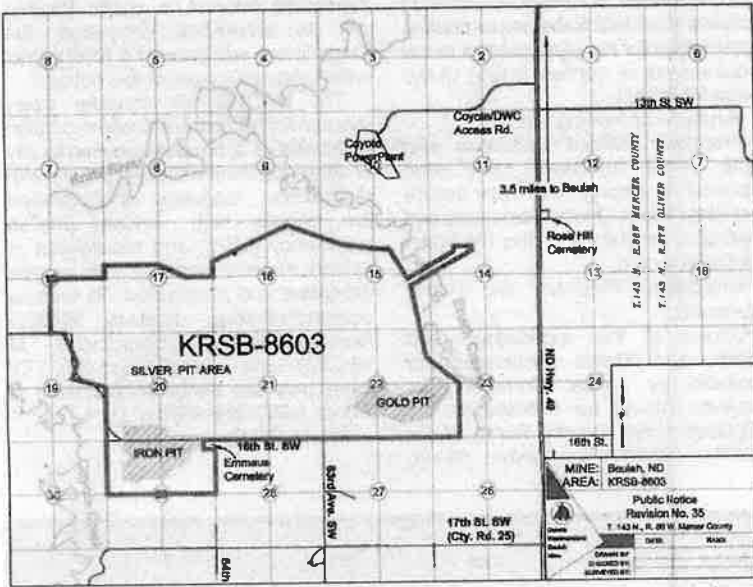

FOR REVISION TO A SURFACE COAL MINE PERMIT

Please take notice that Westmoreland Beulah Mining LLC, PO Box 39, Beulah, North Dakota 58523, has made application to the North Dakota Public Service Commission for Revision No. 35 to Surface Coal Mining Permit KRSB-8603. Revision No. 35 proposes to modify reclamation schedules for the Silver, Gold, and Iron pits. Revision No. 35 also will update the water management plan to include newly constructed ponds, and update the certified leases and agreements.

The permit area is located in Sections 14, 15, 16, 17, 18, 19, 20, 21, 22, 23, and 29, T.143N., R.88W.,

LOCATION
S½NW¼, Sec. 14

NW¼, Sec. 15

NE¼, Sec. 15

S½, Sec. 15

N½, Sec. 16
SW¼, Sec. 16

SE¼, Sec. 16

S½, Sec. 17

N½, Sec. 17

SE¼, Sec. 18

NE¼, Sec. 19

Mercer County, North Dakota. This area is contained on the United States geological survey map named Medicine Butte, N.E., North Dakota. The precise location and boundaries of the permit area are depicted on the accompanying map.

This application is on file in the Office of the Director, Reclamation Division, Public Service Commission, State Capitol, Bismarck, North Dakota and the Office of the County Auditor, Mercer County, Stanton, North Dakota. It may be viewed at these locations during normal working hours.

Written comments, objections, requests for an informal conference on the revision application may be

SURFACE OWNER(S)
Otter Tail Power Company
Northern Municipal Power Agency
Northwestern Corporation
Montana-Dakota Utilities Co.

Otter Tail Power Company
Northern Municipal Power Agency
Northwestern Corporation
Montana-Dakota Utilities Co.
Westmoreland Beulah Mining
Otter Tail Power Company
Northern Municipal Power Agency
Northwestern Corporation
Montana-Dakota Utilities Co.
Faye L. Keogh Revocable Trust

ND Department of Trust Lands
Joan Miller
Sharon Winkler

Ronald & Janice Gunsch

Faye Keogh Revocable Trust

Claire C. Schwalbe

Donald & Claire Schwalbe

Casey and Julie Voigt
Casey and Julie Voigt*
*Subject to Contract for Deed from:
Shawn and Maria Voigt,
Karmen and Craig Eslinger,

submitted by any person with an interest which is or may be adversely affected to the North Dakota Public Service Commission within 30 days of the last publication of this notice. The written request should state the concerns or objections regarding the revision. The address for the North Dakota Public Service Commission is 600 East Boulevard Avenue, Dept. 408, Bismarck, North Dakota 58505-0480.

The legal description and names of the apparent surface and mineral owners of the land affected by the revision are as follows:

T.143N., R88W., Mercer County

COAL OWNER(S)
United States of America
Gary Murray
Armon & Peggy J. Wolff
Family Mineral Trust
Phyllis O'Neil

Lydia Stoppler
Daryl E. Zimmerman
Robert A. Keogh
Priscilla Keogh
Faye Keogh Rev. Trust
Claire C. Schwalbe
Robert A. Keogh
Priscilla Keogh
Faye Keogh Rev. Trust
Claire C. Schwalbe

Robert A. Keogh
Priscilla Keogh
Faye Keogh Revocable Trust
Claire C. Schwalbe

ND Department of Trust Lands
Joan Miller
Sharon Winkler

ND Department of Trust Lands
Ronald Gunsch
Janice Sigman
Sylvia Zeiszler

ND Department of Trust Lands
Robert A. Keogh
Priscilla Keogh
Faye Keogh Rev. Trust

Claire C. Schwalbe
Robert A. Keogh
Priscilla Keogh
Faye Keogh Rev. Trust

Claire C. Schwalbe
Donald & Claire Schwalbe
ND Department of Trust Lands

Patience & Calvin Saylor
Casey & Julie Voigt
Kari & Michael Trappen
Karmen & Craig Eslinger

Dean Voigt
Bonnie Voigt

Casey and Julie Voigt
*Subject to Contract for Deed from:
Shawn and Maria Voigt,
Karmen and Craig Eslinger,
Donalda Voigt, and
Kenneth Voigt

Casey & Julie Voigt
Kari & Michael Trappen
Karmen & Craig Eslinger
Dean Voigt
Donalda Voigt
Kenneth Voigt
Shawn & Maria Voigt
United States of America

NE¼ NE¼
NW¼ NW¼
S½ N½
N½ S½, Sec. 20
S½S½, Sec. 20

Westmoreland Beulah Mining

NE¼NW¼, Sec. 20
NW¼NE¼, Sec. 20

Westmoreland Beulah Mining
Westmoreland Beulah Mining
Ronald & Janice Gunsch

Westmoreland Beulah Mining
ND Department of Trust Lands
Westmoreland Beulah Mining
Ronald Gunsch
Janice Sigman
Sylvia Zeiszler
Sharon Winkler
Joan Miller
Wilfred Fetch
Angeline Braun
Cary Unterseher
United States of America
United States of America
United States of America
United States of America
United States of America

N½, Sec. 21

Sharon Winkler
Joan Miller
Wilfred Fetch
Angeline Braun
Cary Unterseher
Terence Schmidt
Ronald and Janice Gunsch
Vergene Christianson
Ronald and Janice Gunsch
Rita Schmidt
Bonnita Schmidt
Debra (Schmidt) Hoerer
Darla (Schmidt) Ratzak
Gene Schmidt
Candida (Schmidt) Rhoades

Terence Schmidt
Tammy Schmidt
Julia K. Allison
Carl Bauer
John Bauer
Joan Brown
Karen P. Dietz
Margianna L. Hunt
Nancy Weigel Jensen
Kathy M. Leber
Kathleen McCrary
Susan McCrary
Cheryl McFadden
David M. Pantermuehl
John Pantermuehl
Roland M. Pantermuehl
Barbara Ann Teed
Eugene Arnold Weigel
Karel M. Weigel
Janice P. Ziegler
Lyle & Patricia Winkler

S½, Sec. 21

NE¼, Sec. 22
NW¼, Sec. 22
SE¼, Sec. 22
E½SW¼, Sec. 22
W½SW¼, Sec. 22

NW¼, Sec. 23

Terence Schmidt

SW¼, Sec. 23

Terence Schmidt

N½, Sec. 29

Lyle & Patricia Winkler

(04-27-2023)(05-04-2023)(05-11-2023)(05-18-2023)

*** Proof of Publication ***

State of North Dakota)
County of Burleigh) SS:

Before me, a Notary Public for the State of North Dakota personally

appeared Phil Stribel who being duly sworn, deposes and says that he (she) is the Clerk of Bismarck Tribune Co., and that the publication(s) were made through the

Bismarck Tribune on the following dates:

4/21/23, 4/28/23, 5/5/23, 5/12/23

Signed [Signature]

Westmoreland Mining LLC
Jesse Noel
1601 LEWIS AVE., SUITE 112
BILLINGS MT 59102

ORDER NUMBER 58034

Sworn and subscribed to before me this 17 day of

May 2023

Candice Blohm

Notary Public in and for the State of North Dakota

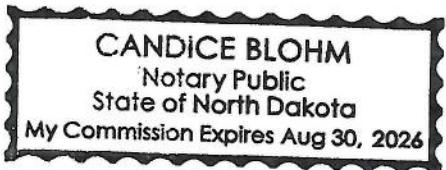

Section: Legals

Category: 5380 Public Notices

PUBLISHED ON: 04/21/2023, 04/28/2023, 05/05/2023, 05/12/2023

TOTAL AD COST: 3010.40

FILED ON: 5/16/2023

NOTICE OF APPLICATION

FOR REVISION TO A SURFACE COAL MINE PERMIT

Please take notice that Westmoreland Beulah Mining LLC, PO Box 39, Beulah, North Dakota 58523, has made application to the North Dakota Public Service Commission for Revision No. 35 to Surface Coal Mining Permit KRSB-8603. Revision No. 35 proposes to modify reclamation schedules for the Silver, Gold, and Iron pits. Revision No. 35 also will update the water management plan to include newly constructed ponds, and update the certified leases and agreements.

The permit area is located in Sections 14, 15, 16, 17, 18, 19, 20, 21, 22, 23, and 29, T.143N., R.88W., Mercer County, North Dakota. This area is contained on the United States geological survey map named Medicine Butte, N.E., North Dakota. The precise location and boundaries of the permit area are depicted on the accompanying map.

This application is on file in the Office of the Director, Reclamation Division, Public Service Commission, State Capitol, Bismarck, North Dakota and the Office of the County Auditor, Mercer County, Stanton, North Dakota. It may be viewed at these locations during normal working hours.

Written comments, objections, requests for an informal conference on the revision application may be submitted by any person with an interest which is or may be adversely affected to the North Dakota Public Service Commission within 30 days of the last publication of this notice. The written request should state the concerns or objections regarding the revision. The address for the North Dakota Public Service Commission is 600 East Boulevard Avenue, Dept. 408, Bismarck, North Dakota 58505-0480.

The legal description and names of the apparent surface and mineral owners of the land affected by the revision are as follows:

T.143N., R.88W., Mercer County

<u>LOCATION</u>	<u>SURFACE OWNER(S)</u>	<u>COAL OWNER(S)</u>
S½NW¼, Sec. 14	Otter Tail Power Company Northern Municipal Power Agency Northwestern Corporation Montana-Dakota Utilities Co.	United States of America Gary Murray Armon & Peggy J. Wolff Family Mineral Trust Phyllis O'Neil Lydia Stoppler Daryl E. Zimmerman
NW¼, Sec. 15	Otter Tail Power Company Northern Municipal Power Agency Northwestern Corporation Montana-Dakota Utilities Co.	Robert A. Keogh Priscilla Keogh Faye Keogh Rev. Trust Claire C. Schwalbe
NE¼, Sec. 15	Westmoreland Beulah Mining Otter Tail Power Company Northern Municipal Power Agency Northwestern Corporation Montana-Dakota Utilities Co.	Robert A. Keogh Priscilla Keogh Faye Keogh Rev. Trust Claire C. Schwalbe
S½, Sec. 15	Faye L. Keogh Revocable Trust	Robert A. Keogh Priscilla Keogh Faye Keogh Revocable Trust Claire C. Schwalbe
N½, Sec. 16	ND Department of Trust Lands	ND Department of Trust Lands
SW¼, Sec. 16	Joan Miller Sharon Winkler	Joan Miller Sharon Winkler
SE¼, Sec. 16	Ronald & Janice Gunsch	ND Department of Trust Lands Ronald Gunsch Janice Sigman Sylvia Zeisler
S½, Sec. 17	Faye Keogh Revocable Trust	ND Department of Trust Lands Robert A. Keogh Priscilla Keogh Faye Keogh Rev. Trust Claire C. Schwalbe
N½, Sec. 17	Claire C. Schwalbe	Robert A. Keogh Priscilla Keogh Faye Keogh Rev. Trust Claire C. Schwalbe
SE¼, Sec. 18	Donald & Claire Schwalbe	Donald & Claire Schwalbe ND Department of Trust Lands
NE¼, Sec. 19	Casey and Julie Voigt Casey and Julie Voigt* *Subject to Contract for Deed from: Shawn and Maria Voigt, Karmen and Craig Eslinger, Donalda Voigt, and Kenneth Voigt	Patience & Calvin Saylor Casey & Julie Voigt Kari & Michael Trappen Karmen & Craig Eslinger Dean Voigt Donalda Voigt Kenneth Voigt Shawn & Maria Voigt
NE¼ NE¼ NW¼ NW¼ S½ N½ N½ S½, Sec. 20	Westmoreland Beulah Mining	United States of America

