



825 Rice Street  
Saint Paul, MN 55117

May 1, 2023

Steve Kahl, Executive Secretary  
North Dakota Public Service Commission  
600 East Boulevard, Dept. 408  
Bismarck, ND 58505-0480

Subject: Case Number DM-23-153

Dear Mr. Kahl:

On April 14, 2023, Northern States Power Company (NSP), a Minnesota company and wholly owned subsidiary of Xcel Energy Company, received a copy of the ND One Call Complaint against Xcel Energy from Montana-Dakota Utilities Company (MDU). The location, identified in the One-Call Ticket Number 22080151, is 205 10th Avenue Southeast, Minot, ND.

On June 29, 2022, NSP cleared One-Call Ticket Number 22061578 based on the description under "Location of Work." The work was delayed, and Montana-Dakota Utilities Company submitted an updated One-Call Ticket request. On July 25, 2022, NSP cleared One-Call Ticket Number 22080151 based on the description under "Location of Work."

ND Century Code 49-23-04, Subsection 2, paragraph a, requires site identification information unless "[t]he precise location of excavation can be clearly and adequately identified on the location notice and is limited to a single street address or a platted lot number of record." The polygon on ticket numbers 22061578 and 22080151 includes an area from the north side of the building, southward to extend into the property on the south side of 10th Avenue SE. Polygons are notification areas, not the precise location of the excavation that is described under the "Location of Work."

NSP's investigation determined that its electric line damaged by MDU was outside the precise location of excavation listed under "Location of Work" on the One-Call Ticket. Further, the excavator performed excavation outside of the precise location of a valid One-Call Ticket in violation of ND Century Code 49-23-04, subsection 1.

NSP is actively working with MDU to resolve this matter. If you need further information or clarification regarding the enclosed response, please contact Lisa Kallberg at 651-788-0648.

Sincerely,

A handwritten signature in black ink, appearing to read 'Jeffery Cremin'.

Jeffery Cremin, Manager Pipeline Compliance & Standards

cc: Alex Nisbet, Christine Schwartz

3 DM-23-153 Filed 05/01/2023 Pages: 7  
Response to North Dakota One-Call Complaint  
Northern States Power Company  
Jeffery Cremin

# North Dakota One Call

**Ticket No:** 22061578  
LORQ ROUTINE  
**Relocated by:** 22080151  
**Original Call Date:** 06/27/22 02:08 pm  
**Op:** webusr5  
**Work to Begin Date:** 06/30/22 12:01 am  
**Op:** webusr5  
**Expiration Date:** 07/21/22 12:01 am

## CALLER INFORMATION

**Company Name:** MONTANA DAKOTA UTILITIES  
**Contact Name:** SHANE BRANSON  
**Phone:** 701-818-4617  
**Alt Contact:** INSTALL GCURT OLSON  
**Alt. Phone:** 701-857-9901  
**Caller Address:** 1130 20TH AVE MINOT, ND 58701  
**Email Address:** shane.branson@mdu.com

## DIG SITE INFORMATION

**Type of Work:** REPLACE GAS SERVICE  
**Work Being Done For:** MDU  
**Depth:** 6FT  
**Explosives:** N  
**Tunneling/Boring:** Y  
**White Lining/Site Identification:** OTHER

## DIG SITE LOCATION

**County:** WARD  
**Place:** MINOT  
**City Limits:** Y  
**Address:** 205  
**Street:** 10TH AVE SE  
**Intersecting Street:** 2ND ST SE  
**Location of Work:** LOCATE THE SOUTH HALF OF THE LOT INCLUDING 10TH AVE SE FOR THE WIDTH OF THE LOT  
**Remarks:**  
**Map Twp:** 155N  
**Rng:** 83W  
**Sect-Qtr:** 24-SW  
**Map Coord NW Lat:** 48.2269658  
**Lon:** -101.2906624  
**SE Lat:** 48.2266371  
**Lon:** -101.2904371

## MEMBERS NOTIFIED

| District | Company Name                   | Marking Concerns | Status  |
|----------|--------------------------------|------------------|---|
| MDU01    | MONTANA DAKOTA UTILITIES CO    | 406-728-9343     | Marked  |
| MIDCON26 | MIDCONTINENT CABLE             | 605-271-0202     | Clear/No conflict (Overhead plant all clear)  |
| MINOT01  | CITY OF MINOT WATER SEWER DEPT | 701-857-4140     | Marked (Water and Sewer lines installed before 2013 Paint marks on ground are approximate and could be off by 20 feet or more and are best guess Questions call 701-833-7587) |
| NDXCEL01 | XCEL ENERGY                    | 800-848-7558     | Clear/No conflict   |
| SOURIS01 | SOURIS RIVER TELECOMMUNICATION | 888-355-2515     | Marked  |

**Legend:**  Locate Polygon

Lat/Lon 48.227111 -101.290630

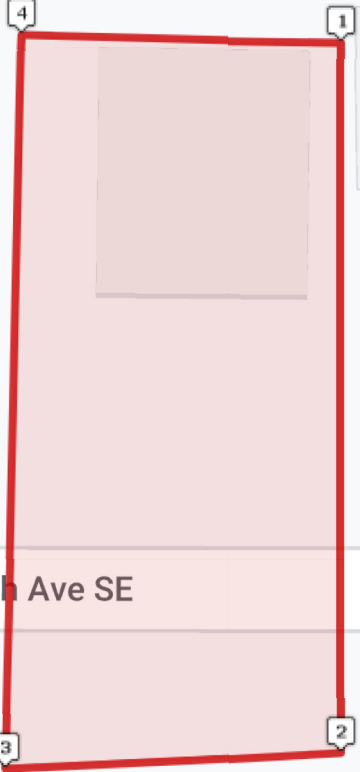

10th Ave SE

10th Ave SE

10th Ave SE

2nd St SE  
2nd St SE

Google

Map data ©2023 Google 5 m

# North Dakota One Call

**Ticket No:** 22080151  
LORG RESPOT  
**Relocate Counter:** 1  
**Update of:** 22061578  
**Original Call Date:** 07/22/22 10:57 am  
**Op:** webusr5  
**Work to Begin Date:** 07/27/22 12:01 am  
**Op:** webusr5  
**Expiration Date:** 08/17/22 12:01 am

## CALLER INFORMATION

**Company Name:** MONTANA DAKOTA UTILITIES  
**Contact Name:** SHANE BRANSON  
**Phone:** 701-818-4617  
**Alt Contact:** INSTALL GCURT OLSON  
**Alt. Phone:** 701-857-9901  
**Caller Address:** 1130 20TH AVE MINOT, ND 58701  
**Email Address:** shane.branson@mdu.com

## DIG SITE INFORMATION

**Type of Work:** REPLACE GAS SERVICE  
**Work Being Done For:** MDU  
**Depth:** 6FT  
**Explosives:** N  
**Tunneling/Boring:** Y  
**White Lining/Site Identification:** OTHER

## DIG SITE LOCATION

**County:** WARD  
**Place:** MINOT  
**City Limits:** Y  
**Address:** 205  
**Street:** 10TH AVE SE  
**Intersecting Street:** 2ND ST SE  
**Location of Work:** LOCATE THE SOUTH HALF OF THE LOT INCLUDING 10TH AVE SE FOR THE WIDTH OF THE LOT  
**Remarks:** UPDATE: TIME EXPIRED >>  
**Map Twp:** 155N  
**Rng:** 83W  
**Sect-Qtr:** 24-SW  
**Map Coord NW Lat:** 48.2269658  
**Lon:** -101.2906624  
**SE Lat:** 48.2266371  
**Lon:** -101.2904371

## MEMBERS NOTIFIED

| District | Company Name                   | Marking Concerns | Status  |
|----------|--------------------------------|------------------|---|
| MDU01    | MONTANA DAKOTA UTILITIES CO    | 406-728-9343     | Marked  |
| MIDCON26 | MIDCONTINENT CABLE             | 605-271-0202     | Clear/No conflict<br>(Overhead plant all clear) |
| MINOT01  | CITY OF MINOT WATER SEWER DEPT | 701-857-4140     | Marked  |
| NDXCEL01 | XCEL ENERGY                    | 800-848-7558     | Clear/No conflict                               |
| SOURIS01 | SOURIS RIVER TELECOMMUNICATION | 888-355-2515     | Marked  |

Legend:  Locate Polygon

Lat/Lon

48.227082 -101.290695

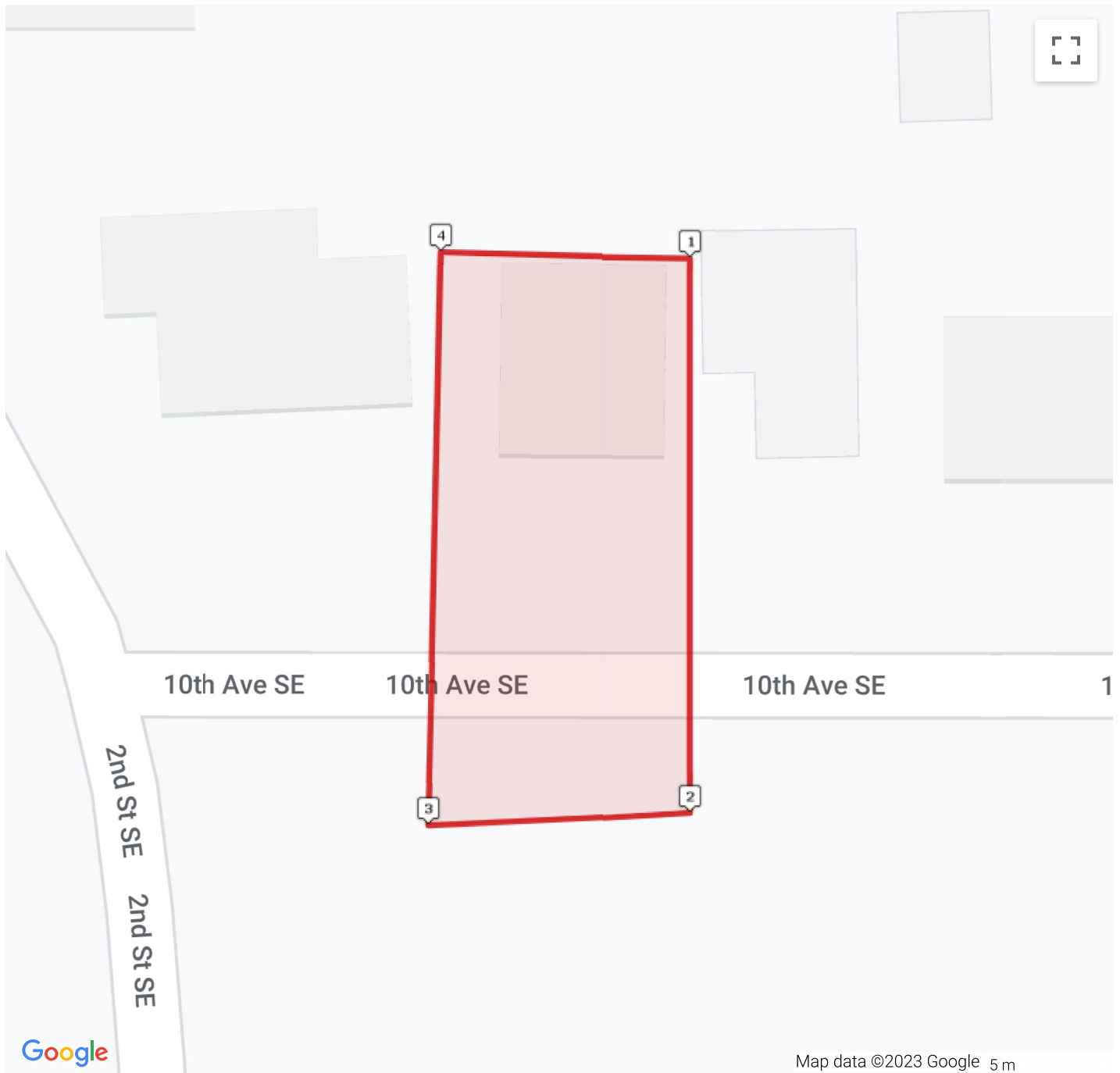

Google

Map data ©2023 Google 5m