

Affidavit of Publication

STATE OF NORTH DAKOTA,
COUNTY OF MERCER, ss.

I, Lori Cox, being first duly sworn, on oath says, that she is the bookkeeper of the THE HAZEN STAR, a weekly newspaper published in Hazen, County of Mercer, and has full and personal knowledge of all the facts herein stated; that said newspaper is a legal newspaper and has a bona fide circulation of at least two hundred copies weekly, and has been published within said county for fifty-two successive weeks next prior to the publication of the notice herein mentioned; that the

Notice of Filing Permit

Coteau Properties

a printed copy of which, taken from the paper in which same was published, is attached to this sheet, and is made a part of this Affidavit, was published in said newspaper at least once each week for 4 successive week, on the day of each week on which said newspaper was regularly published to-wit:

3 - Hazen Star: 1/18/2024, 1/25/2024, 2/1/2024,
2/8/2024

That the full amount of the fees for
the publication of the annexed notice is: \$ 6427.00

Lori Cox

Subscribed and sworn to before me this 2/9/2024

Arden Pahl

Arden Pahl, Notary Public
State of South Dakota

My commission expires August 1, 2025

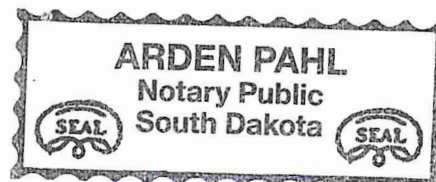

NOTICE OF FILING A PERMIT RENEWAL AND REVISION TO CONDUCT SURFACE COAL MINING AND RECLAMATION OPERATIONS

The Coteau Properties Company, 204 County Road 15, Beulah, North Dakota 58523, as application, has filed an Application for Renewal of Permit NACT-0201 with the North Dakota Public Service Commission. The current permit area covers portions of Sections 2, 3, 4, 5, 6, 7, 8, and 9 of T144N, R88W; Sections 1 and 12 of T144N, R89W; Sections 30, 31, and 32 of T145N, R87W; and Sections 3, 4, 9, 10, 11, 14, 15, 16, 21, 22, 23, 25, 26, 27, 28, 33, 34, 35, and 36 of T145N, R88W, of the Fifth Principal Meridian, Mercer County, North Dakota. The total acreage within the permit area is approximately 17,170.7 acres. The permit term will be from April 14, 2024 to April 14, 2029. The Coteau Properties Company has also filed an application for Revision 28 to Permit NACT-0201 with the North Dakota Public Service Commission. This revision identifies the coal removal subarea that will be mined during the next five-year permit term, and addresses all operational changes proposed during the next permit term. Federally owned coal, located in the E 1/2 of Section 4, T145N, R88W and the E 1/2 of 12, T144N, R88W will not be mined until Federal Mine Plan Approval is received from the Office of Surface Mining (OSM). Updates have been made to the introductory information, legal information, business entity/compliance information, identification of interests and rights of entry, surface water hydrology, ground water hydrology, soil resources, fish and wildlife resources, operations – general, transportation facilities, surface water management, post-mining land use plans, revegetation procedures, establishment, and management, post-mining wetlands. The permit area is approximately three miles north of Beulah, and approximately two miles north of Zap, North Dakota. The newspaper publication notice map shows the distance to the cities of Beulah and Zap, North Dakota, and the outline of the permit area. The owners of the surface and coal in the permit area are as follows:

TRACT 1
Township 144 North, Range 88 West Section 2: Lots 3, 4, S 1/2 NW 1/4, less and except Sublot 5, containing 78.9818 acres, and less and except a parcel of land containing 12.2893 acres located in the NW 1/4. SURFACE OWNERSHIP: Jacob H. Schramm
COAL OWNERSHIP: United States of America – Bureau of Land Management

TRACT 1-A
Township 144 North, Range 88 West Section 2: A parcel of land containing 12.2893 acres located in the NW 1/4. SURFACE OWNERSHIP: Basin Electric Power Cooperative
COAL OWNERSHIP: United States of America – Bureau of Land Management

TRACT 1-B
Township 144 North, Range 88 West Section 2: Sublot 5 located in the NW 1/4, containing 78.9818 acres
SURFACE OWNERSHIP: The Coteau Properties Company
COAL OWNERSHIP: United States of America – Bureau of Land Management

TRACT 2
Township 144 North, Range 88 West Section 2: S 1/2 SW 1/4; NE 1/4 SW 1/4; Sublot 7 located in the NW 1/4 SW 1/4, containing 27.973 acres
SURFACE OWNERSHIP: Donald Boeckel and Caroline I. Boeckel
COAL OWNERSHIP: Donald Boeckel and Caroline I. Boeckel; Deniese LeMasters; Bruce Miller; Paula Jurgens; Mary Voigt; Marva Keller; Judith Keller; Alice Bosch Barker; Gerald Pischel; Anne Carlsen Center; North Dakota Vision Services/School for the Blind; Dakota Zoo; Beulah Congregational Church; ND Elks Association, FBO Elks Camp Grassick; Mercer County Historical Society; Central Dakota Humane Society; Harry H. Diamond Incorporated; PAL Properties, Inc.; Black Stone Minerals Company, L. P.; Joe W. Smith; PAR Oil Company, Inc.

TRACT 2-A
Township 144 North, Range 88 West Section 2: A parcel of land containing 5.664 acres located in the SW 1/4
SURFACE OWNERSHIP: Basin Electric Power Cooperative
COAL OWNERSHIP: Anne Carlsen Center; North Dakota Vision Services/School for the Blind; Dakota Zoo; Beulah Congregational Church; ND Elks Association, FBO Elks Camp Grassick; Mercer County Historical Society; Central Dakota Humane Society; Harry H. Diamond Incorporated; PAL Properties, Inc.; Black Stone Minerals Company, L. P.; Joe W. Smith; PAR Oil Company, Inc.

TRACT 2-B
Township 144 North, Range 88 West Section 2: Sublot 6 located in the NW 1/4 SW 1/4, containing 6.128 acres
SURFACE OWNERSHIP: The Coteau Properties Company
COAL OWNERSHIP:

Donald Boeckel and Caroline I. Boeckel; Deniese LeMasters; Bruce Miller; Paula Jurgens; Mary Voigt; Marva Keller; Judith Keller; Alice Bosch Barker; Gerald Pischel; Anne Carlsen Center; North Dakota Vision Services/School for the Blind; Dakota Zoo; Beulah Congregational Church; ND Elks Association, FBO Elks Camp Grassick; Mercer County Historical Society; Central Dakota Humane Society; Harry H. Diamond Incorporated; PAL Properties, Inc.; Black Stone Minerals Company, L. P.; Joe W. Smith; PAR Oil Company, Inc.

TRACT 3
Township 144 North, Range 88 West Section 3: Lots 1, 2, 3, 4, S 1/2 N 1/2
SURFACE OWNERSHIP: The Coteau Properties Company
COAL OWNERSHIP: Virgil E. Voegelé; Randy E. Voegelé; Bruce E. Voegelé; The Estate of Tillie Raszler; Kevin M. Schulz; Bryan Schulz; Connie Czelatdko, and Colleen Mulder, as Co-Trustees of the Schulz Family Mineral Trust; Darlene B. Raszler Revocable Living Trust Dated 12-12-00; John D. Stumpf and Joanne D. Stumpf, Trustees of the John and Joanne Stumpf Family Trust U/T/A 08-12-20; Scott M. Beach and Linda L. Beach Living Trust dated 10-30-19; Dale W. Stumpf; LeRoy G. Stumpf; Ronald E. Stumpf; Shirley A. Raszler, Trustee of the A. E. Raszler and S. A. Raszler Revocable Trust dated 04-14-11; Susan L. Pryor; Jeffrey A. Raszler; Brian R. Raszler; Norma Stewart; Ronald Raeszler; Muriel Soule; Myra Savelkoul

TRACT 4
Township 144 North, Range 88 West Section 3: SW 1/4 less and except 24.49 acres
SURFACE OWNERSHIP: The Coteau Properties Company
COAL OWNERSHIP: Virgil E. Voegelé; Randy E. Voegelé; Bruce E. Voegelé; The Estate of Tillie Raszler; Kevin M. Schulz; Bryan Schulz; Connie Czelatdko, and Colleen Mulder, as Co-Trustees of the Schulz Family Mineral Trust; Darlene B. Raszler Revocable Living Trust Dated 12-12-00; John D. Stumpf and Joanne D. Stumpf, Trustees of the John and Joanne Stumpf Family Trust U/T/A 08-12-20; Scott M. Beach and Linda L. Beach Living Trust dated 10-30-19; Dale W. Stumpf; LeRoy G. Stumpf; Ronald E. Stumpf; Shirley A. Raszler, Trustee of the A. E. Raszler and S. A. Raszler Revocable Trust dated 04-14-11; Susan L. Pryor; Jeffrey A. Raszler; Brian R. Raszler; Norma Stewart; Ronald Raeszler; Muriel Soule; Myra Savelkoul

TRACT 4-A
Township 144 North, Range 88 West Section 3: A tract of land containing 24.49 acres in the SW 1/4
SURFACE OWNERSHIP: Basin Electric Power Cooperative
COAL OWNERSHIP: Basin Electric Power Cooperative; Virgil E. Voegelé; Randy E. Voegelé; Bruce E. Voegelé; The Estate of Tillie Raszler; Kevin M. Schulz; Bryan Schulz; Connie Czelatdko, and Colleen Mulder, as Co-Trustees of the Schulz Family Mineral Trust; Darlene B. Raszler Revocable Living Trust dated 12-12-00; John D. Stumpf and Joanne D. Stumpf, Trustees of the John and Joanne Stumpf Family Trust U/T/A 08-12-20; Scott M. Beach and Linda L. Beach Living Trust dated 10-30-19; Dale W. Stumpf; LeRoy G. Stumpf; Ronald E. Stumpf; Shirley A. Raszler, Co-Trustee of the A. E. Raszler and S. A. Raszler Revocable Trust dated 04-14-11; Susan L. Pryor; Jeffrey A. Raszler; Brian R. Raszler; Norma Stewart; Ronald Raeszler; Muriel Soule; Myra Savelkoul

TRACT 5
Township 144 North, Range 88 West Section 3: Sublot 2 located in the SE 1/4, containing 46.682 acres
SURFACE OWNERSHIP: Donald Boeckel and Caroline I. Boeckel; Deniese LeMasters; Bruce Miller; Paula Jurgens; Mary Voigt; Marva Keller; Judith Keller; Alice Bosch Barker; Gerald Pischel; Anne Carlsen Center; North Dakota Vision Services/School for the Blind; Dakota Zoo; Beulah Congregational Church; ND Elks Association, FBO Elks Camp Grassick; Mercer County Historical Society; Central Dakota Humane Society; Harry H. Diamond Incorporated; PAL Properties, Inc.; Black Stone Minerals Company, L. P.

TRACT 5-A
Township 144 North, Range 88 West Section 3: A parcel of land containing 13.341 acres located in the SE 1/4
SURFACE OWNERSHIP: Basin Electric Power Cooperative
COAL OWNERSHIP: Basin Electric Power Cooperative; Anne Carlsen Center; North Dakota Vision Services/School for the Blind; Dakota Zoo; Beulah Congregational Church; ND Elks Association, FBO Elks Camp Grassick; Mercer County Historical Society; Central Dakota Humane Society; Joe W. Smith; Harry H. Diamond Incorporated; PAR Oil Company, Inc.; PAL Properties, Inc.; Black Stone Minerals Company, L. P.

Black Stone Minerals Company, L. P.

TRACT 5-B
Township 144 North, Range 88 West Section 3: NW 1/4 SE 1/4, Sublot 1 located in the SE 1/4, containing 59.065 acres
SURFACE OWNERSHIP: The Coteau Properties Company
COAL OWNERSHIP: Donald Boeckel and Caroline I. Boeckel; Deniese LeMasters; Bruce Miller; Paula Jurgens; Mary Voigt; Marva Keller; Judith Keller; Alice Bosch Barker; Gerald Pischel; Anne Carlsen Center; North Dakota Vision Services/School for the Blind; Dakota Zoo; Beulah Congregational Church; ND Elks Association, FBO Elks Camp Grassick; Mercer County Historical Society; Central Dakota Humane Society; Harry H. Diamond Incorporated; PAL Properties, Inc.; Black Stone Minerals Company, L. P.

TRACT 6
Township 144 North, Range 88 West Section 4: Lots 1, 2, S 1/2 NE 1/4, E 1/2 SW 1/4, SE 1/4, less a tract of land containing 24.35 acres, more or less located in the SE 1/4 SW 1/4, S 1/2 SE 1/4
SURFACE OWNERSHIP: The Coteau Properties Company
COAL OWNERSHIP: United States of America – Bureau of Land Management

TRACT 6-A
Township 144 North, Range 88 West Section 4: A tract of land containing 24.35 acres, more or less located in the SE 1/4 SW 1/4, S 1/2 SE 1/4
SURFACE OWNERSHIP: Basin Electric Power Cooperative
COAL OWNERSHIP: United States of America – Bureau of Land Management

TRACT 7
Township 144 North, Range 88 West Section 4: Lots 3, 4, S 1/2 NW 1/4
SURFACE OWNERSHIP: The Coteau Properties Company
COAL OWNERSHIP: The Coteau Properties Company; Lois and Robert Dale Fifer; Lyle Herman and Peggy Ann Herman; Lora Saylor and Michael C. Saylor; Ami Lonsinger; Jeffrey Reich; Teri Lewis; Karen Reich; Norma L. Reich and Jaylin N. Brewer, Trustees of the Theophil R. Reich Family Trust dated 05-26-16; Estate of Marva Kovalenko; Hope Smith; Virginia Scheurer; Michael P. Eckenwiler; Matthew Wayne Eckenwiler; Michelle Eckenwiler McGregor; Trumbull Oil Properties, LLC; David McHugh; Kirk M. Campbell and Douglas I. Campbell, Co-Trustees of the Robert & Margery Campbell Family Trust dated 11-01-98; Gordon L. Castleman and Nancy C. Castleman, Deceased; Frank Hervey III; Harry Brown 1998 Trust; Lone Pine, L.L.C.; The Estate of Dr. F. Beauchamp; C. Carson See; Gila Group LP; Jerome Max Westheimer, Jr., Trustee of the Jerome Max Westheimer, Jr. Trust dated 04-13-88; Joel F. Wellnitz; Christian O'Donnell; Fitzgerald Ranch and Mineral Trust; Philip P. Pearson; Alvin E. Pearson; Lester D. Pearson; Loren Doffee; Michael Forrest Esson; Adeline I. Ross; Beverly J. Bement; Karen S. Hess; Darlene Neubauer; The Revocable Living Trust of Betty Doffee MacDonald dated 09-02-09; Delilah Mae Ledford; Larry L. Doffee; Carol Ann Pahde; Candace Elizabeth Barker; Alan Doffee; Vernon L. Doffee; Darlene Doffee Looper; Brenda Doffee Urps; Kenneth B. Doffee; Thomas C. Doffee; Merco of Oklahoma, Inc.; Greenstar Resources, LLC; Roger L. Beavers, Inc.; Bear Creek Energy, LLC; John Mark Waugh, Trustee of the John Mark Waugh Trust; Vicki Waugh Eidman, Trustee of the Vicki Waugh Eidman Trust; Jones-Daube Mineral Company

TRACT 8
Township 144 North, Range 88 West Section 4: W 1/2 SW 1/4
SURFACE OWNERSHIP: The Coteau Properties Company
COAL OWNERSHIP: United States of America – Bureau of Land Management

TRACT 9
Township 144 North, Range 88 West Section 5: Lots 1, 2, S 1/2 NE 1/4, SE 1/4
SURFACE OWNERSHIP: The Coteau Properties Company
COAL OWNERSHIP: Donald Boeckel; Rosella Boeckel Saylor; Corlie Giese Satterfield; Ruth E. Wallender; Jamie Giovanni Clemenson; Judy Giovanni-Halter; Ardis Scherer and Eldora Scherer; Carol Helen Jorgensen; Michelle Eden; Marc Feit; Andrew Feit; Marvin E. Giese; Norma R. Giese; The Estate of Irene Unrath; Bernice R. Beick; Melvin Beick; Lola Hind; Nicole Morel; Gladys Savageau; The Estate of Shirley Klein; Kevin M. Schulz, Bryan Schulz, Connie Czelatdko, and Colleen Mulder, as Co-Trustees of the Schulz Family Mineral Trust; Linda Voegelé; Norma Stewart; Ronald Raeszler; Muriel Soule; Myra Savelkoul; John D. Stumpf and Joanne D. Stumpf, Trustees of the John and Joanne Stumpf Family Trust U/T/A 08-12-20; Scott M. Beach and Linda L. Beach Living Trust dated 10-30-19; Dale W. Stumpf; LeRoy G. Stumpf; Ronald E. Stumpf; Kevin M. Schulz, Bryan Schulz, Connie Czelatdko, and Colleen Mulder, as Co-Trustees of the Schulz Family Mineral Trust; Darlene B. Raszler Revocable Living Trust dated 12-12-00; Shirley A. Raszler, Trustee of the A. E. Raszler and S. A. Raszler Revocable Trust dated 04-14-11; Susan L. Pryor; Jeffrey A. Raszler; Brian R. Raszler; Estate of Tillie Raszler

TRACT 17
Township 144 North, Range 88 West Section 7: SE 1/4
SURFACE OWNERSHIP: The Coteau Properties Company
COAL OWNERSHIP: Virgil E. Voegelé; Randy E. Voegelé; The Estate of Bruce E. Voegelé; Norma Stewart; Ronald Raeszler; Muriel Soule; Myra Savelkoul; John D. Stumpf and Joanne D. Stumpf, Trustees of the John and Joanne Stumpf Family Trust U/T/A 08-12-20; Scott M. Beach and Linda L. Beach Living Trust dated 10-30-19; Dale W. Stumpf; LeRoy G. Stumpf; Ronald E. Stumpf; Kevin M. Schulz, Bryan Schulz, Connie Czelatdko, and Colleen Mulder, as Co-Trustees of the Schulz Family Mineral Trust; Darlene B. Raszler Revocable Living Trust dated 12-12-00; Shirley A. Raszler, Trustee of the A. E. Raszler and S. A. Raszler Revocable Trust dated 04-14-11; Susan L. Pryor; Jeffrey A. Raszler; Brian R. Raszler; Estate of Tillie Raszler

TRACT 18
Township 144 North, Range 88 West Section 8: N 1/2 NE 1/4
SURFACE OWNERSHIP: The Coteau Properties Company
COAL OWNERSHIP: United States of America – Bureau of Land Management

TRACT 20
Township 144 North, Range 88 West Section 8: SW 1/4 NE 1/4
SURFACE OWNERSHIP: The Coteau Properties Company

Stumpf; LeRoy G. Stumpf; Ronald E. Stumpf; Darlene B. Raszler Revocable Living Trust dated 12-12-00; Shirley A. Raszler, Trustee of the A. E. Raszler and S. A. Raszler Revocable Trust dated 04-14-11; Susan L. Pryor; Jeffrey A. Raszler; Brian R. Raszler; Ervin Giese and Margaret Giese; Betty Giese; Carol Goetz

TRACT 10
Township 144 North, Range 88 West Section 5: Lots 3, 4, S 1/2 NW 1/4
SURFACE OWNERSHIP: The Coteau Properties Company
COAL OWNERSHIP: Ervin Giese and Margaret Giese; Betty Giese, Life Estate, Remainderman: Vance Giese; Carol Goetz; Black Stone Minerals Company, L. P.; Philip P. Pearson; Alvin E. Pearson; Lester D. Pearson; Loren Doffee; Michael Forrest Esson; Adeline I. Ross; Beverly J. Bement; Karen S. Hess; Darlene Neubauer; The Revocable Living Trust of Betty Doffee MacDonald dated 09-02-09; Delilah Mae Ledford; Larry L. Doffee; Carol Ann Pahde; Candace Elizabeth Barker; Alan Doffee; Vernon L. Doffee; Darlene Doffee Looper; Brenda Doffee Urps; Kenneth B. Doffee; Thomas C. Doffee; PAL Properties, Inc.

TRACT 11
Township 144 North, Range 88 West Section 5: SW 1/4
SURFACE OWNERSHIP: The Coteau Properties Company
COAL OWNERSHIP: Betty Giese, Life Estate, Remaindermen: Heather Stephens, Landon Giese; Ervin Giese and Margaret Giese; Carol Goetz

TRACT 12
Township 144 North, Range 88 West Section 6: Lots 1, 2, 6, 7, S 1/2 NE 1/4, E 1/2 SW 1/4, SE 1/4, less a tract of land containing 4.34 acres, more or less located in the NE 1/4
SURFACE OWNERSHIP: The Coteau Properties Company
COAL OWNERSHIP: United States of America – Bureau of Land Management

TRACT 13
Township 144 North, Range 88 West Section 6: A tract of land containing 4.34 acres, more or less located in the NE 1/4
SURFACE OWNERSHIP: The Coteau Properties Company
COAL OWNERSHIP: United States of America – Bureau of Land Management

TRACT 14
Township 144 North, Range 88 West Section 6: Lots 3, 4, 5, SE 1/4 NW 1/4
SURFACE OWNERSHIP: The Coteau Properties Company
COAL OWNERSHIP: United States of America – Bureau of Land Management

TRACT 16
Township 144 North, Range 88 West Section 7: Lots 1, 2, 3, 4, E 1/2 W 1/2, NE 1/4
SURFACE OWNERSHIP: The Coteau Properties Company
COAL OWNERSHIP: Virgil E. Voegelé; Randy E. Voegelé; The Estate of Bruce E. Voegelé; Norma Stewart; Ronald Raeszler; Muriel Soule; Myra Savelkoul; John D. Stumpf and Joanne D. Stumpf, Trustees of the John and Joanne Stumpf Family Trust U/T/A 08-12-20; Scott M. Beach and Linda L. Beach Living Trust dated 10-30-19; Dale W. Stumpf; LeRoy G. Stumpf; Ronald E. Stumpf; Kevin M. Schulz, Bryan Schulz, Connie Czelatdko, and Colleen Mulder, as Co-Trustees of the Schulz Family Mineral Trust; Darlene B. Raszler Revocable Living Trust dated 12-12-00; Shirley A. Raszler, Trustee of the A. E. Raszler and S. A. Raszler Revocable Trust dated 04-14-11; Susan L. Pryor; Jeffrey A. Raszler; Brian R. Raszler; Estate of Tillie Raszler

TRACT 17
Township 144 North, Range 88 West Section 7: SE 1/4
SURFACE OWNERSHIP: The Coteau Properties Company
COAL OWNERSHIP: Virgil E. Voegelé; Randy E. Voegelé; The Estate of Bruce E. Voegelé; Norma Stewart; Ronald Raeszler; Muriel Soule; Myra Savelkoul; John D. Stumpf and Joanne D. Stumpf, Trustees of the John and Joanne Stumpf Family Trust U/T/A 08-12-20; Scott M. Beach and Linda L. Beach Living Trust dated 10-30-19; Dale W. Stumpf; LeRoy G. Stumpf; Ronald E. Stumpf; Kevin M. Schulz, Bryan Schulz, Connie Czelatdko, and Colleen Mulder, as Co-Trustees of the Schulz Family Mineral Trust; Darlene B. Raszler Revocable Living Trust dated 12-12-00; Shirley A. Raszler, Trustee of the A. E. Raszler and S. A. Raszler Revocable Trust dated 04-14-11; Susan L. Pryor; Jeffrey A. Raszler; Brian R. Raszler; Estate of Tillie Raszler

TRACT 18
Township 144 North, Range 88 West Section 8: N 1/2 NE 1/4
SURFACE OWNERSHIP: The Coteau Properties Company
COAL OWNERSHIP: United States of America – Bureau of Land Management

TRACT 20
Township 144 North, Range 88 West Section 8: SW 1/4 NE 1/4
SURFACE OWNERSHIP: The Coteau Properties Company

COAL OWNERSHIP: Norma L. Reich, Successor Trustee of the Norma L. Reich Living Trust dated 10-09-13; Corlie Giese Satterfield; Lola Hind; Ervin Giese and Margaret Giese; Betty Giese; Carol Goetz; Estate of Irene Unrath; Bernice R. Beick; Melvin Beick; Nicole Morel; Gladys Savageau; The Estate of Shirley Klein; Michelle Eden; Marc Feit; Andrew Feit; Marvin E. Giese; Norma R. Giese; Estate of Leo Raszler, Deceased; Janice Giovanni; Estate of Daniel Beick, Deceased; Ronald Raeszler; Norma Stewart; Muriel Soule; Myra Savelkoul; Ruth E. Wallender; Estate of Reuben Raszler, Deceased; Hilda Schulz; Linda Voegelé; Estate of Ervin H. Raszler, Deceased; Estate of Richard Raszler, Deceased; Darlene B. Raszler Revocable Living Trust dated 12-12-00; Estate of Arthur Giese, Deceased

TRACT 21
Township 144 North, Range 88 West Section 8: Sublot 1 located in the SE 1/4 NE 1/4, containing 22.956 acres
SURFACE OWNERSHIP: The Coteau Properties Company
COAL OWNERSHIP: United States of America – Bureau of Land Management

TRACT 21-A
Township 144 North, Range 88 West Section 8: That part of the SE 1/4 NE 1/4 (6.2034 acres) that lies within a tract containing 12.61 acres
SURFACE OWNERSHIP: Basin Electric Power Cooperative
COAL OWNERSHIP: United States of America – Bureau of Land Management

TRACT 21-B
Township 144 North, Range 88 West Section 8: Sublot 14 located in the SE 1/4 NE 1/4, containing 10.603 acres
SURFACE OWNERSHIP: Norma L. Reich, Successor Trustee of the Norma L. Reich Living Trust dated 10-09-13; Norma L. Reich and Jaylin N. Brewer, Trustees of the Theophil R. Reich Family Trust dated 05-26-16
COAL OWNERSHIP: United States of America – Bureau of Land Management

TRACT 22
Township 144 North, Range 88 West Section 8: N 1/2 NW 1/4, SE 1/4 NW 1/4, NE 1/4 SW 1/4
SURFACE OWNERSHIP: The Coteau Properties Company
COAL OWNERSHIP: United States of America – Bureau of Land Management

TRACT 23
Township 144 North, Range 88 West Section 8: SW 1/4 NW 1/4, NW 1/4 SW 1/4
SURFACE OWNERSHIP: The Coteau Properties Company
COAL OWNERSHIP: United States of America – Bureau of Land Management

TRACT 23-A
Township 144 North, Range 88 West Section 8: A tract of land containing 3.58 acres lying in the SW 1/4 SW 1/4
SURFACE OWNERSHIP: Basin Electric Power Cooperative
COAL OWNERSHIP: United States of America – Bureau of Land Management

TRACT 23-B
Township 144 North, Range 88 West Section 8: SW 1/4 SW 1/4, less a tract of land containing 3.58 acres lying in the SW 1/4 SW 1/4
SURFACE OWNERSHIP: The Coteau Properties Company
COAL OWNERSHIP: United States of America – Bureau of Land Management

TRACT 24
Township 144 North, Range 88 West Section 8: Sublot 18 located in the SE 1/4 SW 1/4, containing 19.278 acres
SURFACE OWNERSHIP: Betty Giese, Life Estate, Remaindermen: Heather Stephens, Landon Giese
COAL OWNERSHIP: United States of America – Bureau of Land Management

TRACT 24-A
Township 144 North, Range 88 West Section 8: Sublot 9 located in the SE 1/4 SW 1/4, containing 7.166 acres
SURFACE OWNERSHIP: Basin Electric Power Cooperative
COAL OWNERSHIP: United States of America – Bureau of Land Management

TRACT 25
Township 144 North, Range 88 West Section 8: Sublot 2 located in the NE 1/4 SE 1/4, containing 0.448 acres; Sublot 3 located in the NW 1/4 SE 1/4, containing 26.717 acres
SURFACE OWNERSHIP: The Coteau Properties Company
COAL OWNERSHIP: Norma L. Reich, Successor Trustee of the Norma L. Reich Living Trust dated 10-09-13; Corlie Giese Satterfield; Ervin Giese; Betty Giese; Carol Goetz; Irene

Unrath; Aaron Beick; Melvin Beick; Betty Linabitz; Gladys Savageau; Shirley Klein; Norma (Giese) Feit; Marvin E. Giese; Norma R. Giese; Ida Mae Fetting; Ruth E. Wallender; Estate of Richard Raszler, Deceased; Hilda Schulz; Darlene B. Raszler Revocable Living Trust dated 12-12-00; Ronald Raeszler; Norma Stewart; Muriel Soule; Myra Savelkoul; Estate of Leo Raszler, Deceased; Estate of Reuben Raszler, Deceased; Linda Voegelé; Estate of Ervin H. Raszler, Deceased; Estate of Arthur Giese, Deceased; Janice Giovanni; Estate of Daniel Beick, Deceased
TRACT 25-A
 Township 144 North, Range 88 West Section 8: 6.5018 acres located in the N½SE¼
SURFACE OWNERSHIP: Basin Electric Power Cooperative
COAL OWNERSHIP: Basin Electric Power Cooperative; Corlie Giese Satterfield; Ida Mae Fetting; Ervin Giese; Betty Giese; Carol Goetz; Irene Unrath; Ronald Raeszler; Norma Stewart; Muriel Soule; Myra Savelkoul; Ruth E. Wallender; Estate of Reuben Raszler, Deceased; Hilda Schulz; Linda Voegelé; Estate of Ervin H. Raszler, Deceased; Estate of Richard Raszler, Deceased; Darlene B. Raszler Revocable Living Trust dated 12-12-00; Estate of Arthur Giese, Deceased; Aaron Beick; Melvin Beick; Betty Linabitz; Gladys Savageau; Shirley Klein; Norma (Giese) Feit; Marvin E. Giese; Norma R. Giese; Estate of Leo Raszler, Deceased; Janice Giovanni; Estate of Daniel Beick, Deceased
TRACT 25-B
 Township 144 North, Range 88 West Section 8: Sublot 15 located in the NE¼SE¼, containing 37.728 acres; Sublot 16 located in the NW¼SE¼, containing 7.942 acres
SURFACE OWNERSHIP: Norma L. Reich, Successor Trustee of the Norma L. Reich Living Trust dated 10-09-13; Norma L. Reich and Jaylin N. Brewer, Trustees of the Theophil R. Reich Family Trust dated 05-26-16
COAL OWNERSHIP: N Norma L. Reich, Successor Trustee of the Norma L. Reich Living Trust dated 10-09-13; Corlie Giese Satterfield; Ervin Giese; Betty Giese; Carol Goetz; Irene Unrath; Aaron Beick; Melvin Beick; Betty Linabitz; Gladys Savageau; Shirley Klein; Norma (Giese) Feit; Marvin E. Giese; Norma R. Giese; Ida Mae Fetting; Ruth E. Wallender; Estate of Richard Raszler, Deceased; Hilda Schulz; Darlene B. Raszler Revocable Living Trust dated 12-12-00; Ronald Raeszler; Norma Stewart; Muriel Soule; Myra Savelkoul; Estate of Leo Raszler, Deceased; Estate of Reuben Raszler, Deceased; Linda Voegelé; Estate of Ervin H. Raszler, Deceased; Estate of Arthur Giese, Deceased; Janice Giovanni; Estate of Daniel Beick, Deceased
TRACT 26
 Township 144 North, Range 88 West Section 9: Sublot 1 located in the N½NW¼, containing 45.747 acres
SURFACE OWNERSHIP: Donald Boeckel and Caroline I. Boeckel
COAL OWNERSHIP: Great Northern Properties Limited Partnership
TRACT 26-A
 Township 144 North, Range 88 West Section 9: A tract of land located in the N½NW¼, containing 16.418 acres
SURFACE OWNERSHIP: Basin Electric Power Cooperative
COAL OWNERSHIP: Great Northern Properties Limited Partnership
TRACT 26-B
 Township 144 North, Range 88 West Section 9: 15.5184 acres located in the N½NW¼
SURFACE OWNERSHIP: Basin Electric Power Cooperative
COAL OWNERSHIP: Great Northern Properties Limited Partnership
TRACT 26-C
 Township 144 North, Range 88 West Section 9: A 1.7995 acre tract of land in the NW¼
SURFACE OWNERSHIP: The Coteau Properties Company
COAL OWNERSHIP: Great Northern Properties Limited Partnership
TRACT 27
 Township 144 North, Range 89 West Section 1: Lots 1 and 2
SURFACE OWNERSHIP: The Coteau Properties Company
COAL OWNERSHIP: Donnie Dschaak
TRACT 28
 Township 144 North, Range 89 West Section 1: S½NE¼
SURFACE OWNERSHIP: Karen Walz, Life Estate, Remaindermen: Denise Leighty, Corey Walz, Craig Walz, Brian Walz
COAL OWNERSHIP: Karen Walz, Life Estate, Remaindermen: Denise Leighty, Corey Walz, Craig Walz, Brian Walz; George F. Clements, Jr., Richard J. Slagle and Sallie C. Squire, Trustees of the Shore Road Living Trust; Lone Eagle Oil & Gas, LLC; Herman A. Hafner; Neil Parks and Yvonne Parks
TRACT 29
 Township 144 North, Range 89 West Section 1: SE¼
SURFACE OWNERSHIP: Dennis Flemmer and Corrine Flemmer
COAL OWNERSHIP: Garland Wiedrich and Janelle Wiedrich; Melvin

Wiedrich and Evelyn Wiedrich; Floyd Jacober; Glenn C. Sasse; Gina L. Padilla; Annette C. Branighan; Sheila M. Kuhn; George Simpferderfer and Patricia Simpferderfer; Gertrude H. Ladner and John W. Ladner; Arlie J. Flath and Edward J. Flath; Devin L. Goetz; Cary L. Cusack and Eydie M. Cusack, Trustees of the Cusack Living Trust dated 09-21-18; Arminea Brush; Martha Hoffmann; Susan E. Sasse; Cynthia Tohlen; Joyce Hoffmann; Martin Upchurch and Shellie Upchurch; Caroline Larson; Terri Fox; Brian Fox; Vida and Lemor Keller; Jane Horning and Stanley Horning; Venessa Gruba; Mandy McCabe; Dale L. Hoffmann and Kerry Hoffmann; Donna Ferderer; Linda Trettenbach; Ronald Ferderer and Donna Ferderer; Garry W. Hoffmann and Joan Hoffmann; Jerome W. Lucas; Floyd Lucas, III; Nathalia Henderickson and Michael Henderickson; Yvonne Celms; Marlene Hoffmann; Frank Lucas and Chari Lucas; Mathew Upchurch and Lara Upchurch; Kay M. Bloomquist; Kimberlee A. Fehrs; Donald Stuhlmiller and Kathy Stuhlmiller; Darrell Stuhlmiller and Barbara Stuhlmiller; Dwight Stuhlmiller; Tina Stuhlmiller; Dennis G. Stuhlmiller and Cathie Ann Stuhlmiller; Ricky Dschaak and Carmen Dschaak; Cynthia Keller; Joseph James Grad and Sharon Kay Grad; Judy Gustafson; Donnie Dschaak and Karen Dschaak; Ronnie Dschaak and Debora Dschaak; Hilbert John Dschaak and Janet Dschaak; Amy Carter Masters; Carl Simpferderfer and Susan Simpferderfer; Anthony W. Morefield and Deanna Christine Morefield; Evon Laeger; The Estate of Emelia Hoffman; Wayne Myers and Sandra Meyers
TRACT 30
 Township 144 North, Range 89 West Section 12: NE¼
SURFACE OWNERSHIP: Linette Buchfink
COAL OWNERSHIP: United States of America – Bureau of Land Management
TRACT 30-A
 Township 144 North, Range 89 West Section 12: SE¼
SURFACE OWNERSHIP: Sarah N. Bauer and Gerald D. Bauer Trustees Under the Sarah N. Bauer Living Trust dated 09-05-13
COAL OWNERSHIP: United States of America – Bureau of Land Management
TRACT 31
 Township 145 North, Range 87 West Section 30: Lot 4
SURFACE OWNERSHIP: Dakota Gasification Company
COAL OWNERSHIP: Tammy Moore; Leeta Olin; Gary Boeckel; Irene Fischer; Fay Horn; Velvet Beck; Larry D. Morast; Dustin Morast; Brittney Smith; Nagoshia Gangl; Colton Mohl; Sharon Nieuwsma; Ron Hausauer; Monty Jonathon Reub; Pamela Sue Helm; Roxy Edmond Reub; Fern Schlender; Gaylen Boeckel; Ruby Ermer
TRACT 32
 Township 145 North, Range 87 West Section 31: NE¼
SURFACE OWNERSHIP: Basin Electric Power Cooperative
COAL OWNERSHIP: Shari R. Weber, as Trustee of the Shari R. Weber Trust dated 08-10-08; Brehm Investment Group, Inc.; Flying Wolf Enterprises Inc.; Wildcat Investments Corp.; Maria T. Keith; Gary Myles Keith; Janece Lee Keith Bueche; Greenstar Resources Operating, L.L.C.; Barbara Rinehart Stortzum; Jasmine Properties, LLC; Curtis Bennett; Elizabeth Mertz; Paul Bennett; Marilyn Bennett Alexander; Carolyn Dutz; Teresa Frese McMahon; Betty Eileen Ferrel, Life Estate, Remaindermen: Rikki P. Doyle, Marcy P. Stacy; Timothy J. Pulliam, Trustee of the Timothy J. Pulliam Family Legacy Trust, dated 12-14-17; Melvin Boeckel; Peggy Becker; Darlene Harris; Sharon Rose Chadwick; Brian Henry Hess; Karen Rose Hess; Marles J. Hess; The Coteau Properties Company
TRACT 33
 Township 145 North, Range 87 West Section 31: Lots 1, 2, 3, 4, E½W¼
SURFACE OWNERSHIP: The Coteau Properties Company
COAL OWNERSHIP: Susan Elaine Mckig; Monica Eloise Stryon; Eleanor J. Greenan, William P. H. Hoar, and Brenda G. Husson, Trustees of Eleanor J. Greenan Revocable Trust under Trust Agreement dated 06-11-08; Thompson Trust; Moore Trust; Neukat Resources, LLC; Kay Gaffney Mooney, Trustee of the Gaffney Royalty Trust; Maura G. Lynch; Olive G. Twyman; Thomas E. Bird, Successor Trustee of the Bridget Healey Bird Irrevocable Trust; Jonathan E. Bird; Jean Lee Starr; Mary Starr Kelly; The Paula Starr Barovetto Living Trust dated 08-21-08; Joan Starr Devlin; Joan Devlin and Mary Kelly, Co-Trustees of the Starr 1982 Trust; Dawn E. Knowlton; John E. McCool; White Star Energy, Inc.; Spindletop Exploration Company, Inc.; Herbert Morton Ball, Jr.; Craig Douglas Ball; Carmen Ferrer; Karen Tantaló Lyons; Claudia Tantaló Watson; John Michael Lombardo; William Healey Lombardo; Peter Lombardo; Stephen W. Hodgkins; Bridget Bird; Elizabeth E. Hardy; Dr. Sally E. Peterson; William F. Ernst; Virginia E. Whitsel; Delores A.

Hoffman; Stephanie M. Thomas
TRACT 34
 Township 145 North, Range 87 West Section 31: SE¼
SURFACE OWNERSHIP: The Coteau Properties Company
COAL OWNERSHIP: Rodney Sailer and Linda M. Sailor; Dean Sailer; Pamela Wenger
TRACT 35
 Township 145 North, Range 87 West Section 32: W½NW¼, less a 14.8304 acre tract
SURFACE OWNERSHIP: Friedrich T. Buechler
COAL OWNERSHIP: Friedrich T. Buechler; EPEC OCS Company; John R. Rhodes, as Successor Trustee of the Jane Rhodes Butt Living Trust dated 11-07-95; Robert Hicks; Elizabeth Diaz; William Hicks; Virginia Massey Daniels; Virginia A. D. Richards; Olive J. D. Poe; Cynthia A. Hunt; Edwin C. Hunt; Prince Petroleum Company, Ltd.; Anthony Energy, Ltd.; PANAN Energy, Inc.; VML Resources, Inc.; Frost Bank, Successor Trustee of the Mary Leonard Children's Trust 75-6412990; JP Morgan Chase Bank, N.A., Trustee of the Miranda Leonard Revocable Trust 75-6356886; Frost Bank, Successor Trustee of the Martha Leonard Revocable Trust 75-6356886; Madelon L. Bradshaw; Frost Bank, Successor Trustee of the Miranda Leonard Trust III; Frost Bank, Successor Trustee of the Martha Leonard Trust III; Frost Bank, Successor Trustee of the Madelon Leonard Trust III
TRACT 35-A
 Township 145 North, Range 87 West Section 32: A 14.8304 acre tract lying within the W½NW¼
SURFACE OWNERSHIP: Basin Electric Power Cooperative
COAL OWNERSHIP: Friedrich T. Buechler; EPEC OCS Company; John R. Rhodes, as Successor Trustee of the Jane Rhodes Butt Living Trust dated 11-07-95; Robert Hicks; Elizabeth Diaz; William Hicks; Virginia Massey Daniels; Virginia A. D. Richards; Olive J. D. Poe; Cynthia A. Hunt; Edwin C. Hunt; Prince Petroleum Company, Ltd.; Anthony Energy, Ltd.; PANAN Energy, Inc.; VML Resources, Inc.; Frost Bank, Successor Trustee of the Mary Leonard Children's Trust 75-6412990; JP Morgan Chase Bank, N.A., Trustee of the Miranda Leonard Revocable Trust 75-6356886; Frost Bank, Successor Trustee of the Martha Leonard Revocable Trust 75-6356886; Madelon L. Bradshaw; Frost Bank, Successor Trustee of the Miranda Leonard Trust III; Frost Bank, Successor Trustee of the Martha Leonard Trust III; Frost Bank, Successor Trustee of the Madelon Leonard Trust III
TRACT 36
 Township 145 North, Range 87 West Section 32: W½SW¼, less an 18.67 acre tract
SURFACE OWNERSHIP: The Coteau Properties Company
COAL OWNERSHIP: United States of America – Bureau of Land Management
TRACT 36-A
 Township 145 North, Range 87 West Section 32: An 18.67 acre tract lying within the W½SW¼
SURFACE OWNERSHIP: Basin Electric Power Cooperative
COAL OWNERSHIP: United States of America – Bureau of Land Management
TRACT 41
 Township 145 North, Range 88 West Section 3: Lot 3, SE¼NW¼
SURFACE OWNERSHIP: The Coteau Properties Company
COAL OWNERSHIP: The Coteau Properties Company
TRACT 42
 Township 145 North, Range 88 West Section 3: E½ of Lot 4, E½SW¼NW¼
SURFACE OWNERSHIP: The Coteau Properties Company
COAL OWNERSHIP: The Coteau Properties Company
TRACT 43
 Township 145 North, Range 88 West Section 3: W½ of Lot 4, W½SW¼NW¼
SURFACE OWNERSHIP: The Coteau Properties Company
COAL OWNERSHIP: The Coteau Properties Company
TRACT 44
 Township 145 North, Range 88 West Section 3: N½SW¼
SURFACE OWNERSHIP: The Coteau Properties Company
COAL OWNERSHIP: The Coteau Properties Company
TRACT 45
 Township 145 North, Range 88 West Section 3: S½SW¼
SURFACE OWNERSHIP: North American Coal Royalty Company
COAL OWNERSHIP: The Coteau Properties Company
TRACT 46
 Township 145 North, Range 88 West Section 3: S½NW¼SE¼, SW¼SE¼, W½SE¼SE¼
SURFACE OWNERSHIP: The Coteau Properties Company
COAL OWNERSHIP: Lyle Eisenbeis and Kathy Eisenbeis; LaDawn R. Eisenbeis; Janice Gunsch; Leann Schafer; Todd Erickson; Scott Erickson; Donlyn J. Erickson; LeRoy Bauer; Sandra Navratil; Donald S. Krenzle; Jodi L. Gilbert; Ryan J.

Krenzle; Marvin L. Bauer and Joyce M. Bauer, Life Estate, Remaindermen: Jessica Smith, Brent Bauer; Shelley Giese; Clyde T. Eisenbeis; Jodn D. Crabtree and Joann K. Crabtree, Trustees of the Crabtree Revocable Living Trust; Allen J. Eisenbeis
TRACT 48
 Township 145 North, Range 88 West Section 4: Lots 1, 2, S½NE¼, N½SE¼, less 4.427 acres in the NE¼
SURFACE OWNERSHIP: The Coteau Properties Company
COAL OWNERSHIP: United States of America – Bureau of Land Management
TRACT 48-A
 Township 145 North, Range 88 West Section 4: 4.427 acres in the NE¼
SURFACE OWNERSHIP: The Coteau Properties Company
COAL OWNERSHIP: United States of America – Bureau of Land Management
TRACT 49
 Township 145 North, Range 88 West Section 4: Lots 3, 4, S½NW¼
SURFACE OWNERSHIP: Karen A. Walz, Life Estate, Remaindermen: Denise Leighty, Corey Walz, Craig Walz, Brian Walz
COAL OWNERSHIP: United States of America – Bureau of Land Management
TRACT 51
 Township 145 North, Range 88 West Section 4: S½SW¼
SURFACE OWNERSHIP: Karen A. Walz, Life Estate, Remaindermen: Denise Leighty, Corey Walz, Craig Walz, Brian Walz
COAL OWNERSHIP: United States of America – Bureau of Land Management
TRACT 52
 Township 145 North, Range 88 West Section 4: S½SE¼
SURFACE OWNERSHIP: North American Coal Royalty Company
COAL OWNERSHIP: United States of America
TRACT 53
 Township 145 North, Range 88 West Section 9: NE¼
SURFACE OWNERSHIP: The Coteau Properties Company
COAL OWNERSHIP: Susan Elaine Mckig, Successor Trustee of the Eloise McKig Trust dated 05-30-80
TRACT 54
 Township 145 North, Range 88 West Section 9: W½
SURFACE OWNERSHIP: Darnell Boeckel
COAL OWNERSHIP: Darnell Boeckel; Estate of Joanne Virginia Trinkle; Karen Olivia Van Amburg, aka Karen Van Amburg; Inez Arman, Life Estate, Remaindermen: Brian Francis Arman; Janis S. Ritter; Harold I. Stuart, Jr.; Estate of Gotthilf Kruckenberg, Deceased; North American Coal Royalty Company
TRACT 55
 Township 145 North, Range 88 West Section 9: SE¼
SURFACE OWNERSHIP: The Coteau Properties Company
COAL OWNERSHIP: Perry P. Walker; Danny L. Walker; Albert L. Boeckel; Doris Beckman; Bruce Winkler; Randy Winkler; Milton Curtis; Merlon Curtis; Mark Curtis; Loretta R. Campio; Loren Neubauer; Kathy Neubauer
TRACT 56
 Township 145 North, Range 88 West Section 10: N½
SURFACE OWNERSHIP: The Coteau Properties Company
COAL OWNERSHIP: United States of America – Bureau of Land Management
TRACT 57
 Township 145 North, Range 88 West Section 10: S½
SURFACE OWNERSHIP: The Coteau Properties Company
COAL OWNERSHIP: United States of America – Bureau of Land Management
TRACT 58
 Township 145 North, Range 88 West Section 11: W½NE¼
SURFACE OWNERSHIP: The Coteau Properties Company
COAL OWNERSHIP: Milton Ost
TRACT 59
 Township 145 North, Range 88 West Section 11: NW¼
SURFACE OWNERSHIP: The Coteau Properties Company
COAL OWNERSHIP: Walter Ricker, as Trustee UTD dated 06-04-91 of the Walter Ricker Trust; Estate of Ellie Dassing; Hanna Link; Clyde Eisenbeis; JoAnn Crabtree; Allen Eisenbeis; North Dakota Department of Trust Lands
TRACT 60
 Township 145 North, Range 88 West Section 11: SW¼
SURFACE OWNERSHIP: The Coteau Properties Company
COAL OWNERSHIP: Jacqueline M. Baglivio; Debra Morast and Dean K. Morast, Trustees, or their Successors in Trust, under the Debra Morast Living Trust dated 03-24-14; Lori Clark; Violet D. Schnaidt, Life Estate, Remaindermen: Susan L. Hoepfner and Gregory R. Hoepfner; Larry Keller; Wilbur Elder
TRACT 61
 Township 145 North, Range 88 West

Section 11: SE¼
SURFACE OWNERSHIP: The Coteau Properties Company
COAL OWNERSHIP: Gilbert C. Ost and Violet V. Ost; Wendy Feeney; Tracy L. Miller; Orville M. Erickson; The Walke Limited Partnership; Sailor K. Skipper Trust; M. W. Rambo Family Trust; Faye Gibbons Landham; Katie Gibbons Nielsen; Rex Farrall; Leila Claire Parnell Summerville; William Reagin Parnell; Jennifer P. Tidmore; Estate of Jack Skipper; Caroline Skipper Hollins; Legrande Kelly Skipper; Evelyn June Florey; A. E. Besch Legacy, L.P.; MKCDM Minerals, LLC; Judgment Cable Enterprises, LLC; Michael Charles Dunn; Skipdunn, L.P.; Estate of Mary Hughes Davidson; Fortin Enterprises, Inc.; Hancock Enterprises; The Sater Family Partnership, L.P.; Michael E. Rudman, Trustee of the MR Trust; Phoenix Capital Group Holdings, LLC; Williams Properties, Inc.
TRACT 62
 Township 145 North, Range 88 West Section 14: Sublot 1 in the NE¼, containing 16.07 acres
SURFACE OWNERSHIP: The Coteau Properties Company
COAL OWNERSHIP: United States of America – Bureau of Land Management
TRACT 63
 Township 145 North, Range 88 West Section 14: N½, less Sublot 1 in the NE¼
SURFACE OWNERSHIP: The Coteau Properties Company
COAL OWNERSHIP: United States of America – Bureau of Land Management
TRACT 64
 Township 145 North, Range 88 West Section 14: SW¼
SURFACE OWNERSHIP: The Coteau Properties Company
COAL OWNERSHIP: United States of America – Bureau of Land Management
TRACT 65
 Township 145 North, Range 88 West Section 14: S½SE¼
SURFACE OWNERSHIP: Basin Electric Power Cooperative
COAL OWNERSHIP: United States of America – Bureau of Land Management
TRACT 65-A
 Township 145 North, Range 88 West Section 14: N½SE¼
SURFACE OWNERSHIP: The Coteau Properties Company
COAL OWNERSHIP: United States of America – Bureau of Land Management
TRACT 66
 Township 145 North, Range 88 West Section 15: NE¼
SURFACE OWNERSHIP: The Coteau Properties Company
COAL OWNERSHIP: Jacqueline M. Baglivio; Debra Morast and Dean K. Morast, Trustees, or their Successors in Trust, under the Debra Morast Living Trust dated 03-24-14; Lori Clark; Violet D. Schnaidt, Life Estate, Remaindermen: Susan L. Hoepfner and Gregory R. Hoepfner; Larry Keller; Wilbur Elder
TRACT 67
 Township 145 North, Range 88 West Section 15: W½
SURFACE OWNERSHIP: The Coteau Properties Company
COAL OWNERSHIP: Jacqueline M. Baglivio; Debra Morast and Dean K. Morast, Trustees, or their Successors in Trust, under the Debra Morast Living Trust dated 03-24-14; Lori Clark; Violet D. Schnaidt, Life Estate, Remaindermen: Susan L. Hoepfner and Gregory R. Hoepfner; Larry Keller; Wilbur Elder; Robert M. Clement; Jon and Jonah David Clement; Mark Mead; Robin Zadzora
TRACT 68
 Township 145 North, Range 88 West Section 15: SE¼
SURFACE OWNERSHIP: The Coteau Properties Company
COAL OWNERSHIP: Linda Carrie Dietrich
TRACT 69
 Township 145 North, Range 88 West Section 16: NE¼, N½SE¼
SURFACE OWNERSHIP: The Coteau Properties Company
COAL OWNERSHIP: North Dakota Department of Trust Lands
TRACT 70
 Township 145 North, Range 88 West Section 16: NW¼
SURFACE OWNERSHIP: North Dakota Department of Trust Lands
COAL OWNERSHIP: North Dakota Department of Trust Lands
TRACT 71
 Township 145 North, Range 88 West Section 16: N½SW¼
SURFACE OWNERSHIP: Mark Herrmann and Carol Herrmann
COAL OWNERSHIP: Mark Herrmann and Carol Herrmann; North Dakota Department of Trust Lands
TRACT 72
 Township 145 North, Range 88 West Section 16: S½SW¼
SURFACE OWNERSHIP: Tanner D. Reinhardt and Nancy M. Reinhardt
COAL OWNERSHIP: Joyce E. Larson Rhonda Marie Reinhardt, Life Estate, Remaindermen: Tanner D. Reinhardt; North Dakota Department of Trust Lands
TRACT 73

Township 145 North, Range 88 West Section 16: S½SE¼ SURFACE OWNERSHIP: Betty Scott; Dallas Crabtree; Denzel Crabtree COAL OWNERSHIP: North Dakota Department of Trust Lands TRACT 74 Township 145 North, Range 88 West Section 21: N½, SW¼ SURFACE OWNERSHIP: Betty Scott; Dallas Crabtree; Denzel Crabtree COAL OWNERSHIP: Betty Scott; Dallas Crabtree; Denzel Crabtree; Cecil Hagen; Lucille N. Hagen; Hembdt Catawba LLC; Catherine Kimbrel; Mary Ginung; Judy Alm Family Mineral Trust; Patricia Ann Cadwallader; Richard Keith Cadwallader; John E. Rooney and Marjorie K. Rooney, as Trustees under the terms of that Certain Trust Agreement dated 01-14-81; Eileen Rooney Hewgley and James M. Hewgley, Jr., as Trustees under the terms of that Certain Trust Agreement dated 11-02-81; Patrick T. Rooney, Timothy P. Rooney, James Harris Rooney, and L. F. Rooney III, as Co-Trustees under the Lucy T. Rooney 1992 GST Exempt Family Trusts under Trust Agreement dated 08-18-92; Patrick T. Rooney, Timothy P. Rooney, James Harris Rooney, and L. F. Rooney III, as Co-Trustees of the Patrick T. Rooney Trust created by the Lucy T. Rooney 1992 GST Exempt Family Trusts under Trust Agreement dated 08-18-92; Patrick T. Rooney, Timothy P. Rooney, James Harris Rooney, and L. F. Rooney III, as Co-Trustees of the Timothy P. Rooney Trust created by the Lucy T. Rooney 1992 GST Exempt Family Trusts under Trust Agreement dated 08-18-92; Patrick T. Rooney, Timothy P. Rooney, James Harris Rooney, and L. F. Rooney III, as Co-Trustees of the Rebecca Finch Rooney Trust created by the Lucy T. Rooney 1992 GST Exempt Family Trusts under Trust Agreement dated 08-18-92; Patrick T. Rooney, Timothy P. Rooney, James Harris Rooney, and L. F. Rooney III, as Co-Trustees of the Rebecca Finch Rooney Trust created by the Lucy T. Rooney 1992 GST Exempt Family Trusts under Trust Agreement dated 08-18-92 TRACT 75 Township 145 North, Range 88 West Section 21: SE¼ SURFACE OWNERSHIP: Karen A. Walz, Life Estate, Remaindermen: Denise Leighty, Corey Walz, Craig Walz, Brian Walz COAL OWNERSHIP: Valerie Crump; Craig Beck; Milda Randall; AgriBank,FCB TRACT 76 Township 145 North, Range 88 West Section 22: 286.7 acres located in the N½ SURFACE OWNERSHIP: The Coteau Properties Company COAL OWNERSHIP: United States of America - Bureau of Land Management TRACT 77 Township 145 North, Range 88 West Section 22: N½, SW¼; less and except the following: 2.96 acres located within the SW¼, 286.70 acres located within the N½, and 23.25 acres located within the E½SW¼ SURFACE OWNERSHIP: Karen A. Walz, Life Estate, Remaindermen: Denise Leighty, Corey Walz, Craig Walz, Brian Walz COAL OWNERSHIP: United States of America - Bureau of Land Management TRACT 78 Township 145 North, Range 88 West Section 22: 14.17 acres, 2.96 and 23.25 acres located in the SW¼ SURFACE OWNERSHIP: Chance Wilhelm COAL OWNERSHIP: United States of America - Bureau of Land Management TRACT 79 Township 145 North, Range 88 West Section 22: SE¼ SURFACE OWNERSHIP: The Coteau Properties Company COAL OWNERSHIP: United States of America - Bureau of Land Management TRACT 80 Township 145 North, Range 88 West Section 23: E½E½NE¼ SURFACE OWNERSHIP: Basin Electric Power Cooperative COAL OWNERSHIP: Elsie Gilbertson; Elsie Gilbertson, Life Estate, Remaindermen: Robyn Wonnberg, as Trustee of the Elsie M. Gilbertson Family Mineral Trust; Irma Bitner TRACT 81 Township 145 North, Range 88 West Section 23: NW¼, W½NE¼ SURFACE OWNERSHIP: Irma Bitner, Life Estate, Remaindermen: Mark Bitner, Robyn Wonnberg, Brian Bitner, Keith Bitner, Sara Ames COAL OWNERSHIP: Elsie Gilbertson; Elsie Gilbertson, Life Estate, Remaindermen: Robyn Wonnberg, as Trustee of the Elsie M. Gilbertson Family Mineral Trust; Irma Bitner, Life Estate, Remaindermen: Mark Bitner, Robyn Wonnberg, Brian Bitner, Keith Bitner, Sara Ames TRACT 82 Township 145 North, Range 88 West Section 23: SW¼ SURFACE OWNERSHIP: Basin Electric Power Cooperative COAL OWNERSHIP: Clayton Boeckel and Diane Boeckel; Clayton Boeckel; Leon Boeckel; Estate of LeRoy L. Boeckel; Melvin Boeckel; Peggy Becker; Darlene Harris; Sharon Rose Chadwick; Brian Henry Hess; Karen Rose Hess; Marles J. Hess; Dean Kautzman; Michael K. Kautzman; Kathleen Fay Thorson; Carroll George Weiss; Thomas Robert Weiss; Douglas A. Weiss; Nancy Ellen Bauer; Christopher Thorson; Corey Thorson; Kayleen Davie; Jaron Jacob Bauer; Kelly Joseph Bauer; Christopher George Weiss; Jessica M. Clark; Shari L. Weiss; Alyssa S. Conner; Kayla M. Weiss; Kerri L. Weiss; Keith Weiss; Lynette D. Weiss; Debra Weiss Papka; Gary Weiss; Lorri Weiss; Kermit D. Stevens; Theodore J. Weiss; Theodore J. Weiss and Barbara Jean Weiss; Brenda Kay Fake; Brian Fake; Lyle D. Weiss; Randall T. Weiss and Rhona S. Weiss, as Co-Trustees of the Weiss Family Living Trust dated 05-28-08 TRACT 83 Township 145 North, Range 88 West Section 23: SE¼ SURFACE OWNERSHIP: Basin Electric Power Cooperative COAL OWNERSHIP: The Coteau Properties Company TRACT 84 Township 145 North, Range 88 West Section 25: NW¼, S½ SURFACE OWNERSHIP: Dakota Gasification Company COAL OWNERSHIP: Tammy Moore; Leeta Olin; Gary Boeckel; Irene Fischer; Fay Horn; Velvet Beck; Larry D. Morast; Dustin Morast; Brittney Smith; Nagoshia Gangli; Colton Mohl; Sharon Nieuwsma; Ron Hausauer; Monty Jonathon Reub; Pamela Sue Helm; Romy Edmond Reub; Fern Schlender; Gaylen Boeckel; Ruby Emter TRACT 85 Township 145 North, Range 88 West Section 26: NE¼NE¼ SURFACE OWNERSHIP: The Coteau Properties Company COAL OWNERSHIP: United States of America - Bureau of Land Management TRACT 86 Township 145 North, Range 88 West Section 26: W½NE¼, SE¼NW¼, NE¼SW¼, S½SW¼ SURFACE OWNERSHIP: The Coteau Properties Company COAL OWNERSHIP: United States of America - Bureau of Land Management TRACT 87 Township 145 North, Range 88 West Section 26: N½NW¼, SW¼NW¼, NW¼SW¼ SURFACE OWNERSHIP: The Coteau Properties Company COAL OWNERSHIP: United States of America - Bureau of Land Management TRACT 88 Township 145 North, Range 88 West Section 26: NW¼SE¼ SURFACE OWNERSHIP: The Coteau Properties Company COAL OWNERSHIP: United States of America - Bureau of Land Management TRACT 89 Township 145 North, Range 88 West Section 26: SE¼NE¼, NE¼SE¼, S½SE¼ SURFACE OWNERSHIP: Dakota Gasification Company COAL OWNERSHIP: Tammy Moore; Leeta Olin; Gary Boeckel; Irene Fischer; Fay Horn; Velvet Beck; Larry D. Morast; Dustin Morast; Brittney Smith; Nagoshia Gangli; Colton Mohl; Sharon Nieuwsma; Ron Hausauer; Monty Jonathon Reub; Pamela Sue Helm; Romy Edmond Reub; Fern Schlender; Gaylen Boeckel; Ruby Emter; Harvey Svec; Bertha Harper; Helen Johnson; Jane Morrison; Estate of Robert Morrison; June Schultek; Janice McLean; Black Stone Minerals Company, LP; PAL Properties, Inc. TRACT 90 Township 145 North, Range 88 West Section 27: NE¼ SURFACE OWNERSHIP: The Coteau Properties Company COAL OWNERSHIP: Donna Bauer; Jeff Bauer; Jason Bauer; Valerie Bauman; Victoria Charpentier; Vance Herman; Vernon Herman; Curtis Herman; Cory Herman; James John Bauer; Tracy L. Siemienieski and Jessica R. Sollin; Gerald D. Bieber; Douglas Arthur Bieber; Dale R. Bauer

Elsie M. Gilbertson Family Mineral Trust; Irma Bitner, Life Estate, Remaindermen: Mark Bitner, Robyn Wonnberg, Brian Bitner, Craig Bitner, Keith Bitner, Sara Ames TRACT 81-A Township 145 North, Range 88 West Section 23: W½E½NE¼ SURFACE OWNERSHIP: The Coteau Properties Company Coteau for the Life of Irma Bitner, Remainderman to Brian Bitner COAL OWNERSHIP: Elsie Gilbertson; Elsie Gilbertson, Life Estate, Remaindermen: Robyn Wonnberg, as Trustee of the Elsie M. Gilbertson Family Mineral Trust; Irma Bitner, Life Estate, Remaindermen: Mark Bitner, Robyn Wonnberg, Brian Bitner, Craig Bitner, Keith Bitner, Sara Ames TRACT 82 Township 145 North, Range 88 West Section 23: SW¼ SURFACE OWNERSHIP: Basin Electric Power Cooperative COAL OWNERSHIP: Clayton Boeckel and Diane Boeckel; Clayton Boeckel; Leon Boeckel; Estate of LeRoy L. Boeckel; Melvin Boeckel; Peggy Becker; Darlene Harris; Sharon Rose Chadwick; Brian Henry Hess; Karen Rose Hess; Marles J. Hess; Dean Kautzman; Michael K. Kautzman; Kathleen Fay Thorson; Carroll George Weiss; Thomas Robert Weiss; Douglas A. Weiss; Nancy Ellen Bauer; Christopher Thorson; Corey Thorson; Kayleen Davie; Jaron Jacob Bauer; Kelly Joseph Bauer; Christopher George Weiss; Jessica M. Clark; Shari L. Weiss; Alyssa S. Conner; Kayla M. Weiss; Kerri L. Weiss; Keith Weiss; Lynette D. Weiss; Debra Weiss Papka; Gary Weiss; Lorri Weiss; Kermit D. Stevens; Theodore J. Weiss; Theodore J. Weiss and Barbara Jean Weiss; Brenda Kay Fake; Brian Fake; Lyle D. Weiss; Randall T. Weiss and Rhona S. Weiss, as Co-Trustees of the Weiss Family Living Trust dated 05-28-08 TRACT 83 Township 145 North, Range 88 West Section 23: SE¼ SURFACE OWNERSHIP: Basin Electric Power Cooperative COAL OWNERSHIP: The Coteau Properties Company TRACT 84 Township 145 North, Range 88 West Section 25: NW¼, S½ SURFACE OWNERSHIP: Dakota Gasification Company COAL OWNERSHIP: Tammy Moore; Leeta Olin; Gary Boeckel; Irene Fischer; Fay Horn; Velvet Beck; Larry D. Morast; Dustin Morast; Brittney Smith; Nagoshia Gangli; Colton Mohl; Sharon Nieuwsma; Ron Hausauer; Monty Jonathon Reub; Pamela Sue Helm; Romy Edmond Reub; Fern Schlender; Gaylen Boeckel; Ruby Emter TRACT 85 Township 145 North, Range 88 West Section 26: NE¼NE¼ SURFACE OWNERSHIP: The Coteau Properties Company COAL OWNERSHIP: United States of America - Bureau of Land Management TRACT 86 Township 145 North, Range 88 West Section 26: W½NE¼, SE¼NW¼, NE¼SW¼, S½SW¼ SURFACE OWNERSHIP: The Coteau Properties Company COAL OWNERSHIP: United States of America - Bureau of Land Management TRACT 87 Township 145 North, Range 88 West Section 26: N½NW¼, SW¼NW¼, NW¼SW¼ SURFACE OWNERSHIP: The Coteau Properties Company COAL OWNERSHIP: United States of America - Bureau of Land Management TRACT 88 Township 145 North, Range 88 West Section 26: NW¼SE¼ SURFACE OWNERSHIP: The Coteau Properties Company COAL OWNERSHIP: United States of America - Bureau of Land Management TRACT 89 Township 145 North, Range 88 West Section 26: SE¼NE¼, NE¼SE¼, S½SE¼ SURFACE OWNERSHIP: Dakota Gasification Company COAL OWNERSHIP: Tammy Moore; Leeta Olin; Gary Boeckel; Irene Fischer; Fay Horn; Velvet Beck; Larry D. Morast; Dustin Morast; Brittney Smith; Nagoshia Gangli; Colton Mohl; Sharon Nieuwsma; Ron Hausauer; Monty Jonathon Reub; Pamela Sue Helm; Romy Edmond Reub; Fern Schlender; Gaylen Boeckel; Ruby Emter; Harvey Svec; Bertha Harper; Helen Johnson; Jane Morrison; Estate of Robert Morrison; June Schultek; Janice McLean; Black Stone Minerals Company, LP; PAL Properties, Inc. TRACT 90 Township 145 North, Range 88 West Section 27: NE¼ SURFACE OWNERSHIP: The Coteau Properties Company COAL OWNERSHIP: Donna Bauer; Jeff Bauer; Jason Bauer; Valerie Bauman; Victoria Charpentier; Vance Herman; Vernon Herman; Curtis Herman; Cory Herman; James John Bauer; Tracy L. Siemienieski and Jessica R. Sollin; Gerald D. Bieber; Douglas Arthur Bieber; Dale R. Bauer

and Inez C. Bauer; Laurel Rathjen; Michelle Wolf; Harold Flath; Cary Wolf; Gayanne Anthony; Dawn Mamer; Maynard Wolf; Sylvia McClure; Nicholas E. Wolf; Elizabeth L. Wolf; Kenneth W. Meyer, Jr.; Virginia Tennant; Neal Wolf; Paula Emma Yates TRACT 91 Township 145 North, Range 88 West Section 27: NW¼ SURFACE OWNERSHIP: Allegra I. Boeckel and the Estate of LeRoy Boeckel COAL OWNERSHIP: Valerie Crump; Craig Beck; Milda Randall; Arnold T. Weiss and Regina Weiss; Caryn Y. Clements; Daniel W. Vanderhoof; Dennis L. Vanderhoof; Dean C. Vanderhoof; William G. Weiss; John J. Weiss; David J. Weiss; William O. Chapman; Lori K. Uhlig; Cheryl D. Hogle; Clinton D. Chapman; Deanna Chapman; Arnold Weiss; Carol Hartman; Joann Dilger; Marilyn Steuher; Jerome Weis; Delrae Holden, Life Estate, Remaindermen: Justin D. Weiss, Laine A. Anderson TRACT 92 Township 145 North, Range 88 West Section 27: W½SW¼ SURFACE OWNERSHIP: Levi Dennis Flemmer COAL OWNERSHIP: Donnie Dschaak TRACT 93 Township 145 North, Range 88 West Section 27: E½SW¼ SURFACE OWNERSHIP: Levi Dennis Flemmer COAL OWNERSHIP: Alverna Sasse, Life Estate, Remainderman: The Coteau Properties Company; The Coteau Properties Company TRACT 94 Township 145 North, Range 88 West Section 27: SE¼ SURFACE OWNERSHIP: The Coteau Properties Company COAL OWNERSHIP: Clayton Boeckel; Estate of LeRoy L. Boeckel; Melvin Boeckel; Peggy Becker; Darlene Harris; Sharon Rose Chadwick; Brian Henry Hess; Karen Rose Hess; Marles J. Hess; Barbara G. Shimer, as Trustee of the Shari R. Weber Trust dated 08-10-08; Brehm Investment Group Inc.; Flying Wolf Enterprises Inc.; Wildcat Investments Corporation; Maria T. Keith; Gary Myles Keith; Janee Lee Keith Bueche; Greenstar Resources, L.L.C.; Barbara Rinehart Stortum; Jasmine Properties, LLC; Curtis Bennett; Elizabeth Mertz; Paul Bennett; Marilyn Bennett Alexander; Carolyn Dutzi; Teresa Frese McMahon; Betty Eileen Ferrel, Life Estate, Remaindermen: Rikki P. Doyle, Marcy P. Stacy; Timothy J. Pulliam, Trustee of the Timothy J. Pulliam Family Legacy Trust, dated 12-14-17; Fortin Enterprises, Inc.; Hancock Enterprises TRACT 95 Township 145 North, Range 88 West Section 28: E½NE¼, SW¼NE¼ SURFACE OWNERSHIP: Clyde C. Mittelsteadt and Cheryl Mittelsteadt COAL OWNERSHIP: United States of America - Bureau of Land Management TRACT 96 Township 145 North, Range 88 West Section 28: NW¼NE¼ SURFACE OWNERSHIP: Clyde C. Mittelsteadt and Cheryl Mittelsteadt COAL OWNERSHIP: AgriBank, FCB; Lisa Dowling Fuller; EPEC OCS Company; North Central Oil Corporation; W. C. Fritz; WLK Resources, LLC; Estate of Joanne Virginia Trinkle; Karen Olivia Amburg, Life Estate, Remaindermen: Jana Van Amburg and Mathew Van Amburg; Inez Arman, Life Estate, Remainderman: Brian Francis Arman; T. N. Jordan TRACT 97 Township 145 North, Range 88 West Section 28: N½NW¼, SW¼NW¼ SURFACE OWNERSHIP: Hertha Mittelsteadt, Life Estate, Remaindermen: Clyde C. Mittelsteadt and Cheryl Mittelsteadt COAL OWNERSHIP: AgriBank, FCB; Lisa Dowling Fuller; EPEC OCS Company; North Central Oil Corporation; W. C. Fritz; WLK North Dakota, LLC; Estate of Joanne Virginia Trinkle; Karen Olivia Amburg, Life Estate, Remaindermen: Jana Van Amburg and Mathew Van Amburg; Inez Arman, Life Estate, Remainderman: Brian Francis Arman; T. N. Jordan TRACT 98 Township 145 North, Range 88 West Section 28: SE¼NW¼, S½ SURFACE OWNERSHIP: Hertha Mittelsteadt, Life Estate, Remaindermen: Clyde C. Mittelsteadt and Cheryl Mittelsteadt COAL OWNERSHIP: United States of America - Bureau of Land Management TRACT 99 Township 145 North, Range 88 West Section 33: NE¼ SURFACE OWNERSHIP: Levi Dennis Flemmer COAL OWNERSHIP: Donnie Dschaak; Alverna Sasse, Life Estate, Remainderman: The Coteau Properties Company TRACT 100 Township 145 North, Range 88 West Section 33: NW¼, SW¼ SURFACE OWNERSHIP: Keshia Flemmer COAL OWNERSHIP: Donnie Dschaak TRACT 101

Township 145 North, Range 88 West Section 33: SE¼ SURFACE OWNERSHIP: The Coteau Properties Company COAL OWNERSHIP: Donnie Dschaak TRACT 102 Township 145 North, Range 88 West Section 34: N½N½, SE¼NE¼, NE¼SE¼, S½SE¼ SURFACE OWNERSHIP: The Coteau Properties Company COAL OWNERSHIP: United States of America - Bureau of Land Management TRACT 103 Township 145 North, Range 88 West Section 34: SW¼NE¼, NW¼SE¼, S½NW¼ SURFACE OWNERSHIP: The Coteau Properties Company COAL OWNERSHIP: Estate of Alvin J. Wittmaier; Patricia Ertresvaag; Steve Sieler; Patricia Ertresvaag and Steve Sieler, Co-Trustees of the James Wittmaier Trust dated 10/09/1996 TRACT 104 Township 145 North, Range 88 West Section 34: SW¼ SURFACE OWNERSHIP: The Coteau Properties Company COAL OWNERSHIP: United States of America - Bureau of Land Management TRACT 105 Township 145 North, Range 88 West Section 35: NE¼ SURFACE OWNERSHIP: The Coteau Properties Company COAL OWNERSHIP: Janell Reich; Jaylin N. Allen; Philip P. Pearson; Alvin E. Pearson; Lester D. Pearson; Michael Forrest Esson; Adeline I. Ross; Beverly J. Bement; Karen S. Hess; Loren Doffee; Danny Doffee; Darlene Neubauer; The Revocable Living Trust of Betty Doffee MacDonald dated 09-02-09; Delilah Mae Ledford; Larry L. Doffee; Carol Ann Pahde; Candace Elizabeth Barker; Alan Doffee; Vernon L. Doffee; Darlene Doffee Looper; Brenda Doffee Urps; Kenneth B. Doffee; Thomas C. Doffee; Black Stone Minerals Company, L.P.; PAL Properties, Inc. TRACT 106 Township 145 North, Range 88 West Section 35: W½ SURFACE OWNERSHIP: The Coteau Properties Company COAL OWNERSHIP: Philip P. Pearson; Alvin E. Pearson; Lester D. Pearson; Michael Forrest Esson; Adeline I. Ross; Beverly J. Bement; Karen S. Hess; Loren Doffee; Danny Doffee; Darlene Neubauer; The Revocable Living Trust of Betty Doffee MacDonald dated 09-02-09; Delilah Mae Ledford; Larry L. Doffee; Carol Ann Pahde; Candace Elizabeth Barker; Alan Doffee; Vernon L. Doffee; Darlene Doffee Looper; Brenda Doffee Urps; Kenneth B. Doffee; Thomas C. Doffee; Black Stone Minerals Company, L.P.; PAL Properties, Inc. TRACT 107 Township 145 North, Range 88 West Section 35: SE¼ SURFACE OWNERSHIP: The Coteau Properties Company COAL OWNERSHIP: The Coteau Properties Company; Philip P. Pearson; Alvin E. Pearson; Lester D. Pearson; Loren Doffee; Danny Doffee; Michael Forrest Esson; Adeline I. Ross; Beverly J. Bement; Karen S. Hess; Darlene Neubauer; The Revocable Living Trust of Betty Doffee MacDonald dated 09-02-

09; Delilah Mae Ledford; Larry L. Doffee; Carol Ann Pahde; Candace Elizabeth Barker; Alan Doffee; Vernon L. Doffee; Darlene Doffee Looper; Brenda Doffee Urps; Kenneth B. Doffee; Thomas C. Doffee; Lois Fifer and Robert Dale Fifer; Lyle Herman and Peggy Ann Herman; Lora Saylor and Michael C. Saylor; Ami Lonsinger; Jeffrey Reich; Teri Lewis; Karen Reich; Janell Reich; Jaylin N. Brewer; Estate of Marva Kovalenko; Hope Smith; Virginia Scheurer; Philip Veazey Hopkins Irrevocable Trust U/D Dated 05-27-94; Frank Hervey III; Michael P. Eckenwiler; Matthew Wayne Eckenwiler; Michelle Eckenwiler McGregor; Lone Pine, L.L.C.; Jerome Max Westheimer, Jr., Trustee of the Jerome Max Westheimer, Jr. Trust dated 04-13-88; Joel F. Wellnitz; Christian O'Donnell; C. Carson See; Gordon L. Castleman and Estate of Nancy C. Castleman, Deceased; Gila Group LP; Trumbull Oil Properties LLC; David McHugh; Merco of Oklahoma, Inc.; Estate of Dr. R. F. Beauchamp; Kirk M. Campbell and Douglas I. Campbell, as Co-Trustees of the Robert and Margery Campbell Family Trust dated 11-01-88; Greenstar Resources, LLC; Roger L. Beavers, Inc.; Bear Creek Energy, LLC; John Mark Waugh, Trustee of the John Mark Waugh Trust; Vicki Waugh Eidman, Trustee of the Vicki Waugh Eidman Trust; H. B. Brown, Deceased; Jones-Daube Mineral Company TRACT 108 Township 145 North, Range 88 West Section 36: All SURFACE OWNERSHIP: North Dakota Department of Trust Lands COAL OWNERSHIP: North Dakota Department of Trust Lands TRACT 109 Township 145 North, Range 88 West Section 11: E½NE¼ SURFACE OWNERSHIP: The Coteau Properties Company COAL OWNERSHIP: The Coteau Properties Company; XTO Energy, Inc.; Michael E. Rudman, Trustee of the MR Trust; Tara Rudman Revocable Trust; Peter M. Young and Tachina Rudman-Young Revocable Trust; The Sater Family Partnership, L.P.; Hancock Enterprises, Inc.; Fortin Enterprises, Inc. A copy of Revision 28 to Permit NACT-0201 is available for public inspection at the office of the North Dakota Public Service Commission, 600 East Boulevard Avenue, Department 408, Bismarck, North Dakota 58505-0480, and at the office of the County Auditor, Mercer County Courthouse, Stanton, North Dakota 58571. Written comments, objections, or requests for an informal conference on the revision may be submitted by any person with an interest that is or may be adversely affected, to the North Dakota Public Service Commission, 600 East Boulevard Avenue, Department 408, Bismarck, North Dakota 58505-0480, within 30 days after the last publication of this notice. Any request for informal conference must be in writing to the Commission. The request must also state specifically the issues or objections that an affected party has regarding the revision. The Coteau Properties Company 204 County Road 15 Beulah, North Dakota 58523 (01-18-2024)(01-25-2024) (02-01-2024)(02-08-2024)

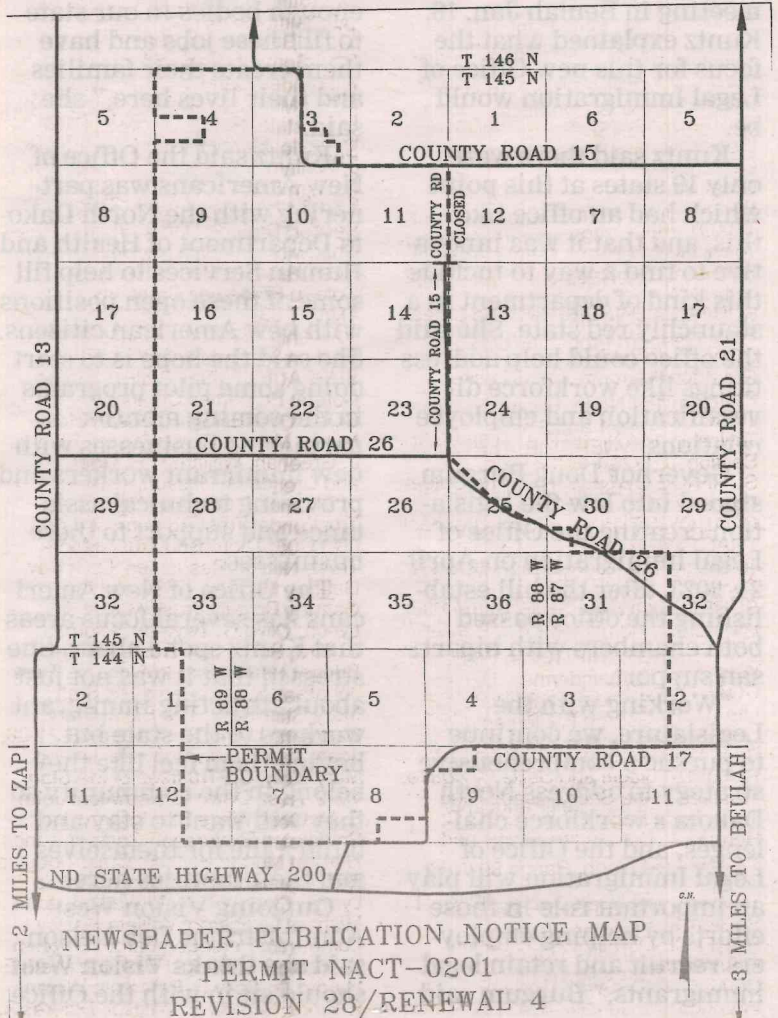

NEWSPAPER PUBLICATION NOTICE MAP PERMIT NACT-0201 REVISION 28/RENEWAL 4