

**Thompson, Pamela J.**

---

**From:** no-reply@efilingmail.tylertech.cloud  
**Sent:** Wednesday, April 10, 2024 8:27 AM  
**To:** Thompson, Pamela J.  
**Subject:** Filing Accepted for Case: 08-2024-CV-00694; Casey Voigt, et al. vs. North Dakota Public Service Commission, et al.; Envelope Number: 5616523

\*\*\*\*\* **CAUTION:** This email originated from an outside source. Do not click links or open attachments unless you know they are safe. \*\*\*\*\*

# Filing Accepted

Envelope Number: 5616523  
Case Number: 08-2024-CV-00694  
Case Style: Casey Voigt, et al. vs. North Dakota Public Service Commission, et al.



The filing below was reviewed and has been accepted by the clerk's office. You may access the file copy of the document filed by clicking on the below link.

Filing Details	
<b>Court</b>	Burleigh County
<b>Case Number</b>	08-2024-CV-00694
<b>Case Style</b>	Casey Voigt, et al. vs. North Dakota Public Service Commission, et al.
<b>Date/Time Submitted</b>	4/9/2024 4:32 PM CST
<b>Date/Time Accepted</b>	4/10/2024 8:27 AM CST
<b>Accepted Comments</b>	
<b>Filing Type</b>	Exhibit
<b>Filing Description</b>	CR Exhibit 21 - Exhibit 4 - COY-034 OB Sample Analyses
<b>Activity Requested</b>	EFileAndServe
<b>Filed By</b>	Pamela Thompson
<b>Filing Attorney</b>	John Schuh

Document Details	
<b>Lead Document</b>	CR Exhibit 21 - Exhibit 4 - COY-034 OB Sample Analyses.pdf
<b>Lead Document Page Count</b>	19
<b>File Copy</b>	<a href="#">View Document</a>

This link is active for 30 days. To access this document, you will be required to enter your email address. Click [here](#) for more information. If the link above is not accessible, copy this URL into your browser's address bar to view the document:

<https://northdakota.tylertech.cloud/ViewDocuments.aspx?FID=0656d0e8-2b34-401a-9c05-8440a129c96f>

For technical assistance, contact your service provider or  
North Dakota Court's Information Technology Department 701-328-4218  
Please do not reply to this email. It was automatically generated.

Casey and Julie Voigt v. Coyote Creek Mining Company, LLC

Case No. RC-23-348

COY-034 OB Sample Analyses

**Voigt Exhibit 4**

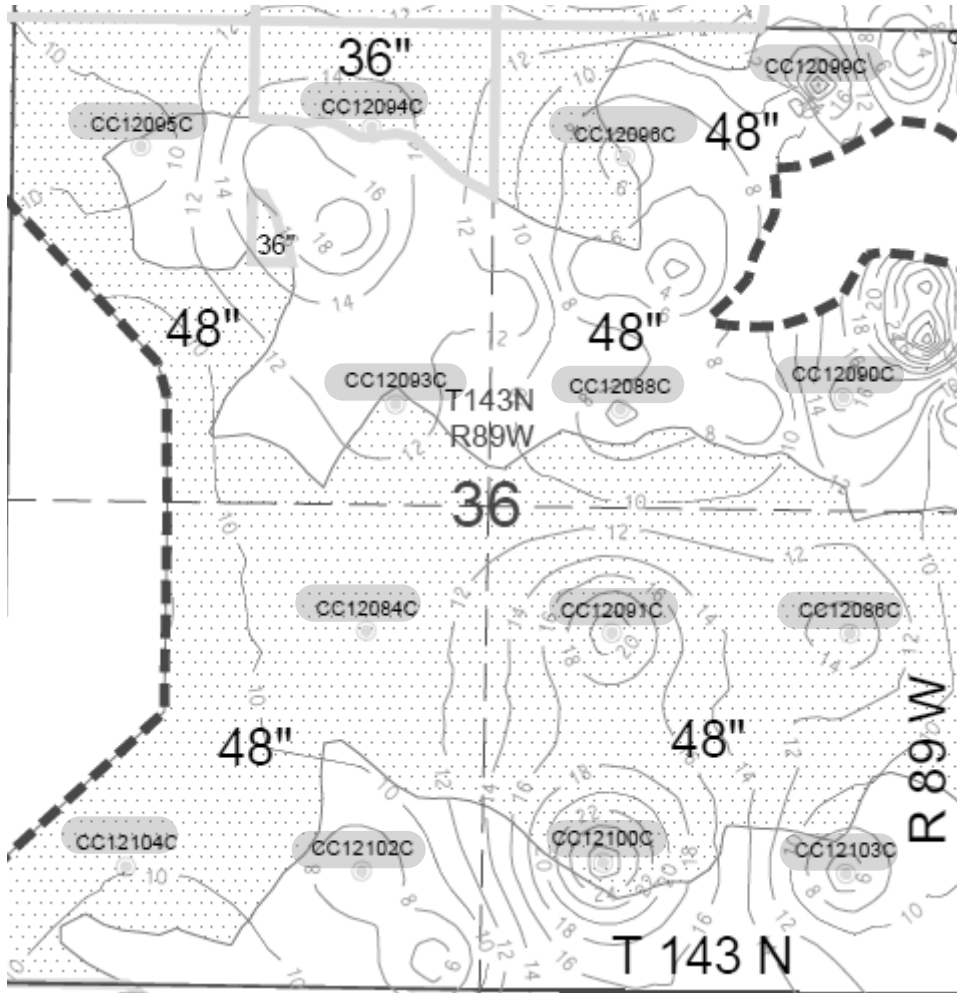



604 Highway 15 West  
P.O. Box 510  
Northwood, ND 58267

(701) 587-6010  
FAX (701) 587-6013

email: agvise@polarcomm.com  
Homepage: www.agvise.com

Coyote Creek  
204 County Rd 15  
Beulah, ND 58523

Date Sampled: 08/14/12  
Date Received: 08/07/12  
Date Reported: 01/21/13

Site: CC12095C

Corrected  
copy.  
ATTN: Kendra

<u>Ref#</u>	<u>Lab#</u>	<u>Depth</u>	<u>EC</u>	<u>Cat/EC</u>	<u>Ca</u>	<u>Mg</u>	<u>Na</u>	<u>SAR</u>	<u>pH</u>	<u>Texture</u>	<u>Sand</u>	<u>Silt</u>	<u>Clay</u>	<u>Sat. Percent</u>
14378581	49318	0-5	7.32	14.28	15.6	16.0	73.0	18.36	8.22	SILTY CLAY	13	44	43	206.5
14378582	49319	5-10	4.04	10.58	1.4	2.0	39.3	30.23	8.53	CLAY	13	26	61	184.2
14378583	49320	10-15	3.82	8.98	0.7	0.6	33.0	40.12	8.77	SILTY CLAY	11	42	47	139.6
14378584	49321	15-20	3.28	9.36	0.7	0.6	29.5	37.22	8.90	LOAM	36	43	21	101.4
14378585	49322	20-25	3.82	11.18	0.8	0.6	41.3	49.38	8.70	SILTY CLAY	10	47	43	130.8
14378586	49323	25-30	3.06	10.10	0.8	0.5	29.6	36.26	8.60	SILTY CLAY LOAM	14	47	39	118.1
14378587	49324	30-35	3.44	11.18	1.4	1.0	36.1	33.07	7.30	CLAY LOAM	26	35	39	103.5
14378588	49325	35-40	2.79	9.64	0.7	0.5	25.7	33.33	8.00	CLAY	19	28	53	112.2
14378589	49326	40-45	2.29	10.41	0.4	0.3	23.2	39.94	8.49	CLAY	11	28	61	126.2
14378590	49327	45-50	1.99	8.16	0.2	0.2	15.8	35.50	9.00	CLAY	16	39	45	143.8
14378591	49328	50-55	1.75	11.27	0.4	0.3	19.1	33.01	8.70	CLAY LOAM	32	33	35	124.8
14378592	49329	55-60	1.86	9.33	0.3	0.2	16.9	34.78	8.90	CLAY LOAM	28	41	31	124.8
14378593	49330	60-65	4.14	3.75	0.3	0.2	15.0	30.11	9.00	LOAM	44	33	23	107.4
14378594	49331	65-70	1.87	10.15	0.3	0.2	18.5	38.43	9.00	LOAM	36	41	23	102.1
14378595	49332	70-75	1.87	10.62	0.5	0.3	19.1	31.74	8.70	CLAY LOAM	34	37	29	103.7
14378596	49333	75-80	1.64	10.69	0.3	0.2	17.0	32.40	8.86	CLAY LOAM	33	32	35	116.7
14378597	49334	80-85	2.09	11.17	0.5	0.3	22.5	35.24	7.68	CLAY	39	14	47	112.6
14378598	49335	95.45-100.45	1.58	10.26	0.4	0.3	15.5	25.73	8.83	CLAY	21	36	43	109.9



604 Highway 15 West  
P.O. Box 510  
Northwood, ND 58267  
(701) 587-6010  
FAX (701) 587-6013  
email: agvise@polarcomm.com  
Homepage: www.agvise.com

Coyote Creek  
204 County Rd 15  
Beulah, ND 58523

Date Sampled: 08/14/12  
Date Received: 08/07/12  
Date Reported: 01/21/13

Site: CC12094C

<u>Ref#</u>	<u>Lab#</u>	<u>Depth</u>	<u>EC</u>	<u>Cat/EC</u>	<u>Ca</u>	<u>Mg</u>	<u>Na</u>	<u>SAR</u>	<u>pH</u>	<u>Texture</u>	<u>Sand</u>	<u>Silt</u>	<u>Clay</u>	<u>Sat. Percent</u>
14378141	49297	0-5	1.00	10.45	3.6	2.1	4.8	2.86	7.84	SANDY LOAM	75	14	11	26.3
14378142	49298	5-10	0.82	10.07	1.7	1.9	4.7	3.53	8.10	SANDY CLAY LOAM	61	18	21	35.5
14378143	49299	10-15	0.80	10.31	1.3	1.6	5.4	4.45	8.11	SANDY CLAY LOAM	47	24	29	48.3
14378144	49300	15-20	0.76	10.08	0.8	0.9	5.9	6.38	8.15	CLAY LOAM	37	28	35	61.7
14378145	49301	20-25	1.36	9.87	1.2	0.9	11.3	11.01	8.11	CLAY	19	26	55	85.3
14378146	49302	25-30	1.48	9.92	0.6	0.4	13.6	18.90	8.27	CLAY	37	14	49	68.8
14378147	49303	30-35	1.34	8.85	0.3	0.2	11.3	21.94	8.67	SILTY CLAY	17	42	41	89.0
14378148	49304	35-40	1.81	10.72	0.4	0.3	18.7	30.61	8.28	CLAY	29	30	41	75.9
14378149	49305	40-45	1.09	9.95	0.2	0.1	10.5	25.48	9.06	CLAY	15	38	47	121.0
14378150	49306	45-50	1.45	10.39	0.3	0.2	14.6	31.31	8.56	CLAY	17	32	51	97.1
14378151	49307	50-55	2.00	10.97	0.4	0.3	21.2	35.63	8.86	CLAY	29	22	49	106.2
14378152	49308	55-60	1.00	10.39	0.2	0.1	10.1	24.47	9.10	SILTY CLAY LOAM	19	44	37	120.9
14378153	49309	60-65	0.88	9.38	0.2	0.1	7.9	19.03	9.28	CLAY LOAM	21	44	35	140.1
14378154	49310	65-70	1.23	10.50	0.2	0.2	12.5	28.32	8.87	CLAY	17	40	43	132.9
14378155	49311	70-75	1.39	10.65	0.4	0.4	14.0	21.63	8.83	CLAY	21	38	41	133.9
14378156	49312	75-80	1.52	10.70	0.3	0.3	15.7	28.98	8.93	SILTY CLAY LOAM	19	46	35	118.7
14378157	49313	80-85	1.21	8.78	0.2	0.1	10.4	29.15	9.23	SANDY CLAY LOAM	63	16	21	115.5
14378158	49314	85-90	1.19	10.50	0.3	0.2	12.0	23.60	9.02	CLAY LOAM	39	32	29	101.1
14378159	49315	90-95	1.36	9.99	0.3	0.2	13.2	28.84	8.86	CLAY	23	36	41	118.7
14378160	49316	95-100.2	2.49	9.69	0.5	0.4	23.3	34.95	7.69	CLAY LOAM	43	18	39	91.2
14378161	49317	111-116	1.76	10.33	0.3	0.3	17.6	32.81	8.39	CLAY LOAM	27	34	39	124.5



604 Highway 15 West  
P.O. Box 510  
Northwood, ND 58267

(701) 587-6010  
FAX (701) 587-6013

email: agvise@polarcomm.com  
Homepage: www.agvise.com

Coyote Creek  
204 County Rd 15  
Beulah, ND 58523

Date Sampled: 08/15/12  
Date Received: 08/07/12  
Date Reported: 01/21/13

Site: CC12096C

<u>Ref#</u>	<u>Lab#</u>	<u>Depth</u>	<u>EC</u>	<u>Cat/EC</u>	<u>Ca</u>	<u>Mg</u>	<u>Na</u>	<u>SAR</u>	<u>pH</u>	<u>Texture</u>	<u>Sand</u>	<u>Silt</u>	<u>Clay</u>	<u>Sat. Percent</u>
14378401	49530	0-5	1.45	10.56	0.5	2.0	12.8	11.41	8.78	SILTY CLAY LOAM	17	49	34	83.8
14378402	49531	5-10	1.33	10.38	0.4	1.1	12.4	14.54	8.95	SILTY CLAY LOAM	15	49	36	97.2
14378403	49532	10-15	1.90	9.80	0.7	1.7	16.3	14.92	8.75	SILTY CLAY LOAM	17	43	40	101.2
14378404	49533	15-20	1.29	10.02	0.5	0.9	11.5	13.65	8.50	SILTY CLAY LOAM	17	44	39	99.5
14378405	49534	20-25	1.52	10.07	1.5	1.7	12.2	9.75	8.10	SILTY CLAY	10	45	45	93.0
14378406	49535	25-30	1.73	10.80	3.1	2.7	12.9	7.56	8.27	CLAY LOAM	20	45	35	65.2
14378407	49536	30-35	2.09	10.69	4.3	4.3	13.8	6.68	7.40	CLAY	20	29	51	64.2
14378408	49537	35-40	2.45	11.27	3.9	3.7	20.0	10.29	7.10	CLAY LOAM	26	41	33	69.7
14378409	49538	40-45	1.87	10.99	0.6	0.4	19.5	27.07	8.44	CLAY	31	28	41	88.0
14378410	49539	45-50	1.81	11.42	0.3	0.2	20.2	39.53	8.55	CLAY	13	40	47	129.7
14378411	49540	50-55	1.87	10.16	0.3	0.2	18.5	36.07	8.94	CLAY	3	29	68	132.0
14378412	49541	55-60	2.10	8.35	0.3	0.2	17.0	33.71	9.27	SILTY CLAY LOAM	17	49	34	124.3
14378413	49542	60-65	1.81	10.54	0.3	0.2	18.5	34.97	9.14	CLAY LOAM	23	45	32	121.8
14378414	49543	65-70	1.65	10.73	0.4	0.3	17.0	28.72	9.07	CLAY LOAM	20	43	37	104.2
14378415	49544	70-75	1.51	9.49	0.2	0.2	13.9	30.08	9.39	LOAM	38	35	27	110.9
14378416	49545	75-80	2.49	9.90	0.3	0.2	24.2	48.65	8.68	SILTY CLAY	10	41	49	118.0
14378417	49546	80-83.85	1.64	10.84	0.7	0.3	16.9	24.74	8.30	CLAY	16	25	59	127.1
14378418	49547	95-100	1.93	10.66	0.2	0.2	20.1	41.73	7.90	CLAY LOAM	25	36	39	85.3



604 Highway 15 West  
 P.O. Box 510  
 Northwood, ND 58267

(701) 587-6010  
 FAX (701) 587-6013

email: agvise@polarcomm.com  
 Homepage: www.agvise.com

Coyote Creek  
 204 County Rd 15  
 Beulah, ND 58523

Date Sampled: 08/16/12  
 Date Received: 08/07/12  
 Date Reported: 01/21/13

Site: CC12099C

<u>Ref#</u>	<u>Lab#</u>	<u>Depth</u>	<u>EC</u>	<u>Cat/EC</u>	<u>Ca</u>	<u>Mg</u>	<u>Na</u>	<u>SAR</u>	<u>pH</u>	<u>Texture</u>	<u>Sand</u>	<u>Silt</u>	<u>Clay</u>	<u>Sat. Percent</u>
14378101	49548	0-5	2.23	11.28	5.0	4.3	15.8	7.34	6.90	SANDY CLAY LOAM	54	23	23	43.8
14378102	49549	5-10	3.83	12.04	4.9	8.5	32.8	12.68	8.00	CLAY	32	27	41	70.6
14378103	49550	10-15	1.11	10.07	0.6	0.8	9.8	11.63	8.20	SILTY CLAY LOAM	14	47	39	96.4
14378104	49551	15-20	1.22	9.73	0.6	0.7	10.6	13.39	8.40	CLAY LOAM	32	33	35	103.7
14378105	49552	20-25	1.87	9.00	0.6	0.6	15.6	20.11	8.50	SILTY CLAY LOAM	16	45	39	118.2
14378106	49553	25-30	2.18	10.19	0.9	0.7	20.7	23.63	8.40	SILTY CLAY	8	43	49	116.5
14378107	49554	30-35.3	3.50	11.08	2.0	2.1	34.7	24.16	7.10	CLAY	28	15	57	104.5
14378108	49555	47.4-52.4	1.31	10.02	0.9	0.7	11.5	12.85	7.90	CLAY	12	31	57	73.6



604 Highway 15 West  
 P.O. Box 510  
 Northwood, ND 58267

(701) 587-6010  
 FAX (701) 587-6013

email: agvise@polarcomm.com  
 Homepage: www.agvise.com

Coyote Creek  
 204 County Rd 15  
 Beulah, ND 58523

Date Sampled: 08/14/12  
 Date Received: 08/07/12  
 Date Reported: 01/24/13

Site: CC12093C

<u>Ref#</u>	<u>Lab#</u>	<u>Depth</u>	<u>EC</u>	<u>Cat/EC</u>	<u>Ca</u>	<u>Mg</u>	<u>Na</u>	<u>SAR</u>	<u>pH</u>	<u>Texture</u>	<u>Sand</u>	<u>Silt</u>	<u>Clay</u>	<u>Sat. Percent</u>
14378471	49463	0-5	4.83	14.03	9.3	17.6	40.9	11.15	8.44	CLAY LOAM	38	23	39	55.7
14378472	49464	5-10	6.25	13.28	12.6	19.6	50.9	12.68	8.45	CLAY	30	29	41	73.9
14378473	49465	10-15	7.57	17.29	25.7	34.9	70.3	12.77	8.13	CLAY	20	29	51	80.9
14378474	49466	15-20	6.42	16.02	19.5	21.9	61.4	13.50	8.09	CLAY	6	25	69	98.0
14378475	49467	20-25	2.07	10.91	0.8	1.3	20.5	20.08	8.76	CLAY	2	21	77	155.2
14378476	49468	25-30	2.29	10.68	0.8	1.1	22.6	23.15	8.62	CLAY	2	25	73	160.2
14378477	49469	30-35	2.80	11.63	1.0	1.2	30.4	28.97	8.45	CLAY	12	33	55	142.5
14378478	49470	35-40	1.77	10.82	0.5	0.4	18.3	28.54	9.08	CLAY	10	35	55	185.8
14378479	49471	40-45	1.91	10.98	0.5	0.3	20.1	31.34	9.09	SILTY CLAY LOAM	12	55	33	118.0
14378480	49472	45-50	1.92	11.39	0.4	0.3	21.2	35.95	8.83	CLAY	10	33	57	119.3
14378481	49473	50-55	2.40	9.63	1.0	0.5	21.6	25.09	8.77	CLAY	8	37	55	114.8
14378482	49474	55-60	2.41	11.18	0.5	0.5	26.0	36.95	8.86	SILTY CLAY	4	49	47	122.1
14378483	49475	60-65	2.39	10.95	0.7	0.5	25.0	32.13	8.50	SILTY CLAY	10	47	43	108.2
14378484	49476	65-70	2.63	10.70	0.4	0.3	27.4	44.32	8.41	SILTY CLAY	12	43	45	113.1
14378485	49477	70-75	2.22	10.98	0.3	0.3	23.8	45.46	8.64	CLAY	6	37	57	108.1
14378486	49478	75-80	2.58	10.60	0.6	0.4	26.4	38.78	8.24	CLAY	12	31	57	131.0
14378487	49479	80-85	2.27	10.74	0.3	0.3	23.8	43.76	8.73	CLAY	20	31	49	107.1
14378488	49480	85-90	2.52	10.42	0.3	0.3	25.6	46.47	8.48	CLAY	14	25	61	111.9
14378489	49481	90-95	1.86	10.71	0.2	0.2	19.5	43.93	8.97	CLAY	12	37	51	146.0
14378490	49482	95-100	2.09	10.96	0.3	0.2	22.4	46.85	9.06	CLAY LOAM	32	35	33	112.4
14378491	49483	100-105	1.86	9.23	0.1	0.1	16.9	46.98	9.33	LOAM	40	33	27	117.5
14378492	49484	105-110	1.83	10.62	0.2	0.2	19.1	46.30	9.13	CLAY LOAM	26	43	31	110.4
14378493	49485	110-114.5	2.09	11.34	0.4	0.3	23.1	41.08	8.26	CLAY	32	13	55	110.1
14378494	49486	125.3-130.3	1.62	10.65	0.4	0.2	16.6	29.59	9.10	LOAM	38	37	25	76.4



604 Highway 15 West  
P.O. Box 510  
Northwood, ND 58267

(701) 587-6010  
FAX (701) 587-6013

email: agvise@polarcomm.com  
Homepage: www.agvise.com

Coyote Creek  
204 County Rd 15  
Beulah, ND 58523

Date Sampled: 08/13/12  
Date Received: 08/07/12  
Date Reported: 01/24/13

Site: CC12088C

<u>Ref#</u>	<u>Lab#</u>	<u>Depth</u>	<u>EC</u>	<u>Cat/EC</u>	<u>Ca</u>	<u>Mg</u>	<u>Na</u>	<u>SAR</u>	<u>pH</u>	<u>Texture</u>	<u>Sand</u>	<u>Silt</u>	<u>Clay</u>	<u>Sat. Percent</u>
14378421	49392	0-5	11.65	13.47	18.4	29.9	108.6	22.07	8.20	CLAY LOAM	40	23	37	98.78
14378422	49393	5-10	4.45	10.58	0.9	1.5	44.7	41.01	8.96	CLAY	2	33	65	149.6
14378423	49394	10-15	3.96	9.14	0.8	0.7	34.7	39.80	8.70	CLAY	16	29	55	146.2
14378424	49395	15-20	2.50	10.65	0.6	0.5	25.5	33.73	8.86	SILTY CLAY LOAM	12	49	39	124.2
14378425	49396	20-25	1.74	10.87	0.4	0.4	18.1	28.99	8.99	SILTY CLAY	6	51	43	125.0
14378426	49397	25-30	1.59	10.15	0.4	0.4	15.4	24.52	9.09	SILTY CLAY	9	47	44	127.4
14378427	49398	30-35	1.54	11.46	0.2	0.2	17.2	36.91	8.73	CLAY	14	21	65	131.6
14378428	49399	35-39.1	2.13	11.74	0.5	0.3	24.2	37.30	7.75	CLAY	24	11	65	119.4
14378429	49400	50-55	1.27	10.26	0.3	0.1	12.6	28.73	9.00	CLAY	15	36	49	115.8



604 Highway 15 West  
P.O. Box 510  
Northwood, ND 58267

(701) 587-6010  
FAX (701) 587-6013

email: agvise@polarcomm.com  
Homepage: www.agvise.com

Coyote Creek  
204 County Rd 15  
Beulah, ND 58523

Date Sampled: 08/13/12  
Date Received: 08/07/12  
Date Reported: 01/21/13

Site: CC12090C

<u>Ref#</u>	<u>Lab#</u>	<u>Depth</u>	<u>EC</u>	<u>Cat/EC</u>	<u>Ca</u>	<u>Mg</u>	<u>Na</u>	<u>SAR</u>	<u>pH</u>	<u>Texture</u>	<u>Sand</u>	<u>Silt</u>	<u>Clay</u>	<u>Sat. Percent</u>
14378381	49487	0-5	2.71	10.97	1.9	4.3	23.6	13.40	8.30	CLAY	29	24	47	90.6
14378382	49488	5-10	7.89	16.28	21.4	28.0	79.0	15.90	6.50	CLAY	17	22	61	77.6
14378383	49489	10-15	5.28	9.49	3.5	5.4	41.3	19.65	8.00	CLAY	14	31	55	101.7
14378384	49490	15-20	3.64	11.02	2.0	3.2	34.9	21.53	8.10	CLAY	14	33	53	127.5
14378385	49491	20-25	2.78	10.08	1.0	1.6	25.5	22.55	8.61	CLAY LOAM	35	33	32	127.0
14378386	49492	25-30	2.27	10.34	0.4	0.7	22.3	29.54	8.70	SANDY CLAY LOAM	58	17	25	92.3
14378387	49493	30-35	2.38	8.44	0.3	0.4	19.3	31.36	9.10	LOAM	41	37	22	99.1
14378388	49494	35-40	2.36	9.81	0.3	0.3	22.6	41.97	9.47	SANDY CLAY LOAM	57	21	22	95.8
14378389	49495	40-45	2.01	8.93	0.3	0.1	17.5	38.51	9.30	SANDY CLAY LOAM	65	14	21	85.2
14378390	49496	45-50	1.73	10.15	0.3	0.2	17.1	35.95	9.00	CLAY LOAM	25	38	37	114.8
14378391	49497	50-55	1.59	10.22	0.2	0.1	15.9	38.49	9.10	SILTY CLAY	15	42	43	125.7
14378392	49498	55-60	1.73	10.39	0.2	0.2	17.5	36.65	8.60	CLAY	15	14	71	126.5
14378393	49499	60-61.9	1.54	10.92	0.4	0.3	16.1	26.21	7.50	CLAY	24	11	65	118.5
14378394	49500	73-78	4.37	9.38	2.5	2.8	35.6	21.77	6.70	CLAY	26	19	55	85.4



604 Highway 15 West  
 P.O. Box 510  
 Northwood, ND 58267  
 (701) 587-6010  
 FAX (701) 587-6013  
 email: agvise@polarcomm.com  
 Homepage: www.agvise.com

Coyote Creek  
 204 County Rd 15  
 Beulah, ND 58523

Date Sampled: 08/02/12  
 Date Received: 08/07/12  
 Date Reported: 01/21/13

Site: CC12084C

<u>Ref#</u>	<u>Lab#</u>	<u>Depth</u>	<u>EC</u>	<u>Cat/EC</u>	<u>Ca</u>	<u>Mg</u>	<u>Na</u>	<u>SAR</u>	<u>pH</u>	<u>Texture</u>	<u>Sand</u>	<u>Silt</u>	<u>Clay</u>	<u>Sat. Percent</u>
14378431	49336	0-5	2.68	9.79	3.2	5.7	17.3	8.20	8.40	CLAY LOAM	40	25	35	55.2
14378432	49337	5-10	6.15	15.86	25.4	27.6	44.5	8.65	8.22	CLAY LOAM	38	23	39	60.7
14378433	49338	10-15	6.72	18.58	28.6	31.7	64.5	11.75	7.84	CLAY	20	39	41	85.6
14378434	49339	15-20	8.14	14.72	22.6	33.6	63.5	11.98	8.09	CLAY LOAM	36	33	31	76.7
14378435	49340	20-25	8.39	14.94	19.0	26.9	79.5	16.58	8.33	LOAM	36	39	25	61.2
14378436	49341	25-30	5.11	18.40	16.4	17.2	60.4	14.73	8.25	CLAY	22	37	41	129.5
14378437	49342	30-35	7.07	12.74	12.7	12.0	65.4	18.58	8.21	CLAY LOAM	44	25	31	122.0
14378438	49343	35-40	2.67	10.25	0.8	0.9	25.7	27.86	8.97	CLAY	6	31	63	225.5
14378439	49344	40-45	3.30	11.23	1.3	1.1	34.6	31.56	8.61	CLAY	10	19	71	172.3
14378440	49345	45-50	4.33	11.32	1.9	1.6	45.5	34.22	7.83	CLAY	16	33	51	98.9
14378441	49346	50-55	2.70	10.28	0.7	0.5	26.6	34.44	8.42	CLAY	6	17	77	129.5
14378442	49347	55-60	3.09	8.97	0.6	0.5	26.6	35.36	8.44	CLAY	8	19	73	150.9
14378443	49348	60-65	3.92	11.66	1.1	0.9	43.7	43.97	8.04	CLAY LOAM	26	37	37	94.9
14378444	49349	65-70	2.50	10.99	0.4	0.3	26.7	42.47	8.94	CLAY LOAM	30	41	29	119.2
14378445	49350	70-75	2.33	11.07	0.4	0.3	25.0	40.90	9.11	LOAM	42	33	25	105.7
14378446	49351	75-80	2.96	8.87	0.4	0.3	25.6	44.24	9.16	LOAM	34	45	21	96.1
14378447	49352	80-85	2.14	11.02	0.4	0.3	22.9	39.58	9.17	SANDY CLAY LOAM	50	27	23	105.4
14378448	49353	85-90	2.00	11.19	0.6	0.5	21.3	29.09	9.14	SANDY CLAY LOAM	58	19	23	100.5
14378449	49354	90-95	2.23	10.52	0.8	0.7	21.9	25.21	8.98	CLAY LOAM	38	33	29	101.6
14378450	49355	95-100	5.47	13.42	4.3	3.0	66.1	34.55	8.42	SANDY CLAY LOAM	60	19	21	47.2
14378451	49356	100-105	2.59	11.02	0.7	0.5	27.3	35.32	8.79	CLAY	8	21	71	138.1
14378452	49357	105-110	2.59	11.02	0.5	0.3	27.7	43.29	8.83	SILTY CLAY	10	41	49	125.8
14378453	49358	110-115	2.45	11.29	0.5	0.3	26.9	42.16	8.71	CLAY	18	35	47	121.3
14378454	49359	115-120	2.21	9.40	0.6	0.6	19.6	25.55	8.91	CLAY	12	39	49	161.5
14378455	49360	120-125	1.77	10.93	0.5	0.3	18.6	29.85	9.05	CLAY LOAM	26	41	33	126.5

<u>Ref#</u>	<u>Lab#</u>	<u>Depth</u>	<u>EC</u>	<u>Cat/EC</u>	<u>Ca</u>	<u>Mg</u>	<u>Na</u>	<u>SAR</u>	<u>pH</u>	<u>Texture</u>	<u>Sand</u>	<u>Silt</u>	<u>Clay</u>	<u>Sat. Percent</u>
14378456	49361	125-130	1.99	10.14	0.3	0.3	19.5	34.98	8.97	CLAY	14	31	55	133.0
14378457	49362	130-135	2.19	11.48	0.5	0.3	24.4	40.02	8.80	CLAY	18	39	43	114.1
14378458	49363	135-140	2.19	11.05	0.6	0.5	23.0	30.23	8.70	SILTY CLAY	10	43	47	123.9
14378459	49364	140-145	2.38	11.44	0.5	0.4	26.3	39.03	8.92	SILTY CLAY LOAM	18	45	37	119.0
14378460	49365	145-148.9	2.75	10.20	0.6	0.4	27.1	40.10	8.83	SILTY CLAY	8	41	51	109.0
14378461	49366	159-164	1.45	11.63	0.9	0.4	15.6	19.17	9.11	LOAM	34	39	27	62.0



604 Highway 15 West  
 P.O. Box 510  
 Northwood, ND 58267  
 (701) 587-6010  
 FAX (701) 587-6013

email: agvise@polarcomm.com  
 Homepage: www.agvise.com

Coyote Creek  
 204 County Rd 15  
 Beulah, ND 58523

Date Sampled: 08/13/12  
 Date Received: 08/07/12  
 Date Reported: 01/24/13

Site: CC12091C

<u>Ref#</u>	<u>Lab#</u>	<u>Depth</u>	<u>EC</u>	<u>Cat/EC</u>	<u>Ca</u>	<u>Mg</u>	<u>Na</u>	<u>SAR</u>	<u>pH</u>	<u>Texture</u>	<u>Sand</u>	<u>Silt</u>	<u>Clay</u>	<u>Sat. Percent</u>
14378351	49501	0-5	2.58	12.14	1.6	5.7	24.0	12.55	8.4	CLAY LOAM	44	23	33	64.6
14378352	49502	5-10	8.20	17.29	24.7	47.1	70.1	11.70	8.1	CLAY LOAM	35	26	39	84.4
14378353	49503	10-15	5.15	13.89	9.6	15.6	46.4	13.09	8.1	CLAY	30	29	41	79.8
14378354	49504	15-20	2.70	11.93	3.2	3.4	25.6	14.01	8.2	CLAY	28	29	43	88.6
14378355	49505	20-25	3.53	12.04	6.4	6.1	30.0	12.01	8.1	CLAY	20	29	51	86.1
14378356	49506	25-30	2.37	10.47	2.8	2.8	19.2	11.51	8.2	CLAY	8	31	61	113.9
14378357	49507	30-35	2.46	10.05	1.9	1.6	21.3	16.21	8.5	CLAY	8	35	57	114.2
14378358	49508	35-40	2.35	10.26	1.3	1.0	21.8	20.40	8.4	CLAY	6	35	59	105.0
14378359	49509	40-45	2.32	9.94	0.7	0.6	21.8	27.35	8.3	CLAY	4	11	85	129.2
14378360	49510	45-50	2.81	11.00	1.2	1.0	28.8	27.89	7.6	CLAY	8	33	59	83.4
14378361	49511	50-55	2.55	10.08	0.6	0.4	24.8	36.47	8.4	CLAY	2	17	81	105.8
14378362	49512	55-60	2.34	10.38	0.4	0.3	23.6	39.91	8.5	CLAY	0	19	81	113.5
14378363	49513	60-65	2.27	10.07	0.4	0.2	22.3	41.42	8.8	SILTY CLAY	8	41	51	133.0
14378364	49514	65-70	2.82	10.48	0.6	0.4	28.5	40.43	8.7	LOAM	42	33	25	68.8
14378365	49515	70-75	2.70	11.27	0.5	0.4	29.6	44.54	8.4	CLAY	4	33	63	110.5
14378366	49516	75-80	2.04	10.68	0.3	0.3	21.3	41.14	8.7	SILTY CLAY	14	41	45	121.1
14378367	49517	80-85	1.88	11.44	0.6	0.5	20.4	27.39	8.5	CLAY	6	35	59	111.8
14378368	49518	85-90	1.74	11.23	0.5	0.3	18.7	29.39	8.4	SILTY CLAY	10	47	43	108.8
14378369	49519	90-95	1.87	9.55	0.6	0.5	16.7	22.19	8.6	SILTY CLAY	6	47	47	115.2
14378370	49520	95-100	1.97	9.65	0.7	0.4	17.9	24.62	8.5	SILTY CLAY	10	47	43	122.5
14378371	49521	100-105	1.46	11.20	0.4	0.4	15.6	24.53	8.8	SILTY CLAY LOAM	14	49	37	130.1
14378372	49522	105-110	1.85	10.26	0.2	0.2	18.6	43.22	8.9	CLAY	11	34	55	123.6
14378373	49523	110-115	1.88	10.49	0.3	0.2	19.3	41.15	8.9	CLAY	8	37	55	141.3
14378374	49524	115-120	2.27	9.06	0.2	0.2	20.2	44.20	8.9	CLAY	10	29	61	144.7
14378375	49525	120-125	2.17	11.60	0.3	0.2	24.6	47.45	8.6	SILTY CLAY	8	47	45	128.6

<u>Ref#</u>	<u>Lab#</u>	<u>Depth</u>	<u>EC</u>	<u>Cat/EC</u>	<u>Ca</u>	<u>Mg</u>	<u>Na</u>	<u>SAR</u>	<u>pH</u>	<u>Texture</u>	<u>Sand</u>	<u>Silt</u>	<u>Clay</u>	<u>Sat. Percent</u>
14378376	49526	125-130	1.48	11.15	0.3	0.2	16.0	31.32	8.8	SILTY CLAY	8	47	45	138.1
14378377	49527	130-135	1.78	10.55	0.4	0.4	18.1	29.92	8.6	CLAY	4	35	61	122.3
14378378	49528	135-136.2	2.34	12.25	0.9	0.6	27.2	31.56	7.6	CLAY	34	19	47	93.2
14378379	49529	147.95-152.95	1.85	10.03	0.5	0.4	17.6	25.85	7.5	CLAY	14	17	69	122.4



604 Highway 15 West  
 P.O. Box 510  
 Northwood, ND 58267

(701) 587-6010  
 FAX (701) 587-6013

email: agvise@polarcomm.com  
 Homepage: www.agvise.com

Coyote Creek  
 204 County Rd 15  
 Beulah, ND 58523

Date Sampled: 08/13/12  
 Date Received: 08/07/12  
 Date Reported: 01/21/13

Site: CC12086C

<u>Ref#</u>	<u>Lab#</u>	<u>Depth</u>	<u>EC</u>	<u>Cat/EC</u>	<u>Ca</u>	<u>Mg</u>	<u>Na</u>	<u>SAR</u>	<u>pH</u>	<u>Texture</u>	<u>Sand</u>	<u>Silt</u>	<u>Clay</u>	<u>Sat. Percent</u>
14378111	49367	0-5	1.00	10.65	2.2	2.9	5.5	3.44	7.80	CLAY LOAM	44	23	33	48.3
14378112	49368	5-10	5.10	18.07	23.8	35.1	33.3	6.13	7.90	CLAY LOAM	41	24	35	62.2
14378113	49369	10-15	5.43	14.39	16.7	24.2	37.3	8.26	7.90	CLAY LOAM	37	24	39	68.0
14378114	49370	15-20	3.44	12.11	7.1	9.0	25.5	8.99	7.90	CLAY	16	17	67	99.3
14378115	49371	20-25	4.36	12.59	8.1	13.2	33.6	10.29	7.30	CLAY	24	31	45	75.2
14378116	49372	25-30	7.40	15.34	23.5	33.8	56.3	10.51	6.80	CLAY	16	35	49	80.0
14378117	49373	30-35	3.88	10.87	2.3	5.0	34.9	18.26	8.20	CLAY	18	39	43	108.8
14378118	49374	35-40	4.05	10.67	1.8	3.5	37.9	23.33	8.57	SILTY CLAY LOAM	14	47	39	101.0
14378119	49375	40-45	2.91	11.27	1.2	1.8	29.8	24.17	8.40	CLAY LOAM	23	44	33	102.0
14378120	49376	45-50	3.26	10.51	1.7	2.2	30.4	21.77	8.40	LOAM	35	38	27	81.4
14378121	49377	50-55	1.57	10.25	0.4	0.4	15.2	22.98	8.70	CLAY LOAM	27	44	29	112.0
14378122	49378	55-60	1.78	10.50	0.6	0.4	17.7	24.48	9.00	CLAY	12	37	51	129.5
14378123	49379	60-65	2.11	9.37	0.4	0.4	19.0	31.64	8.86	CLAY LOAM	21	42	37	101.3
14378124	49380	65-70	2.12	10.51	0.5	0.4	21.4	32.49	8.40	SILTY CLAY LOAM	19	44	37	119.8
14378125	49381	70-75	1.74	8.93	0.3	0.2	15.1	33.16	8.80	CLAY	27	32	41	110.9
14378126	49382	75-80	0.96	10.61	0.2	0.2	9.7	19.84	9.40	CLAY LOAM	25	40	35	143.8
14378127	49383	80-85	1.18	10.16	0.3	0.2	11.5	24.17	9.11	CLAY LOAM	20	49	31	128.4
14378128	49384	85-90	1.20	10.54	0.3	0.2	12.2	24.80	8.80	SILTY CLAY LOAM	19	46	35	135.1
14378129	49385	90-95	1.27	10.73	0.3	0.2	13.1	26.79	8.80	SILTY CLAY LOAM	17	48	35	133.1
14378130	49386	95-100	1.30	9.19	0.1	0.1	11.7	33.18	9.31	CLAY LOAM	26	41	33	146.3
14378131	49387	100-105	1.38	10.99	0.3	0.3	14.6	26.73	9.05	SILTY CLAY LOAM	17	46	37	123.2
14378132	49388	105-110	1.48	9.21	0.3	0.2	13.1	25.98	8.70	SILTY CLAY	7	50	43	122.9
14378133	49389	110-115	1.43	11.07	0.4	0.3	15.2	26.09	8.72	CLAY	5	20	75	128.8
14378134	49390	115-119.15	1.87	11.08	0.5	0.4	19.9	30.06	7.89	CLAY	35	12	53	106.8
14378135	49391	129.3-134.3	3.68	11.84	1.0	0.8	41.7	43.11	8.50	CLAY	31	28	41	117.4



604 Highway 15 West  
P.O. Box 510  
Northwood, ND 58267

(701) 587-6010  
FAX (701) 587-6013

email: agvise@polarcomm.com  
Homepage: www.agvise.com

Coyote Creek  
204 County Rd 15  
Beulah, ND 58523

Date Sampled: 08/17/12  
Date Received: 08/26/12  
Date Reported: 01/29/13

Site: CC12104C

<u>Ref#</u>	<u>Lab#</u>	<u>Depth</u>	<u>EC</u>	<u>Cat/EC</u>	<u>Ca</u>	<u>Mg</u>	<u>Na</u>	<u>SAR</u>	<u>pH</u>	<u>Texture</u>	<u>Sand</u>	<u>Silt</u>	<u>Clay</u>	<u>Sat. Percent</u>
14380811	55285	0-5	4.19	10.68	3.8	8.3	32.7	13.30	7.61	SANDY LOAM	71	9	20	45.3
14380812	55286	5-10	9.67	17.94	23.8	56.7	93.0	14.66	8.10	CLAY	13	11	76	119.9
14380813	55287	10-15	5.27	12.70	4.0	11.5	51.4	18.44	8.18	CLAY	9	31	60	125.6
14380814	55288	15-20	2.45	9.62	1.0	2.3	20.3	15.85	8.24	CLAY	11	17	72	128.4
14380815	55289	20-25	1.82	10.21	0.8	1.2	16.6	16.67	8.52	CLAY	6	11	83	137.1
14380816	55292	25-30	2.29	10.82	0.9	0.8	23.1	25.21	8.45	CLAY	16	39	45	99.5
14380817	55293	30-35	1.84	9.88	0.5	0.5	17.2	24.65	8.86	CLAY	18	37	45	145.2
14380818	55294	35-40	3.77	9.80	1.1	1.0	34.9	34.44	8.60	LOAM	38	41	21	55.4
14380819	55295	40-45	1.92	10.25	0.4	0.3	19.0	32.16	9.02	SILTY CLAY	10	45	45	152.1
14380820	55296	45-50	1.82	11.06	0.4	0.3	19.5	34.01	9.06	CLAY	14	35	51	166.7
14380821	55297	50-55	1.45	10.48	0.3	0.2	14.7	28.80	9.21	CLAY LOAM	21	39	40	212.5
14380822	55298	55-60	1.91	10.00	0.4	0.3	18.5	32.22	8.78	SILTY CLAY LOAM	19	49	32	135.0
14380823	55299	60-65	1.93	8.52	0.3	0.3	15.8	28.93	8.93	CLAY LOAM	25	39	36	135.5
14380824	55300	65-70	1.91	10.15	0.4	0.3	18.8	33.40	8.83	CLAY	27	23	50	121.4
14380825	55301	70-75	5.33	15.80	3.0	2.1	79.1	49.31	7.21	SANDY CLAY LOAM	50	15	35	92.3
14380826	55302	75-80	1.62	9.94	0.6	0.4	15.1	21.78	9.21	LOAM	44	29	27	129.1
14380827	55303	80-85	2.41	9.87	0.4	0.3	23.1	38.68	8.84	CLAY	14	35	51	117.5
14380828	55304	85-90	3.55	11.42	0.8	0.6	39.2	47.48	8.11	CLAY	16	27	57	106.5
14380829	55305	90-95	2.71	9.19	0.4	0.3	24.2	42.14	8.88	CLAY	16	25	59	111.8
14380830	55306	95-100	2.36	9.03	0.2	0.2	20.9	47.55	8.81	CLAY LOAM	21	39	40	124.1
14380831	55307	100-105	1.46	10.62	0.4	0.6	14.6	21.04	8.72	CLAY LOAM	21	43	36	149.3
14380832	55308	105-110	1.50	10.77	0.3	0.3	15.6	28.38	8.90	CLAY LOAM	23	43	34	147.6
14380833	55309	110-113.95	2.55	10.04	0.5	0.4	24.8	38.88	8.08	CLAY	19	27	54	124.1
14380834	55310	124-129	2.65	7.86	0.4	0.3	20.0	32.08	7.92	CLAY	15	15	70	150.9



604 Highway 15 West  
P.O. Box 510  
Northwood, ND 58267

(701) 587-6010  
FAX (701) 587-6013

email: agvise@polarcomm.com  
Homepage: www.agvise.com

Coyote Creek  
204 County Rd 15  
Beulah, ND 58523

Date Sampled: 08/17/12  
Date Received: 08/26/12  
Date Reported: 01/30/13

Site: CC12102C

<u>Ref#</u>	<u>Lab#</u>	<u>Depth</u>	<u>EC</u>	<u>Cat/EC</u>	<u>Ca</u>	<u>Mg</u>	<u>Na</u>	<u>SAR</u>	<u>pH</u>	<u>Texture</u>	<u>Sand</u>	<u>Silt</u>	<u>Clay</u>	<u>Sat. Percent</u>
14384101	55238	0-5	4.21	9.77	6.1	6.0	29.1	11.85	8.10	CLAY	29	29	42	80.3
14384102	55240	5-10	5.54	14.86	10.3	9.8	62.3	19.67	8.22	CLAY LOAM	33	31	36	106.3
14384103	55241	10-15	2.00	9.54	0.4	0.4	18.2	28.30	8.94	SILTY CLAY	13	41	46	181.9
14384104	55242	15-20	2.55	10.48	0.9	0.7	25.1	27.77	8.48	CLAY	11	11	78	135.1
14384105	55243	20-25	4.81	9.52	1.5	1.3	43.0	36.45	7.11	CLAY	32	13	55	126.1
14384106	55245	25-30	1.77	10.97	0.2	0.2	19.0	43.27	8.90	CLAY LOAM	40	27	33	123.4
14384107	55246	30-35	2.27	11.41	0.3	0.3	25.3	46.78	8.32	CLAY	12	25	63	123.2
14384108	55248	35-40	1.77	10.80	0.2	0.1	18.8	44.47	9.04	CLAY	20	35	45	123.6
14384109	55249	40-45	1.86	11.02	0.2	0.2	20.1	46.79	9.11	CLAY LOAM	20	47	33	129.7
14384110	55252	45-50	2.73	10.42	0.4	0.3	27.8	48.28	8.22	CLAY	16	37	47	116.6
14384111	55253	50-55	1.86	11.45	0.3	0.2	20.8	42.73	8.88	CLAY LOAM	20	41	39	142.5
14384112	55256	55-60	2.12	9.95	0.2	0.2	20.6	43.35	8.79	SILTY CLAY	14	41	45	126.8
14384113	55257	60-65	2.13	11.24	0.3	0.3	23.3	42.38	8.62	CLAY	12	29	59	119.9
14384114	55261	65-68.9	2.08	12.32	0.4	0.3	24.9	41.25	7.89	CLAY	16	15	69	118.2
14384115	55262	79.1-84.1	2.17	11.68	0.3	0.3	24.7	44.24	8.41	SILTY CLAY	14	43	43	132.5



604 Highway 15 West  
P.O. Box 510  
Northwood, ND 58267

(701) 587-6010  
FAX (701) 587-6013

email: agvise@polarcomm.com  
Homepage: www.agvise.com

Coyote Creek  
204 County Rd 15  
Beulah, ND 58523

Date Sampled: 08/16/12  
Date Received: 08/20/13 & 08/27/13  
Date Reported: 02/05/13

Site: CC12100C

Ref#	Lab#	Depth	EC	Cat/EC	Ca	Mg	Na	SAR	pH	Texture	Sand	Silt	Clay	Sat. Percent
14378171	49556	0-5	2.01	12.46	5.4	8.8	10.9	4.12	7.87	SANDY CLAY LOAM	53	21	26	46.2
14378172	49557	5-10	4.88	14.99	21.3	33.1	18.7	3.58	7.78	SANDY CLAY LOAM	55	23	22	55.2
14378173	49558	10-15	6.44	17.63	25.3	59.8	28.4	4.36	7.66	LOAM	33	41	26	65.1
14378174	49559	15-20	6.39	17.73	25.0	60.8	27.5	4.21	7.45	LOAM	47	29	24	58.5
14378175	49560	20-25	5.44	15.39	21.7	45.6	16.4	2.84	7.51	LOAM	33	41	26	66.6
14378176	49561	25-30	5.45	15.54	24.5	44.9	15.3	2.60	6.50	CLAY	20	39	41	67.8
14378177	49562	30-35	5.30	17.41	23.5	46.1	22.7	3.85	4.10	CLAY LOAM	42	27	31	79.6
14378178	49563	35-40	4.13	13.4	15.1	15.7	24.5	6.25	6.60	CLAY	22	25	53	86.8
14378179	49564	40-45	3.36	11.68	8.3	6.0	24.9	9.30	7.70	CLAY	16	29	55	93.7
14378180	49565	45-50	4.88	13.26	17.9	14.0	32.9	8.25	7.40	CLAY	24	29	47	83.9
14378181	49566	50-55	3.13	9.50	1.7	1.0	26.9	22.85	8.30	CLAY	20	27	53	102.5
14378182	49567	55-60	2.55	10.29	0.8	0.5	25.0	31.36	8.41	CLAY	11	13	76	144.9
14378183	49568	60-65	3.18	11.08	0.9	0.8	33.5	35.70	7.91	CLAY	11	25	64	95.5
14378184	49569	65-70	2.75	10.92	0.6	0.5	28.9	38.96	8.37	CLAY	3	21	76	109.2
14378185	49570	70-75	2.87	9.75	0.5	0.4	27.1	40.75	8.43	CLAY	5	17	78	127.9
14378186	49571	75-80	2.73	10.71	0.6	0.4	28.3	40.25	8.32	CLAY LOAM	23	38	39	114.1
14378187	49572	80-85	1.64	9.89	0.4	0.3	15.5	26.03	9.04	SILTY CLAY	11	44	45	172.9
14378188	49573	85-90	1.91	9.74	0.3	0.2	18.1	34.48	8.98	CLAY	19	34	47	153.8
14380791	55311	90-95	1.45	10.52	0.2	0.2	14.8	31.77	9.03	CLAY	9	25	66	225.1
14380792	55321	95-100	2.30	8.11	0.4	0.5	17.8	26.71	8.65	CLAY	7	17	76	145.8
14380793	55322	100-105	2.21	11.13	0.3	0.2	24.1	47.89	8.49	CLAY	9	11	80	173.0
14380794	55323	105-107.2	2.45	10.84	0.5	0.5	25.6	37.15	8.05	CLAY	17	29	54	137.0
14380795	55327	109-115	1.57	10.39	0.4	0.2	15.7	28.24	8.71	CLAY	15	31	54	144.6
14380796	55329	115-120	2.55	11.35	0.4	0.3	28.2	46.60	8.23	CLAY	19	23	58	126.9
14380797	55330	120-125	3.25	8.67	0.5	0.4	27.3	40.00	8.57	CLAY	22	33	45	116.0

Agricultural Testing

Voigt-017

<u>Ref#</u>	<u>Lab#</u>	<u>Depth</u>	<u>EC</u>	<u>Cat/EC</u>	<u>Ca</u>	<u>Mg</u>	<u>Na</u>	<u>SAR</u>	<u>pH</u>	<u>Texture</u>	<u>Sand</u>	<u>Silt</u>	<u>Clay</u>	<u>Sat. Percent</u>
14380798	55331	125-130	2.33	10.22	0.4	0.3	23.1	37.94	8.82	CLAY	14	29	57	122.4
14380799	55332	130-135	2.52	10.21	0.3	0.2	25.2	48.62	8.36	CLAY	21	33	46	125.0
14380800	55333	135-140	2.97	10.82	0.7	0.6	30.9	39.46	8.23	CLAY	17	39	44	133.3
14380801	55334	140-145	1.48	11.37	0.3	0.3	16.1	27.42	8.73	SILTY CLAY	9	45	46	148.7
14380802	55335	145-151	2.48	10.50	0.3	0.3	25.5	48.45	8.59	CLAY	9	29	62	133.6
14380803	55336	162.95-167.95	1.50	10.72	0.5	0.3	15.3	24.34	8.04	SILTY CLAY	15	43	42	98.9



604 Highway 15 West  
 P.O. Box 510  
 Northwood, ND 58267

(701) 587-6010  
 FAX (701) 587-6013

email: agvise@polarcomm.com  
 Homepage: www.agvise.com

Coyote Creek  
 204 County Rd 15  
 Beulah, ND 58523

Date Sampled: 08/17/12  
 Date Received: 08/27/13  
 Date Reported: 02/01/13

Site: CC12103C

<u>Ref#</u>	<u>Lab#</u>	<u>Depth</u>	<u>EC</u>	<u>Cat/EC</u>	<u>Ca</u>	<u>Mg</u>	<u>Na</u>	<u>SAR</u>	<u>pH</u>	<u>Texture</u>	<u>Sand</u>	<u>Silt</u>	<u>Clay</u>	<u>Sat. Percent</u>
14378251	55656	0-5	2.40	9.70	4.5	4.5	14.2	6.70	7.92	CLAY	24	33	43	72.7
14378252	55657	5-10	6.15	17.65	12.4	18.3	77.9	19.88	8.21	CLAY	24	25	51	94.1
14378253	55658	10-15	2.50	9.84	0.8	1.0	22.8	23.77	8.59	CLAY LOAM	20	45	35	132.8
14378254	55659	15-20	2.86	10.07	0.6	0.6	27.6	34.75	8.48	CLAY	0	17	83	135.2
14378255	55660	20-25	4.22	10.90	1.8	1.6	42.7	33.10	7.52	CLAY	18	35	47	100.6
14378256	55661	25-30	2.68	8.76	0.5	0.4	22.6	35.32	8.71	CLAY	20	39	41	110.3
14378257	55662	30-35	2.05	10.60	0.4	0.3	21.0	35.04	8.90	CLAY	6	39	55	117.8
14378258	55663	35-40	1.59	10.14	0.2	0.2	15.6	31.71	8.82	CLAY	20	31	49	130.7
14378259	55664	40-45	1.22	9.75	0.2	0.3	11.3	21.54	8.92	CLAY LOAM	26	39	35	165.3
14378260	55665	45-50	3.95	12.34	0.9	1.0	46.9	48.15	8.78	CLAY	10	37	53	147.1
14378261	55666	50-55	1.15	10.15	0.3	0.4	11.0	18.91	8.46	CLAY LOAM	30	41	29	145.2
14378262	55667	55-60	1.30	10.02	0.2	0.3	12.5	23.59	9.11	CLAY LOAM	24	43	33	144.3
14378263	55668	60-65	1.45	10.69	0.3	0.3	14.9	27.13	9.18	LOAM	38	35	27	130.3
14378264	55669	65-70	1.46	10.55	0.5	0.3	14.7	23.95	8.78	SILTY CLAY	12	47	41	143.4
14378265	55670	70-75	1.85	8.21	0.4	0.3	14.5	24.08	8.91	SILTY CLAY	12	45	43	149.6
14378266	55671	75-80	1.92	9.74	0.3	0.3	18.1	33.39	8.66	CLAY	4	15	81	149.4
14378267	55672	80-82.3	1.95	11.66	0.5	0.4	21.9	34.06	8.00	CLAY	22	17	61	135.2
14378268	55673	94.2-99.2	3.04	9.89	0.7	0.5	28.8	36.83	7.27	CLAY	14	13	73	139.8