



**ONE-CALL COMPLAINT**  
**PUBLIC SERVICE COMMISSION**  
 SFN 59067 (08/2022)



**INSTRUCTIONS:** To allege a violation of the One-Call Excavation Notice System (N.D.C.C. Chapter 49-23), complete this form in its entirety.

**SECTION I – COMPLAINANT (Individual/entity completing form)**

Company/Entity Name (if applicable) North Central Services Inc.			
Contact Person Mike Schuppert	Email Address schuppertmike@gmail.com	Telephone Number 218-368-6351	
Mailing Address 5487 Hart Lane Nw	City Bemidji	State MN	Zip Code 56621
Complainant is willing and able to testify on the complaint if matter proceeds to a formal hearing.		<input checked="" type="checkbox"/> YES	<input type="checkbox"/> NO

**SECTION II – RESPONDENT (Individual/entity who allegedly violated the One-Call law)**

Company/Entity Name (if applicable) Cass Rural Water Users District			
Contact Person Brent	Email Address cassruralwater.com	Telephone Number 701-428-3130	
Mailing Address 131 Maple Street	City Kindred	State ND	Zip Code 58051

**SECTION III – ALLEGED VIOLATION**

**OPERATOR – A person or entity who owns or operates an underground facility (i.e.: natural gas, electric, sewer, etc.).**

<input type="checkbox"/> Operator failed to mark or clear underground facility within locate period.	<input type="checkbox"/> Operator failed to mark underground facility within 24 inches horizontally.
--	--

**EXCAVATOR – A person or entity who conducts excavation (i.e.: homeowner, property owner, company, etc.).**

<input type="checkbox"/> Excavation started prior to underground facility locate.	<input type="checkbox"/> Excavator failed to provide locate notice prior to beginning excavation.
<input type="checkbox"/> Excavator failed to conduct the excavation in a careful and prudent manner.	<input type="checkbox"/> Excavator failed to renew locate request prior to expiration of the 21-day period.

**OTHER – May be issue/concern with One-Call Center or other alleged violation that is not listed under operator or excavator.**

Write Issue/Concern: Operator cannot accurately locate there own existing water plant

**SECTION IV – DESCRIPTION/DAMAGE**

Date and Time of Event 6/5/24 3 p.m.	Location (Address, City, State / Nearest Intersecting Streets / Lat & Long)	One-Call Ticket Number
Underground Facility Affected <input type="checkbox"/> Electric <input type="checkbox"/> Gas <input type="checkbox"/> Cable <input type="checkbox"/> Communications <input checked="" type="checkbox"/> Water <input type="checkbox"/> Sewer/Storm Water <input type="checkbox"/> Petroleum <input type="checkbox"/> Other _____		
Material & Size of Underground Facility (Poly, Steel, Coated Pipe / Fiberoptic / 2 KW / 1.5 in, 2 in / etc.) 2"	Operator(s) Affected Cass Rural Water	
Estimated Value of Damage 13,248.69	Injuries (List Number, If Any) Fatalities _____ Injuries _____ Hospitalizations _____	Number of Customers Affected 2
Description of the alleged violation/concern. If more space is required, attach additional page(s). Bryan and Donnie from NCS met with Lucas from Cass Rural water and Lucas informed them that the prints stated the line was 15ft. east from the centerline of 140th st. SE. NCS was able to move their running line out to 55ft. from centerline to ensure a safe distance from waterline while paralleling them. In the process of doing so the line was hit and was approximately 40ft. from where Cass Rural water thought it was.		

**SECTION V – SIGNATURE OF COMPLAINANT**

Signature Michael Schuppert	Printed Name Michael Schuppert	Date 7-8-2024
--------------------------------	-----------------------------------	------------------

Please email the completed form to [ndpsc@nd.gov](mailto:ndpsc@nd.gov), fax to 701-328-2410, or mail to: Public Service Commission  
 600 E. Boulevard Ave. Dept 408  
 Bismarck, ND 58505-0480



# NORTH CENTRAL SERVICE INC

PO BOX 310  
BEMIDJI, MN 56601  
PHONE: 218-444-3855

## DAMAGE REPORT

Date: 6-5-24

Locate #: 24046273 Locate Called in By (Employee Name): Donnie Lyle

Address Where Damage Occurred: Just north of 3848 140th Ave SE

City and State: Buffalo ND

Company Name of Damaged Utility: Cass County Rural Water

Type of Utility Damaged (phone, electric, water, etc.): waterline

Check A, B, or C:

A. Located  B. Off Locate  By How Much?  FT  INCHES C. Not Located

Machine Operator: Thomas Norgeson

Foreman: Randy Halverson

Comments: Bryan and Donnie met with Lucas with Cass Rural water and informed us that the waterline was shown on their prints to be 15 feet East from the center line of 140th st SE so we moved out to 55' from center line to ensure a good distance between us to parallel them going north but the water line was old locate and was hit on locate flags on the line that was hit

### Sketch of Job Where Accident Occurred:

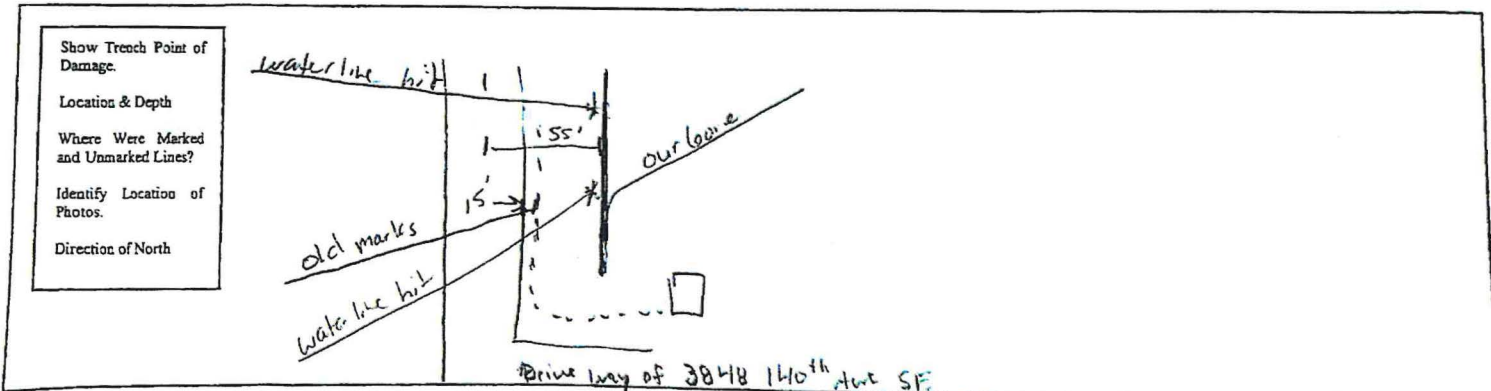



# NORTH CENTRAL SERVICE INC

PO BOX 310  
BEMIDJI, MN 56601  
PHONE: 218-444-3855

## DAMAGE REPORT

Date: 5-28-21

Locate #: 24046296/24046296 Locate Called in By (Employee Name): Donnie Loyle

Address Where Damage Occurred: Corner of 39th St SE + 143 Ave SE

City and State: Emden ND

Company Name of Damaged Utility: Cass County Rural water

Type of Utility Damaged (phone, electric, water, etc.): water

Check A, B, or C:

A. Located  B. Off Locate  By How Much? 38 FT INCHES C. Not Located

Machine Operator: Thomas Morgard

Foreman: Randy Halverson

Comments: water line was hit while boring across 39th St SE  
the locate flags were 38' feet off of locate Cass Rural water manual  
flags closer to the hit as they were digging to find hit line  
that they were unsure of location.

### Sketch of Job Where Accident Occurred:

