

October 29, 2024

Via Electronic Mail & Hand Delivery

Mr. Steve Kahl
North Dakota Public Service Commission
600 E. Boulevard, Dept. 408
Bismarck, ND 58505-0480
ndpsc@nd.gov

**In re: Applied Digital Corporation
Supplemental Information & Request for Informal Hearing
Case No. PU-24-359
Our File No. 012755-000005**

Dear Mr. Kahl:

I am writing on behalf of my client Applied Digital Corporation (“Applied Digital”). On October 23, 2024, Applied Digital filed an Expedited Request for Approval of Temporary Variance for Construction Activities Pursuant to N.D.C.C. § 49-22-25 (the “Variance”). *See* Case No. PU-24-359, Docket No. 1. This letter is intended to supplement and clarify various information provided in the Variance.

Applied Digital seeks Commission authorization to construct housing for diesel generators that will serve as onsite backup emergency generation for the Ellendale Data Center. After speaking with Commission staff, Applied Digital seeks to clarify the scope of the Variance. The Variance is specifically limited to constructing the generator housing within the area outlined in red and titled “Standby Emergency Generators” to the immediate right of Building 1 on the map marked as Exhibit D to the Variance. As a point of clarification, the red delineated area on the map will include four buildings to house the generators, each approximately 65’x 285’. The buildings or housing would not extend outside of the area previously marked in red. The Variance does not seek authorization regarding buildings for standby backup emergency generation associated with Buildings 2 and 3, which represent future development plans for the site. Attached hereto is an additional map that outlines the limited area in bolded red and titled “Stand-by Emergency Generator Scope” where Applied Digital seeks the Commission’s interim authorization.

As explained in the Variance, the underlying site is owned by Applied Digital. The backup emergency generator housing is located entirely on a previously disturbed area that was graded in

association with the construction of the Ellendale Data Center. As such, impacts from the construction of the backup generator housing is anticipated to be negligible. Applied Digital seeks Commission authorization related to construction of the housing to utilize the limited remaining 2024 construction window and to allow construction to resume as soon as possible in the Spring 2025. As committed to in the Variance, Applied Digital has retained a consultant to prepare a siting application and will file a complete siting application by August 2025. The backup generator housing will not be operational until a siting certificate is obtained from the Commission. To further clarify, the diesel generators will serve solely as onsite backup emergency generation in the unlikely event of a grid failure that would preclude the Ellendale Data Center from receiving electricity from its primary grid source. The generators will not be interconnected to the grid. Because of their standby nature, the backup generators will not be continuously operated in the same manner as more traditional electric energy conversion facilities.

Prior to the Commission rendering a decision on the Variance, Applied Digital respectfully requests the opportunity to appear before the Commission at an informal hearing to discuss the Variance in more detail and to provide the Commission with additional information.

Please feel free to contact me if you have any questions. Thank you.

Sincerely,

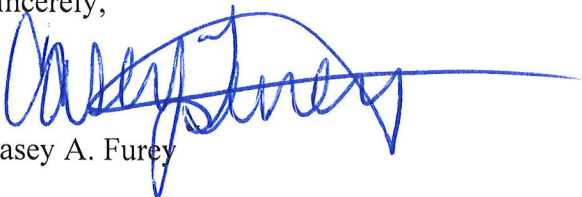

Casey A. Furey

CAF/lh

Enc.

- cc: Todd Gale (via email)
- Nick Phillips (via email)
- Logan Caldwell (via email)
- Victor Schock (via email)
- John Schuh (via email)

96TH STREET SE

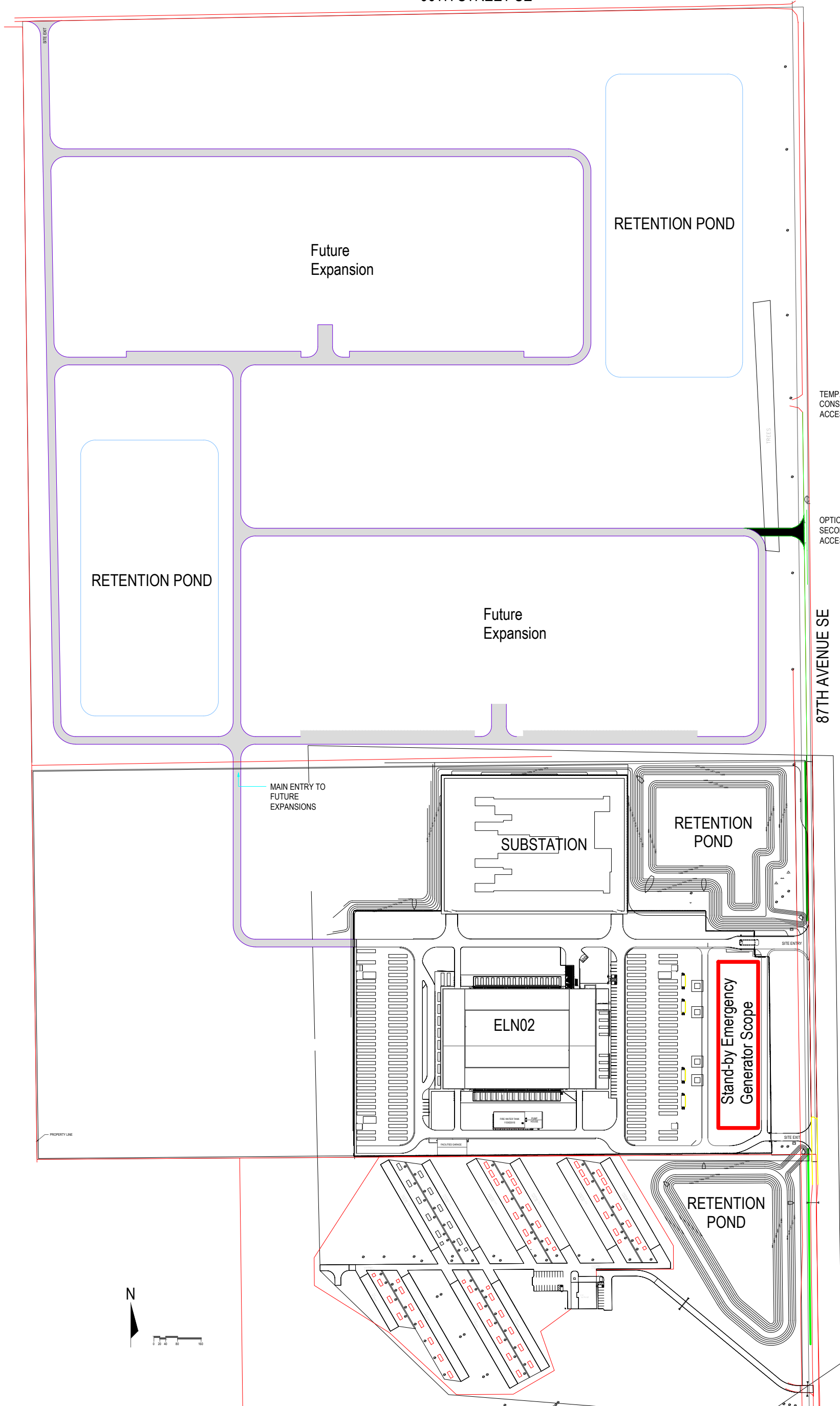

Future Expansion

RETENTION POND

RETENTION POND

Future Expansion

MAIN ENTRY TO FUTURE EXPANSIONS

SUBSTATION

RETENTION POND

ELN02

Stand-by Emergency Generator Scope

RETENTION POND

TEMP. CONSTRUCTION ACCESS (TBD)

OPTIONAL SECONDARY ACCESS (TBD)

87TH AVENUE SE

